

For mating dimensions
see MIL-DTL-38999 Series III

Reference MIL-STD-1560
for insert arrangement details.

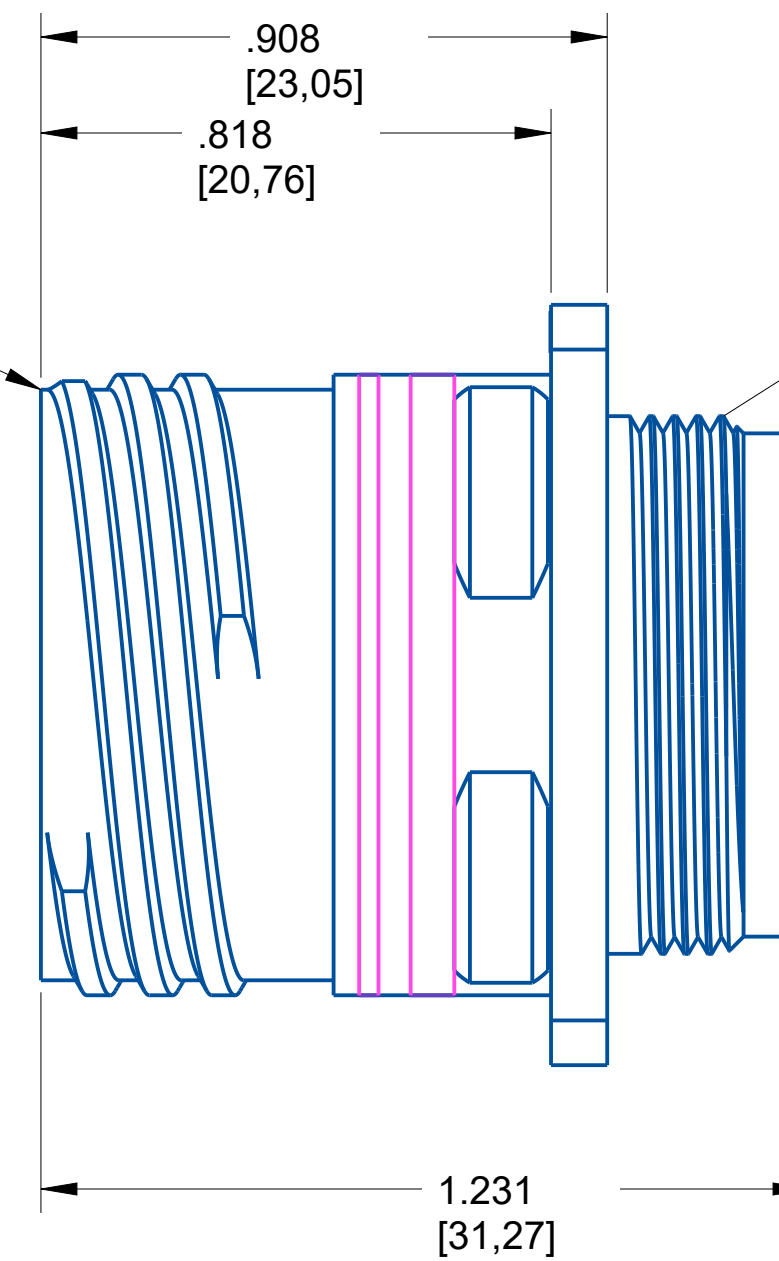

For rear shell features
and accessories see
MIL-DTL-38999 Series III

NOTE:

- DRAWING NOT TO SCALE
- DIMENSIONS SUBJECT TO CHANGE
- DIMENSIONS ARE IN INCHES [MM]

PROPERTY OF AMPHENOL AEROSPACE. ALL RIGHTS RESERVED.

Meets requirements
of MIL-DTL-38999
Base Material: Steel
Plating: Passivated

AMPHENOL CORPORATION

40-60 DELAWARE AVENUE
SIDNEY, N.Y. 13638

RECEPTACLE
Electrical Connector
D38999/20

U

SIZE	CAGE CODE	CODED NUMBER	REV
C	77820	D38999/20KD97SN	P1

SHEET 1 OF 1

Insert Arrangement

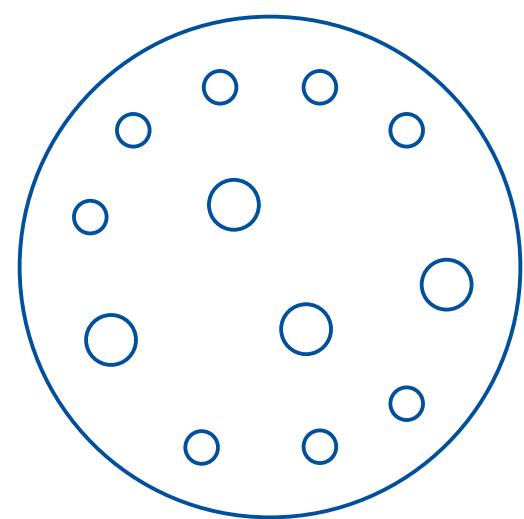

No. of Contacts	4	8
Contact Size	16	20
Wire Size	20, 18, 16	24, 22, 20

Shell Size	D
Arrangement	97
Service Rating	I
Test Current	(20)5 AMPS, (16)13 AMPS

NOTE:
-DRAWING NOT TO SCALE
-DIMENSIONS SUBJECT TO CHANGE
-DIMENSIONS ARE IN INCHES [MM]

PROPERTY OF AMPHENOL AEROSPACE. ALL RIGHTS RESERVED.

AMPHENOL CORPORATION
40-60 DELAWARE AVENUE
SIDNEY, N.Y. 13638

RECEPTACLE
Electrical Connector
D38999/20

SIZE
C

CAGE CODE
77820

CODED NUMBER
D38999/20KD97SN

REV
P1

U

SHEET 1 OF 1