

Features

- Cartridge cylinder with threaded rod
- Several usage possibility: with angular bracket or directly integrated into the machine
- Max operating pressure 8 bar
- Working temperature 0 °C ÷ +80 °C
- Threaded piston rod

RS PRO Pneumatic Piston Rod Cylinder

0360774



RS PRO is the own brand of RS. The RS PRO Seal of Approval is your assurance of professional quality, a guarantee that every part is rigorously tested, inspected, and audited against demanding standards. Making RS PRO the Smart Choice for our customers.

Product Description

- * Cartridge cylinders have extremely reduced dimensions
- * Thanks to the threaded body it can be installed in any part of the machine
- * The air sealing between threaded hole and cylinder is done through the usage of an o-ring.

General Specifications

Manufacturer Series	RS PRO CA
Action	Single acting

Mechanical Specifications

Stroke	See table below for more details
Bore	See table below for more details
Length	See table below for more details
Piston Rod Thread Gender	Male
Maximum Operating Pressure	8 bar
Working Pressure Range	2-7 bar
Working Temperature	0 °C ÷ +80 °C
Absolute Maximum Pressure	8 bar
Cushioning Type	Elastomer
Pneumatic Connection	See table below for more details
Diameter	See table below for more details
Port Connection	See table below for more details
Width	See table below for more details
Height	See table below for more details
Dimensions	See table below for more details

Approvals

Declarations	MFR Declaration of Conformity
--------------	-------------------------------

Products within this series

Stock No.	Bore (mm)	Stroke (mm)	Length (mm)	Height (mm)	Width (mm)	Diameter (mm)	Pneumatic Connect. (Port Connection)
0360774	6	10	34,5	10	10	6	M5
0360776	6	15	41,5	10	10	6	M5
0360777	10	10	38,5	15	15	10	M5
0360779	10	15	45,5	15	15	10	M5

Drawings / Dimensions / Internal Structure / Materials

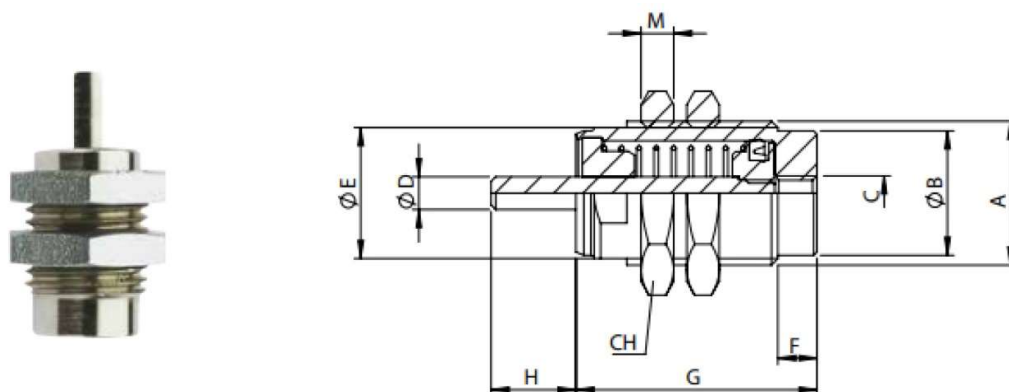

Stock No.	Ø	A	B	C	D	ØE	F	G (stroke)			H	M	CH	L
								5	10	15				
0360774	6	M10x1	8,5	M5	M3	9	5	19,5	26,5	33,5	8	3	14	7
0360776	6	M10x1	8,5	M5	M3	9	5	19,5	26,5	33,5	8	3	14	7
0360777	10	M15x1.5	13	M5	M3	14	5	21,5	28,0	35,0	10,5	4	19	10
0360779	10	M15x1.5	13	M5	M3	14	5	21,5	28,0	35,0	10,5	4	19	10