

IPD W 5F2,5 F M25 BK - Panel feed-through



1490378

<https://www.phoenixcontact.com/gb/products/1490378>

Please be informed that the data shown in this PDF document is generated from our online catalog. Please find the complete data in the user documentation. Our general terms of use for downloads are valid.



Panel feed-through, for connectors, product family: IPD, connection method: Push-in connection, number of positions: 4+FE, M25, Socket, 0.5 mm² ... 2.5 mm², 600 V, 17.5 A, PA, black, coding: F

Your advantages

- Easy distribution of power, as components are plugged directly
- Simple, time-saving wiring in the field with Push-Lock connection
- Reliable installation in harsh environments with IP66, IP68, and IP69K throughout the entire system
- Secure, tool-free locking even in particularly difficult installation situations
- Fast commissioning with preassembled cable assemblies

Commercial data

Item number	1490378
Packing unit	1 pc
Minimum order quantity	1 pc
Sales key	AF6LAA
Product key	AF6LAA
GTIN	4063151936099
Weight per piece (including packing)	39.8 g
Weight per piece (excluding packing)	22.22 g
Customs tariff number	85366990
Country of origin	CN

IPD W 5F2,5 F M25 BK - Panel feed-through

1490378

<https://www.phoenixcontact.com/gb/products/1490378>

Technical data

Notes

General	NOTE: Observe the permissible bending radii when routing cables, since the degree of protection may be at risk if the bending forces are too high. Reduce mechanical loads upstream of the connector, e.g., by using cable ties.
---------	---

Product properties

Product type	Panel feed-through
Product family	IPD
Number of positions	5
Connection profile	4+FE
Position marking	1, 2, 3, 4, FE
Number of connections per position	1
Type	for connectors
Coding	F

Insulation characteristics

Overvoltage category	III
Degree of pollution	3

Connection data

Connection technology

Connection method On the device side	Push-in connection
Frequency of connections between conductors of the same cross section	max. 10

Conductor connection

Conductor cross section flexibel	0.5 mm ² ... 2.5 mm ²
Conductor cross section solid	0.5 mm ² ... 2.5 mm ²
Conductor cross section with ferrule	0.5 mm ² ... 2.5 mm ²
Connection cross section AWG	20 ... 14

Dimensions

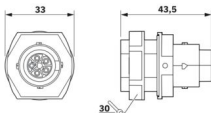
Dimensional drawing	
Width	33 mm
Height	33 mm
Length	43.4 mm

Electrical properties

IPD W 5F2,5 F M25 BK - Panel feed-through



1490378

<https://www.phoenixcontact.com/gb/products/1490378>

Rated surge voltage (III/3)	6 kV
Rated current	17.5 A
Rated voltage (III/3)	600 V
Nominal voltage U_N	600 V AC
	600 V DC
Nominal current I_N	17.5 A

Mechanical properties

Mechanical data

Insertion/withdrawal cycles	50 (IP66/IP68/IP69K)
	100 (IP66)

Material specifications

Color (Housing)	black (RAL 9005)
Material	PA
Material Seal	EPDM
Flammability rating according to UL 94	V0
Contact material	Cu
Contact surface material	Ni/Ag/Sn

Cable/line

Position marking	1, 2, 3, 4, FE
------------------	----------------

Mounting

Mounting type	M25
---------------	-----

Environmental and real-life conditions

Ambient conditions

Degree of protection	IP66
	IP68 (2 m / 24 h)
	IP69K
	Touch-proof when not plugged in (IP2X)
Impact strength	IK07
Ambient temperature (operation)	-30 °C ... 100 °C
Temperature when conductor connected	-5 °C ... 50 °C
Ambient temperature (storage/transport)	-30 °C ... 100 °C
Resistance to UV radiation	yes

IPD W 5F2,5 F M25 BK - Panel feed-through

1490378

<https://www.phoenixcontact.com/gb/products/1490378>

Drawings

Dimensional drawing

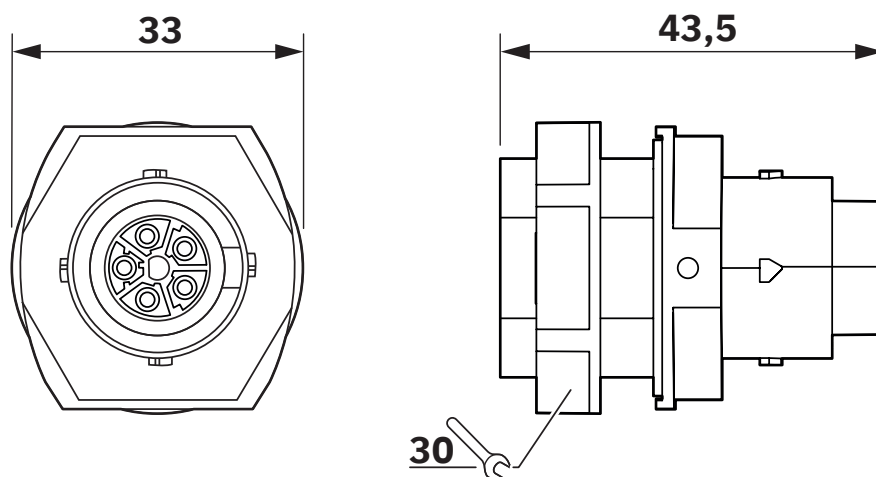

Diagram

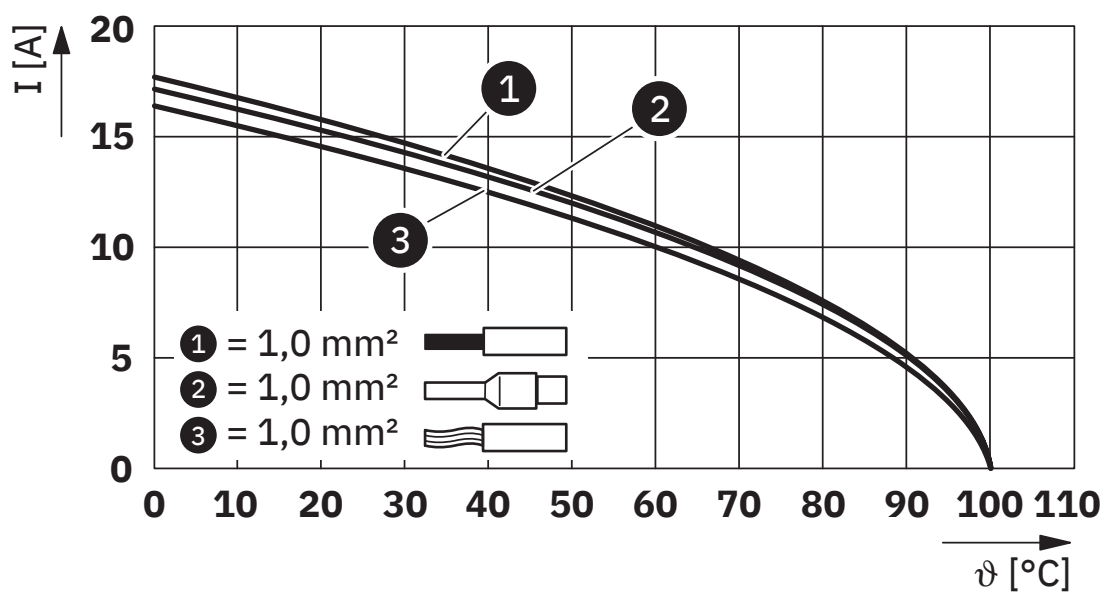

Derating diagram for 1.0 mm²

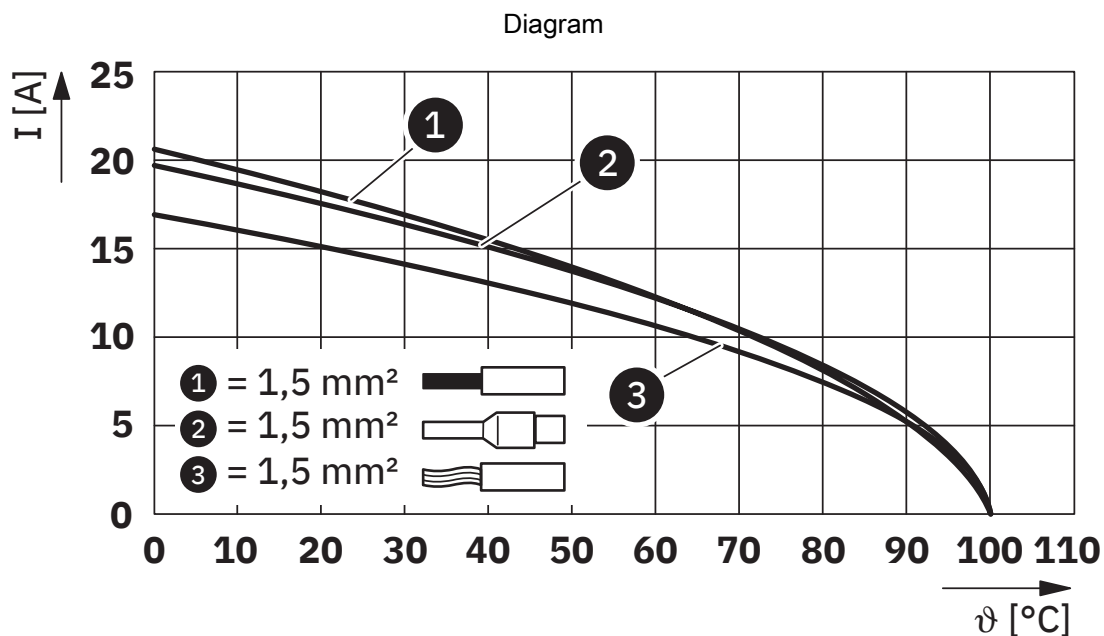

Derating diagram for 1.5 mm²

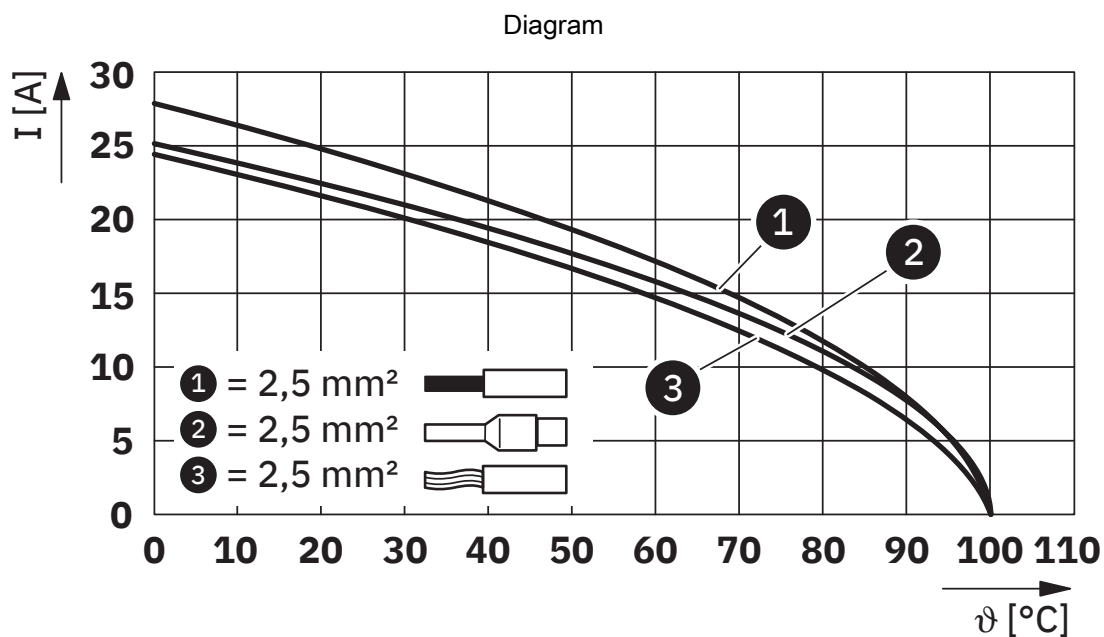

Derating diagram for 2.5 mm²

IPD W 5F2,5 F M25 BK - Panel feed-through

1490378

<https://www.phoenixcontact.com/gb/products/1490378>



Approvals

To download certificates, visit the product detail page: <https://www.phoenixcontact.com/gb/products/1490378>

**VDE Zeichengenehmigung**
Approval ID: 40059408

	cULus Listed Approval ID: E468743			
	Nominal voltage U_N	Nominal current I_N	Cross section AWG	Cross section mm^2
Only rigid conductors	600 V	20 A	- 14	-
multi-stranded with ferrule	600 V	20 A	- 14	-

IPD W 5F2,5 F M25 BK - Panel feed-through



1490378

<https://www.phoenixcontact.com/gb/products/1490378>

Classifications

ECLASS

ECLASS-13.0	27440602
-------------	----------

ETIM

ETIM 9.0	EC002566
----------	----------

IPD W 5F2,5 F M25 BK - Panel feed-through



1490378

<https://www.phoenixcontact.com/gb/products/1490378>

Environmental product compliance

EU RoHS

Fulfills EU RoHS substance requirements	Yes, No exemptions
---	--------------------

China RoHS

Environment friendly use period (EFUP)	EFUP-E
	No hazardous substances above the limits

EU REACH SVHC

REACH candidate substance (CAS No.)	No substance above 0.1 wt%
-------------------------------------	----------------------------

Phoenix Contact 2025 © - all rights reserved

<https://www.phoenixcontact.com>

PHOENIX CONTACT Ltd
Halesfield 13, Telford
Shropshire, TF7 4PG
01952 681700
info@phoenixcontact.co.uk