

HC-STA-D07-BWSCM-M32-EL-AL - Housing



1672263

<https://www.phoenixcontact.com/in/products/1672263>

Please be informed that the data shown in this PDF document is generated from our online catalog. Please find the complete data in the user documentation. Our general terms of use for downloads are valid.



Screw-in housing D7, with single locking latch, material: Die-cast aluminum, salt water resistant, protective cover material: PA, height: 32.5 mm, protective cover: yes, seal: yes, Standard, for pin inserts

Commercial data

Item number	1672263
Packing unit	1 pc
Minimum order quantity	1 pc
Product key	AF7APF
GTIN	4067923220492
Weight per piece (including packing)	41.2 g
Weight per piece (excluding packing)	222 g
Country of origin	CN

HC-STA-D07-BWSCM-M32-EL-AL - Housing



1672263

<https://www.phoenixcontact.com/in/products/1672263>

Technical data

Notes

General	for contact inserts HC-A03, A04, D07, D08, Q02, Q03, Q04, Q05, Q07, Q12
---------	---

Product properties

Product type	Housing with locking latch
Housing type	Screw-in housing
Application	Standard
Type	D7
Seal present	yes
Protective cover	yes
Shielded	no

Dimensions

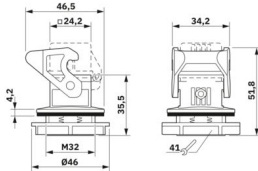
Dimensional drawing	
Height	32.5 mm
Thread pitch	1.5 mm

Material specifications

Flammability rating according to UL 94	V0 (Interlock) V0 (Protective cover)
Seal material	NBR
Housing material	Die-cast aluminum, salt water resistant
Housing surface material	uncoated
Material, protective cover	PA
Locking latch material	PA

Mechanical properties

Mechanical data

Locking type	Latch
--------------	-------

Connection data

Tightening torque	7.5 Nm ... 10 Nm
-------------------	------------------

Mounting

Assembly note	For mounting pin inserts To ensure anti-rotation protection of the housing, use the
---------------	--

HC-STA-D07-BWSCM-M32-EL-AL - Housing



1672263

<https://www.phoenixcontact.com/in/products/1672263>

	attached mounting cutout. Alternatively, you can use a consistently round panel cutout. However, this cutout cannot guarantee anti-rotation protection.
--	---

Environmental and real-life conditions

Ambient conditions	
Degree of protection	IP66 (with locked protective cover)
	IP67 (when plugged in)
Impact strength	IK06
Ambient temperature (operation)	-40 °C ... 125 °C

Drawings

Dimensional drawing

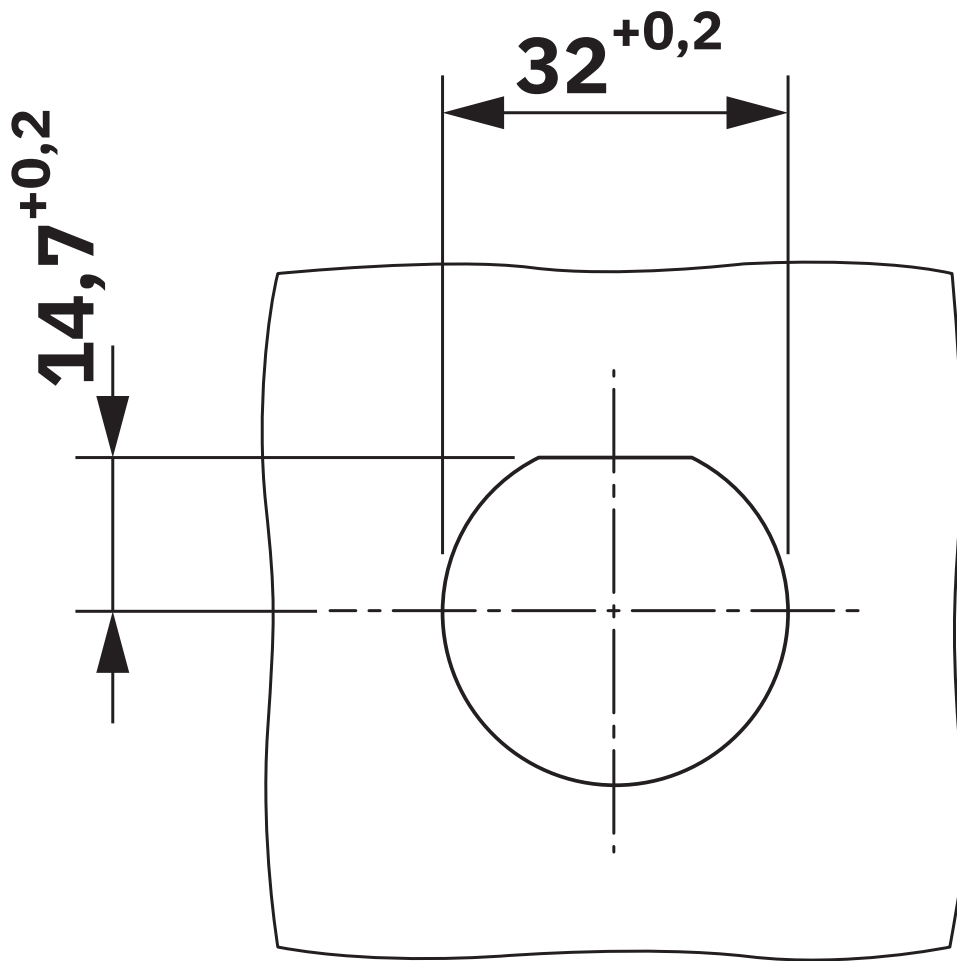

Panel cutout

Dimensional drawing

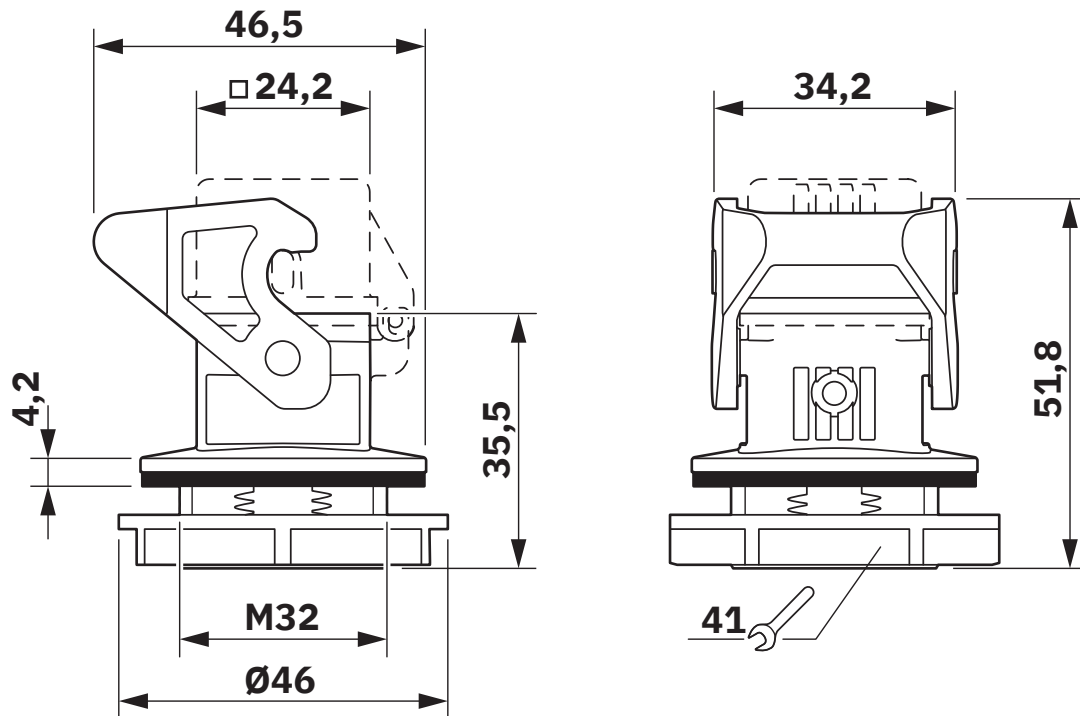

Dimensional drawing

HC-STA-D07-BWSCM-M32-EL-AL - Housing

1672263

<https://www.phoenixcontact.com/in/products/1672263>



Classifications

ECLASS

ECLASS-11.0	27440202
ECLASS-13.0	27440202

ETIM

ETIM 9.0	EC000437
----------	----------

Environmental product compliance

EU RoHS

Fulfills EU RoHS substance requirements	Yes
Exemption	6(c)

China RoHS

Environment friendly use period (EFUP)	EFUP-50
	An article-related China RoHS declaration table can be found in the download area for the respective article under "Manufacturer declaration". For all articles with EFUP-E, no China RoHS declaration table issued and required.

EU REACH SVHC

REACH candidate substance (CAS No.)	Lead(CAS: 7439-92-1)
-------------------------------------	----------------------

HC-STA-D07-BWSCM-M32-EL-AL - Housing

1672263

<https://www.phoenixcontact.com/in/products/1672263>



Accessories

HC-D07-SL-PLBK - Housing brackets

1424440

<https://www.phoenixcontact.com/in/products/1424440>

Replacement latch for HC-D7 housing



US-EMLP (20X9) CUS - Plastic label

0830085

<https://www.phoenixcontact.com/in/products/0830085>

Plastic label, Card, can be ordered: by card, white, labeled according to customer specifications, mounting type: adhesive, Number of individual labels: 75, text field height: 9 mm, text field width: 20 mm



HC-STA-D07-BWSCM-M32-EL-AL - Housing

1672263

<https://www.phoenixcontact.com/in/products/1672263>



UNIFOX-WRENCH - Screw pliers

1212835

<https://www.phoenixcontact.com/in/products/1212835>



Screw pliers, with fast adjustment, for wrench size 10 mm ... 36 mm, size: 260 mm

Phoenix Contact 2025 © - all rights reserved

<https://www.phoenixcontact.com>

PHOENIX CONTACT (I) Pvt. Ltd.

A-58/2, Okhla Industrial Area, Phase - II, New Delhi-110 020

+91.1275.71420

info@phoenixcontact.co.in