

SWITCHLOCKS

Single Pole Double Throw (5 Amps 125/250 VAC)

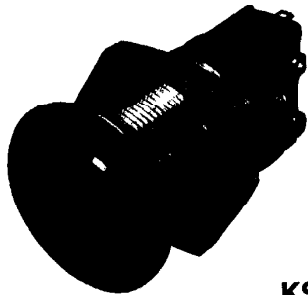

KS 64. Series

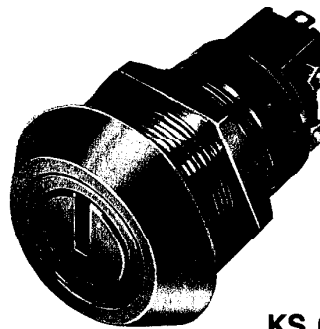

KS 65. Series

Compact switchlocks ideal for through-panel fixing in control panels, alarms, lighting controls etc (also available in flush or surface mounted control boxes — see pages 25-28)

KS 64 Series

Incorporates Kaba-20 flanged cylinder lock with 23mm threaded body fitted with a single pole miniature microswitch. Available in single entry, two key entry and spring return versions.

Supplied with — 2 Kaba-20 keys
— 1 locknut No. 3011
— key registration card

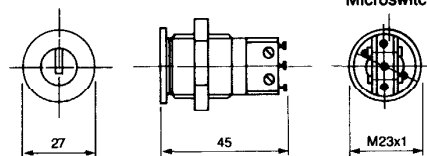

KS 65 Series

Similar to above but with removable screw-on chamfered front Bezel No SH31
Supplied with — 2 Kaba-20 Keys
— chamfered bezel (No. SH31)
— 1 Locknut No. 3011
— Key registration card.

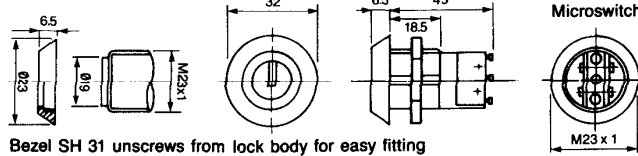

Bezel SH 31 unscrews from lock body for easy fitting

KS 67 Series

Similar to KS 65 series but with easy-grip bezel No. B31
Supplied with — 2 Kaba-20 keys
— 1 easy-grip bezel No. B31
— 1 Locknut No. 3011
— Key registration card.

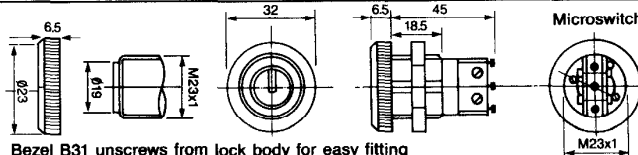

Bezel B31 unscrews from lock body for easy fitting

Ordering Specification

1 Key Entry	2 Key Entries	Spring Return	Fixing Method	PANEL CUT-OUT ALTERNATIVES	
				Flange Bezel SH31 (Chamfered) Bezel B31 Cut-Out	 CUT-OUT 'C' for Location Ring No. 3475
Model Ref. No.	Model Ref. No.	Model Ref. No.	 CUT-OUT 'B'		 Location Ring No. 3475
KS 64.100	KS 64.200	KS 64.300			
KS 65.100	KS 65.200	KS 65.300			
KS 67.100	KS 67.200	KS 67.300			
B	A	B			

ELECTRICAL SPECIFICATIONS

Life of switch: 30000 operations at 3 amp 250 VAC
Terminal Type: Thin (0.5mm thick) terminal for use with solder or PCB mounting.
These switches are approved to UL, CSA, SEV and TIS Standards.
Alternative switch available on request:
0.1A. 30V.DC/125V.AC with gold alloy crossbar.

Rated Voltage (V)	Non-Inductive Load		Inductive Load	
	Resistive (A)	Lamp (A)	Inductive (A)	Motor (A)
AC 110 to 125	5	1.5	3	2.5
220 to 250	5	1.0	2	1.5
DC 6 to 8	5	2	5	3
110 to 125	0.4	0.05	0.4	0.05
220 to 250	0.2	0.03	0.2	0.03



Kaba Locks Ltd., P.O. Box 2, Tiverton, Devon EX16 5DS

Tel: (0884) 256464

Fax: (0884) 255818

Telex: 42564 KABA G