



ENGLISH

Datasheet

RS Pro C14 IEC Plug

Stock No: 488-191



Product Details

Durabel 10 Amp C14 flange mount panel plug with 6.3mm spade terminals, maximum panel thickness 2mm. Suitable for many mains power input applications.

250V rated, connection by 6.3mm (1/4 in) receptacles

Rated at 10 Amps

Resistance withstand voltage 2000 Vac for 1 minute

Depth 33mm, fixing hole diameter 3.5mm

Use insulating boot stock no. 526-0724

Note

All of these plugs and sockets have a contact resistance of $<10\text{m}\Omega$, and an insulation resistance of $>103\text{M}\Omega$. Their operating temperature is -40°C to $+70^{\circ}\text{C}$

Approvals

UL, CSA, TUV

Dimensions

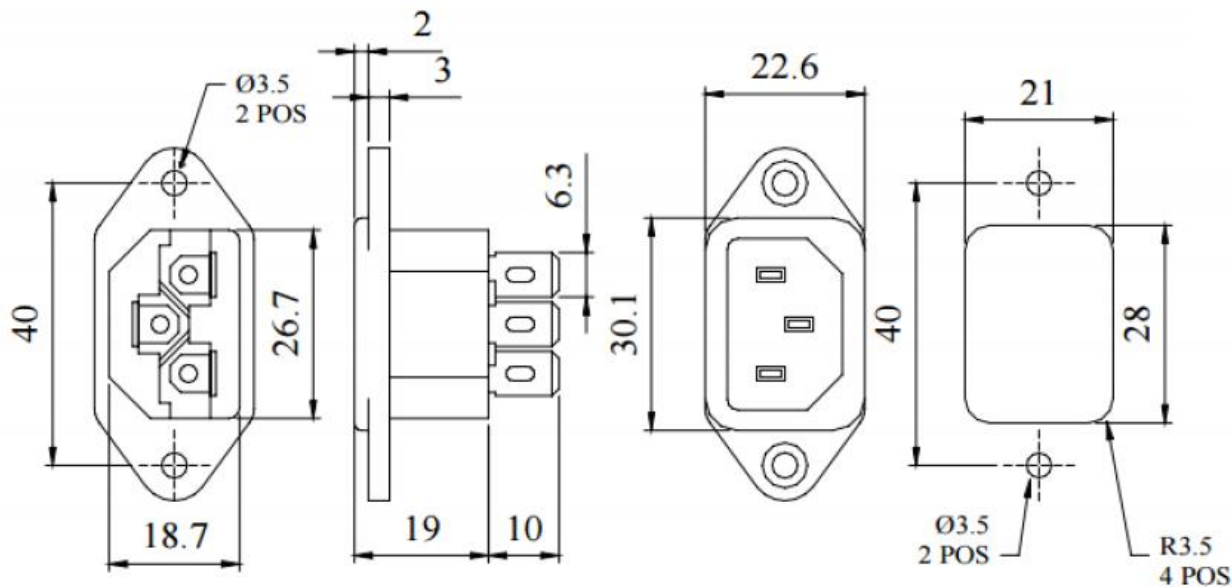

Specifications

IEC Connector Type:	C14
Mounting Type:	Panel Mount
Gender:	Male
Current Rating:	10A
Body Orientation:	Straight
Termination Method:	Solder, Spade
Switch Type:	None
Voltage Rating:	250 V ac