



## Datasheet

### RS PRO

#### Stock numbers:

1774490

1774492

1774495

1774497

1774498

1774501

1774503

EN



- ◆ LD3 features its compact design, which is suitable for various applications that require limited installation space.
- ◆ Input voltage : 24V DC / 12V DC
- ◆ Max. load : 1200N (push/pull)
- ◆ Max. current : 3.5 A @ 12V DC
- ◆ Max. speed : 44 mm/sec @ no load
- ◆ Stroke : 50~300 mm (other strokes are available)
- ◆ Duty cycle : 25% or 1 min continuous operation in 4 min.
- ◆ IP protection level : IP54
- ◆ Colour : Aluminum grey
- ◆ Certified : EN 55014-1  
EN55014-2
- ◆ Noise level :  $\leq 70$ dB
- ◆ Preset limit switches

RS Number	Vendor Part Number	Push/Pull Max. (N)	Speed (mm/s)		Voltage (DC)	Stroke (mm)
			No load	Full load		
1774490	LD3-24-20-E6-100-C11	500	14.6	13.5	24	100
1774492	LD3-12-20-E6-300-C11	500	14.6	13.5	12	300
1774495	LD3-24-20-E6-050-C11	500	14.6	13.5	24	50
1774497	LD3-24-20-E6-300-C11	500	14.6	13.5	24	300
1774498	LD3-12-20-E6-050-C11	500	14.6	13.5	12	50
1774501	LD3-G -20-E6-200-C11	500	14.6	13.5	24	200
1774503	LD3-12-20-E6-100-C11	500	14.6	13.5	12	100

E6: 3000 RPM motor with 6mm dual threaded spindle

## Speed vs Load

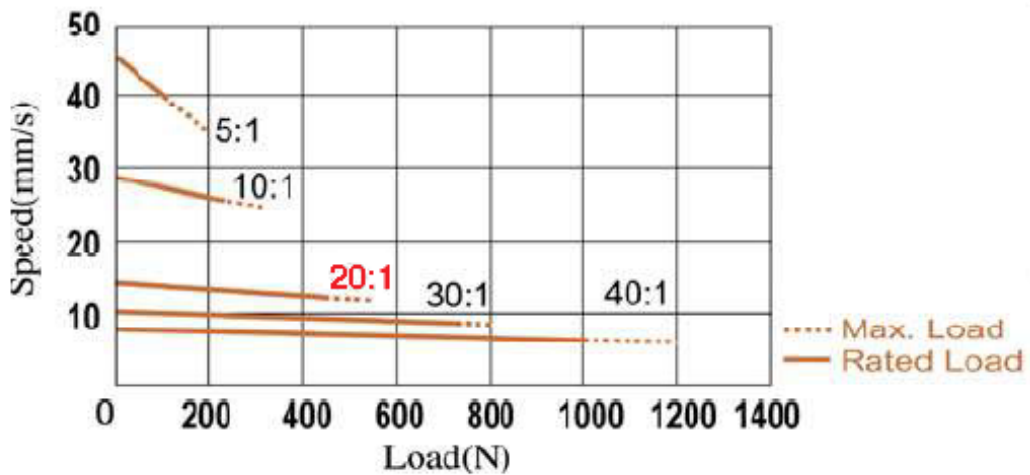

## Current vs Load

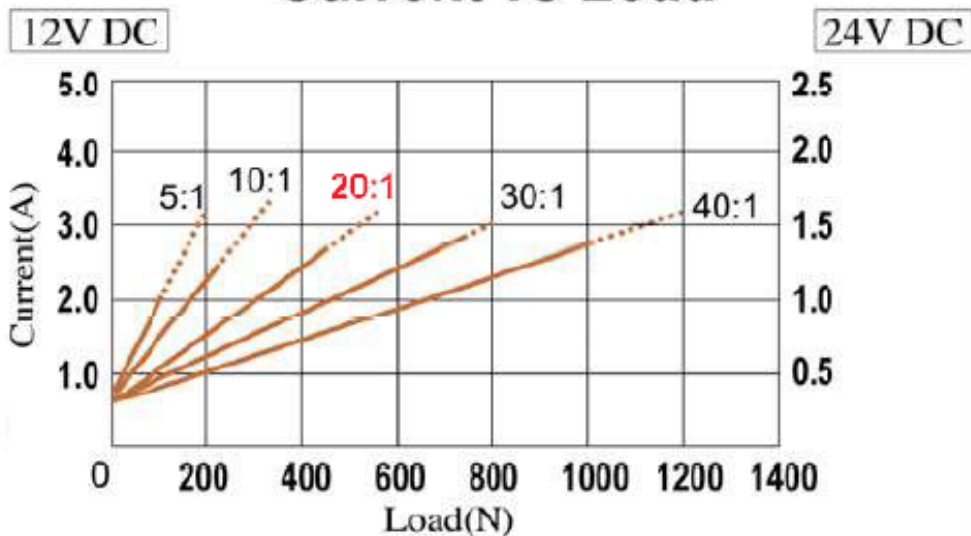

Model No.	Push/Pull Max. (N)	Speed (mm/s)		Current (A)			
		No load	Full load	No load		Full load	
				12V	24V	12V	24V
LD3-XX-05-(E6/K3)-XXX	150	43.9	40.0	0.8	0.4	2.0	1.0
LD3-XX-10-(E6/K3)-XXX	250	27.6	26.0	0.8	0.4	2.4	1.2
LD3-XX-20-(E6/K3)-XXX	500	14.6	13.5	0.8	0.4	2.6	1.3
LD3-XX-30-(E6/K3)-XXX	800	9.5	9.1	0.8	0.4	2.9	1.5
LD3-XX-40-(E6/K3)-XXX	1000	7.0	6.5	0.8	0.4	2.8	1.4

E6: 3000 RPM motor with 6mm dual threaded spindle

K3: 6000 RPM motor with 3mm single threaded spindle

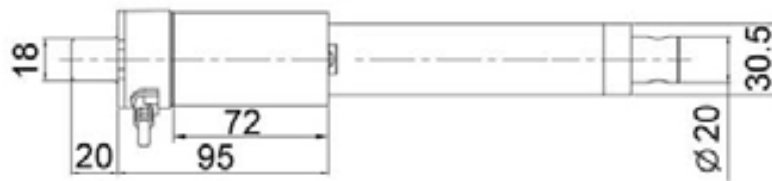

Dimensions in millimetres

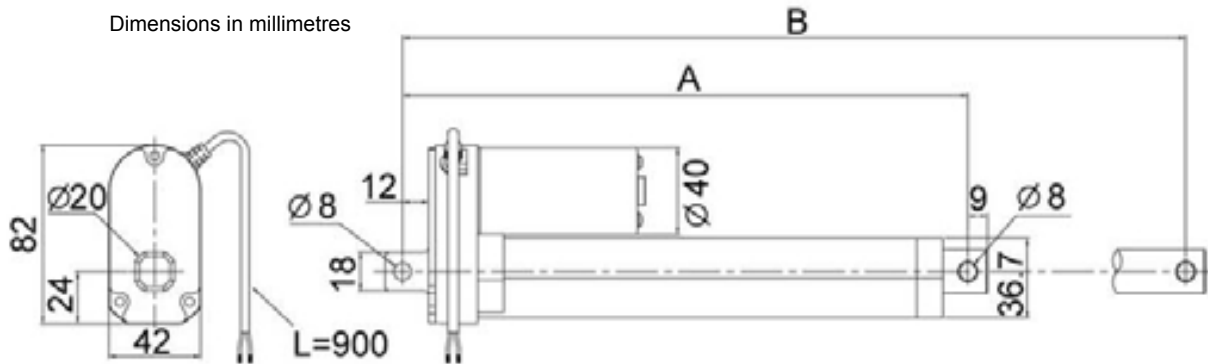

◆ Front connector

◆ Rear connector

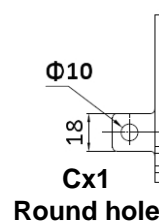
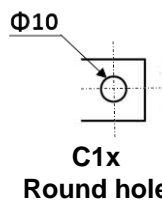

# Ordering Key

LD3 —  —  —  —  — C

**Input Voltage**

12 : 12V DC  
24 : 24V DC

**Gear Ratio**

05 : 5:1  
10 : 10:1  
20 : 20:1  
30 : 30:1  
40 : 40:1

**Motor and Spindle Type**

G3 : 4500rpm, pitch=3mm, single thread  
E6 : 3000rpm, pitch=6mm, double thread  
K3 : 6000rpm, pitch=3mm, single thread  
D3 : 2400rpm, pitch=3mm, single thread

**Stroke**

050 : 50mm  
100 : 100mm  
150 : 150mm  
200 : 200mm  
250 : 250mm  
300 : 300mm

**Front Connector**

1 : Round hole

**Rear Connector**

1 : Round hole