

WHEEL QD SINGLE FLANGED 105X20/27 BB.15

Wheel series QD

Cast iron wheels, flanged to run on rails (Decauville) with flat tread and with ball bearings.
Wheel fitted with ball bearings.



Technical data

Wheel diameter	D	105 mm
Tyre width	E	20,0 mm
Bearing seat diameter	s	35 mm
Bore diameter	d	15 mm
Outer faces bearings distance	V	27 mm
Weight article		1,140 kg
Hub width	L	27 mm
Load Capacity		250 kg

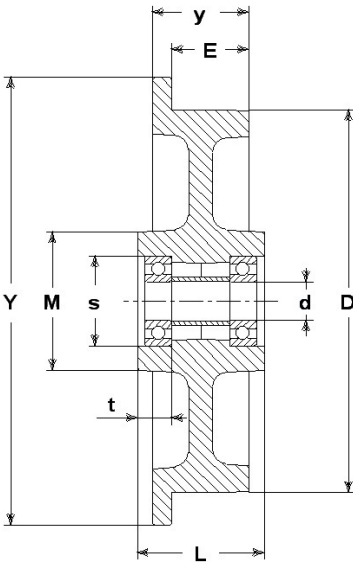

GENERAL INFORMATION / RECOMMENDATIONS AND WARNINGS

The cited text and the complete catalogue in their most up-dated versions are available in the OEM's website page www.lagspa.it/downloads. The dimensions, descriptions, specifications and illustrations herein are indicative and subject to variations without notice. The fact that products are illustrated herein does not necessarily imply they are available from stock nor does it place us under any obligation to supply them. Tests carried out refer to the original products with original accessories: the replacement of one of the components with others of different manufacture might prevent the same results from being achieved and will automatically invalidate any guarantee. Please contact our technical service concerning any special application.