



Datasheet

ENGLISH

Spring Loaded Index Plunger with Locking Rest Position

Knob material

High impact resistant thermoplastic

Knob finish

Matt

Body material

Burnished steel or stainless steel

Standard colour

Black knob

Options

Comes as standard with 90° locking rest position in plunger body.

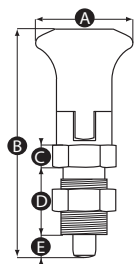
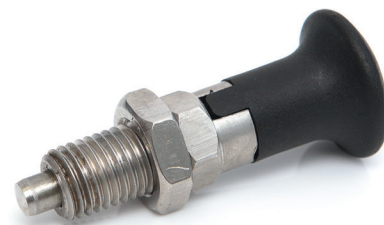

Part No.	A	B	C	D	E	Thread size	Plunger diameter (mm)	Body material
237766	21	51	5	17	5	M10x1.0	5	Burnished steel
237788	25	61	6	20	6	M12x1.5	6	Burnished steel
237794	31	76	8	26	7	M16x1.5	8	Burnished steel
237390	21	51	5	17	5	M10x1.0	5	Stainless steel
237401	25	61	6	20	6	M12x1.5	6	Stainless steel
237407	31	76	8	26	7	M16x1.5	8	Stainless steel