



SEC100-5C9D1SFZZZZ

sensingCam SEC100

2D MACHINE VISION

SICK
Sensor Intelligence.



Ordering information

| Type | part no. |
|--------------------|----------|
| SEC100-5C9D1SFZZZZ | 1143217 |

Other models and accessories → www.sick.com/sensingCam_SEC100



Detailed technical data

Features

| | |
|------------------------------|--|
| Product category | Streaming, flexible |
| Technology | 2D snapshot, streaming |
| Sensor | CMOS ColorPowerful in low light |
| Shutter technology | Rolling-Shutter |
| Sensor resolution | 2,880 px x 1,616 px (5 Mpixel) |
| Working distance | 300 mm ... 10,000 mm |
| Field of view | 82° x 52° |
| Memory | 6 GB, internal memory or FTP upload |
| Lighting | Without |
| Lens | Integrated |
| Livestream | |
| Scan/frame rate | 5 fps ... 30 fps |
| Video resolution | Full resolution (2,880 x 1,616 pixels) @ 25 fps |
| | Full HD (1,920 x 1,080 pixels) @ 30 fps |
| | 720p (1,280 x 720 pixels) @ 30 fps |
| Video protocol | RTSP, MJPG |
| Real-time video transmission | Two individually configurable RTSP streams, one MJPEG stream |
| Video compression | H.264, H.265, Motion JPEG, configurable compression level |
| Image capture | |
| Image format | JPEG, BMP |
| Trigger | Digital input or software trigger via REST API |

Interfaces

| | |
|------------------------|--|
| REST API | ✓ |
| Ethernet | ✓ , TCP/IP |
| Remark | DHCP/static (default: 192.168.136.100) |
| Data transmission rate | 100 Mbit/s, 100Base-TX |

| | |
|-------------------------------|-----------------------|
| Configuration software | Web server integrated |
|-------------------------------|-----------------------|

Electronics

| | |
|--|--|
| Supply voltage | 12 V DC ... 24 V DC ¹⁾ |
| Power consumption | Typ. 2 WMax. 10 W |
| Digital input, level | Active: $10\text{ V} \leq U_{IN} \leq U_V$ Inactive: $U_{IN} \leq 2\text{ V}$ |
| Protection class | III |
| Enclosure rating | IP65 |
| Pinouts <small>Voltage supply</small> | |
| – 1 | + (L+) |
| – 2 | MF _{In/Out} |
| – 3 | - (M) |
| – 4 | Not connected |
| Pinouts <small>ETHERNET</small> | |
| – 1 | Tx + |
| – 2 | Tx - |
| – 3 | Rx + |
| – 4 | Rx - |

¹⁾ SELV/PELV in acc. with currently applicable standards. Ensure the circuits connected to the device meet the requirements of ES1 and max. PS2 in accordance with IEC/UL/EN 62368-1. The Ethernet connection must meet the requirements of ES1 and PS1. Protect the supply circuit with a 1 A fuse. Nominal 12 V DC ... 24 V DC tolerance $\pm 10\%$.

Mechanics

| | |
|-------------------------------|--|
| Dimensions (W x H x D) | 57.5 mm x 49 mm x 33.6 mm (without connection) |
| Housing material | Aluminum, polycarbonate |
| Window material | Glass |
| Weight | 120 g |
| Mounting | Two threads for M4 screws Two grooves for sliding nuts One ¼" - 20 UNC thread for photo tripod |
| Connection type | |
| Power supply | Plug, M12, 4-pin, A-coded |
| Ethernet connection | M12 female connector, 4-pin, D-coded |

Ambient data

| | |
|---------------------------------------|--|
| Ambient temperature, operation | 0 °C ... +50 °C, Optimal image quality at 10 °C ... +40 °C |
| Ambient temperature, storage | -20 °C ... +60 °C |
| Permissible relative humidity | $\leq 90\%$ |
| Shock resistance | 150 m/s ² EN 60068-2-27 |
| Vibration resistance | EN 60068-2-6, EN 60068-2-64 |

Classifications

| | |
|---------------------|----------|
| ECLASS 5.0 | 27310205 |
| ECLASS 5.1.4 | 27310205 |
| ECLASS 6.0 | 27310205 |

| | |
|----------------|----------|
| ECLASS 6.2 | 27310205 |
| ECLASS 7.0 | 27310205 |
| ECLASS 8.0 | 27310205 |
| ECLASS 8.1 | 27310205 |
| ECLASS 9.0 | 27310205 |
| ECLASS 10.0 | 27310205 |
| ECLASS 11.0 | 27310205 |
| ECLASS 12.0 | 27310205 |
| ETIM 5.0 | EC001820 |
| ETIM 6.0 | EC001820 |
| ETIM 7.0 | EC001820 |
| ETIM 8.0 | EC001820 |
| UNSPSC 16.0901 | 43211731 |

Certificates

| | |
|------------------------------------|---|
| EU declaration of conformity | ✓ |
| UK declaration of conformity | ✓ |
| ACMA declaration of conformity | ✓ |
| Moroccan declaration of conformity | ✓ |
| China-RoHS | ✓ |
| cULus certificate | ✓ |

Dimensional drawing, sensor

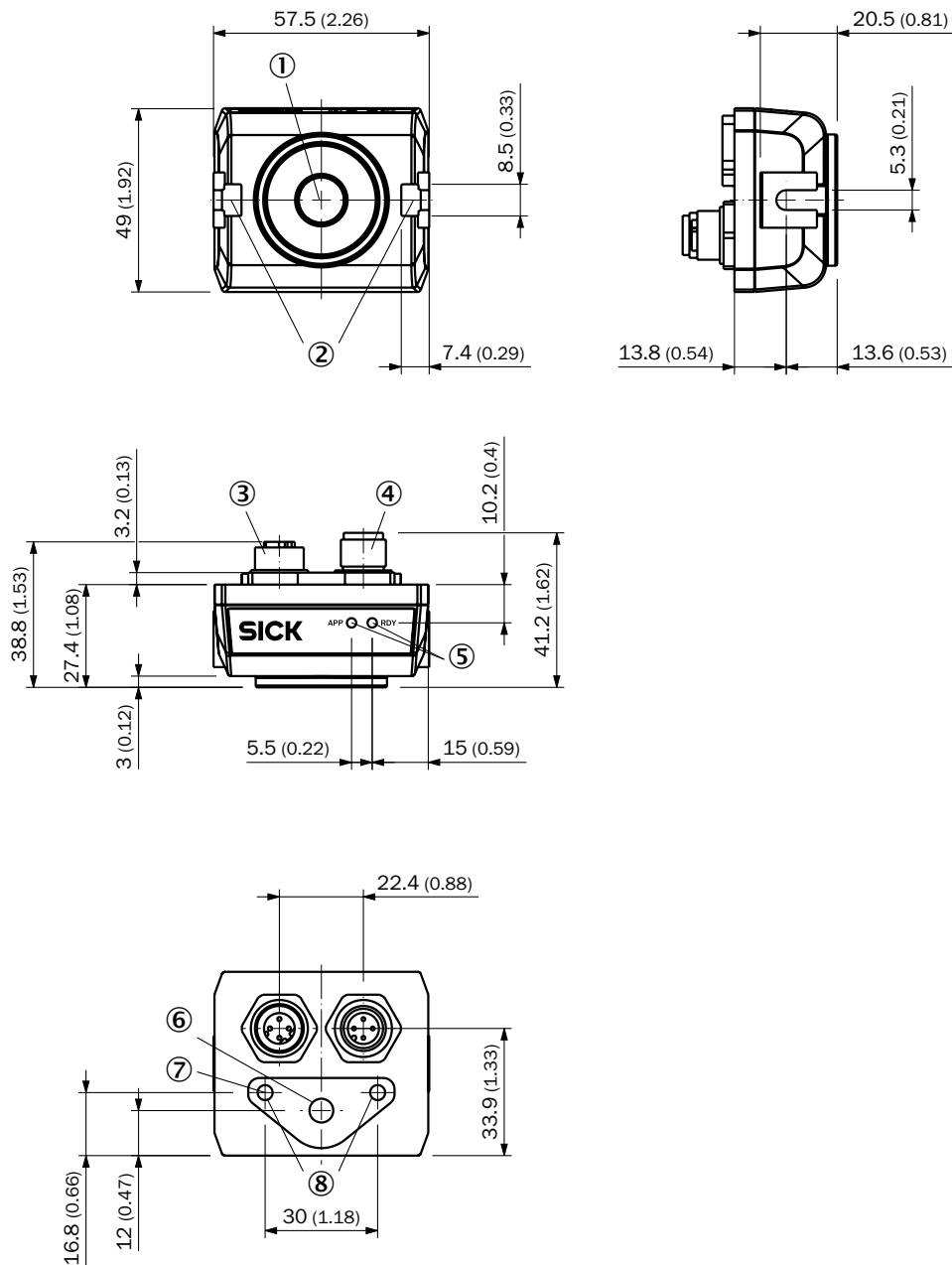

Dimensions in mm (inch)

- ① Camera with protective glass
- ② two grooves for sliding nuts
- ③ Ethernet port: M12 socket, 4-pin, D-coded
- ④ power supply: plug, M12, 4-pin, A-coded
- ⑤ Display elements: Power LED + application LED
- ⑥ one 1/4" - 20 UNC thread for photo tripod
- ⑦ Earthing thread (M4) for making a functional earth connection
- ⑧ two threads for M4 screws

pinouts: power supply/Ethernet port

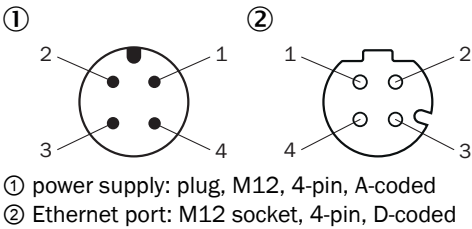

connection diagram: power supply/Ethernet port

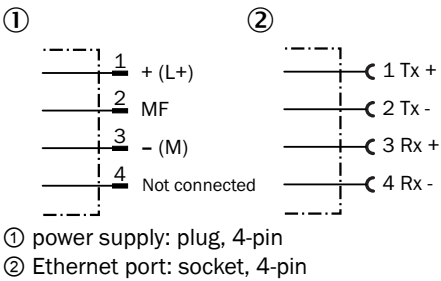

Field of view - horizontal/vertical

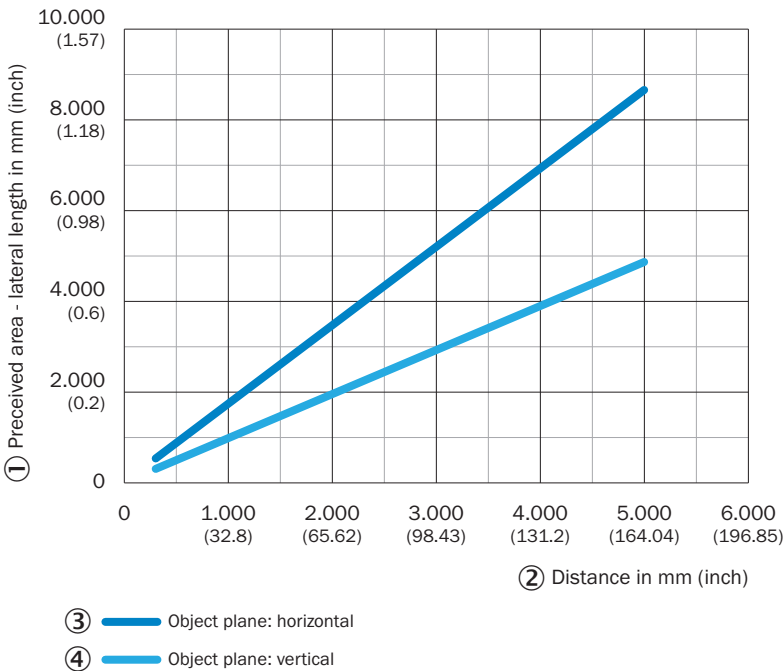

Recommended accessories

Other models and accessories → www.sick.com/sensingCam_SEC100

| | Brief description | Type | part no. |
|---|--|---------------------|----------|
| Mounting systems | | | |
|  | <ul style="list-style-type: none"> Description: Sliding nut, M4, short | Sliding nut | 5324897 |
|  | <ul style="list-style-type: none"> Description: Sliding nut, M5, short Usable for: Lector62x, EventCam | Sliding nut | 5324896 |
|  | <ul style="list-style-type: none"> Description: Mounting set for sensingCam SEC100 consisting of: 1x mounting bracket (U-shaped), 2x M4 screws incl. washers, 2x sliding blocks Material: Steel Details: Steel, zinc coated Suitable for: sensingCam SEC100 | BEF-SEC100 | 2145053 |
|  | <ul style="list-style-type: none"> Description: Mounting set for sensingCam SEC100 consisting of: 1x mounting bracket (L-shaped), 2x M4 screws incl. washers Material: Steel Details: Steel, zinc coated Suitable for: sensingCam SEC100 | BEF-SEC100/300 | 2145070 |
| | <ul style="list-style-type: none"> Description: Mounting set for sensingCam SEC100 consisting of: 1x mounting bracket (L-shaped), 2x M4 screws incl. washers Material: Steel, metal Details: Zinc plated steel (angle), Zinc die cast (clamping bracket) Items supplied: Universal clamp (5322626), mounting hardware Suitable for: sensingCam SEC100 | BEF-KHS-SEC100/300 | 2147922 |
| connectors and cables | | | |
|  | <ul style="list-style-type: none"> Connection type head A: Female connector, M12, 5-pin, straight, A-coded Connection type head B: Flying leads Signal type: Sensor/actuator cable Cable: 2 m, 5-wire, PUR, halogen-free Description: Sensor/actuator cable, unshielded Application: Uncontaminated zones, Zones with oils and lubricants, Robot, Drag chain operation | YF2A15-020UB5XLEAX | 2095617 |
|  | <ul style="list-style-type: none"> Connection type head A: Male connector, M12, 4-pin, straight, D-coded Connection type head B: Male connector, RJ45, 4-pin, straight Signal type: Ethernet, PROFINET Cable: 5 m, 4-wire, PUR, halogen-free Description: Ethernet, shieldedPROFINET Application: Drag chain operation, Zones with oils and lubricants | YM2D24-050P-N1MRJA4 | 2106184 |
|  | <ul style="list-style-type: none"> Connection type head A: Female connector, M12, 4-pin, straight, A-coded Description: Unshielded, Head A: female connector, M12, 4-pin, straight, unshielded, for power supply, for cable diameter 4 mm ... 6 mm Head B: - Connection systems: Screw-type terminals Permitted cross-section: ≤ 0.75 mm² | DOS-1204-G | 6007302 |
|  | <ul style="list-style-type: none"> Connection type head A: Female connector, M12, 4-pin, straight, A-coded Connection type head B: Male connector, M12, 4-pin, straight, A-coded Signal type: Sensor/actuator cable Cable: 5 m, 4-wire, PVC Description: Sensor/actuator cable, unshielded Application: Zones with chemicals, Uncontaminated zones | YF2A14-050VB3M2A14 | 2096600 |
|  | <ul style="list-style-type: none"> Connection type head A: Female connector, M12, 4-pin, straight, A-coded Connection type head B: Flying leads Signal type: Sensor/actuator cable Cable: 5 m, 4-wire, PVC Description: Sensor/actuator cable, unshielded Application: Zones with chemicals, Uncontaminated zones | YF2A14-050VB3XLEAX | 2096235 |

SICK AT A GLANCE

SICK is one of the leading manufacturers of intelligent sensors and sensor solutions for industrial applications. A unique range of products and services creates the perfect basis for controlling processes securely and efficiently, protecting individuals from accidents and preventing damage to the environment.

We have extensive experience in a wide range of industries and understand their processes and requirements. With intelligent sensors, we can deliver exactly what our customers need. In application centers in Europe, Asia and North America, system solutions are tested and optimized in accordance with customer specifications. All this makes us a reliable supplier and development partner.

Comprehensive services complete our offering: SICK LifeTime Services provide support throughout the machine life cycle and ensure safety and productivity.

For us, that is “Sensor Intelligence.”

WORLDWIDE PRESENCE:

Contacts and other locations –www.sick.com