

REVISIONS					
REV	ECO	DESCRIPTION	DATE	BY	APPR
A3	-	RELEASE NEW DWG FORMAT	06NOV13	DRP	-

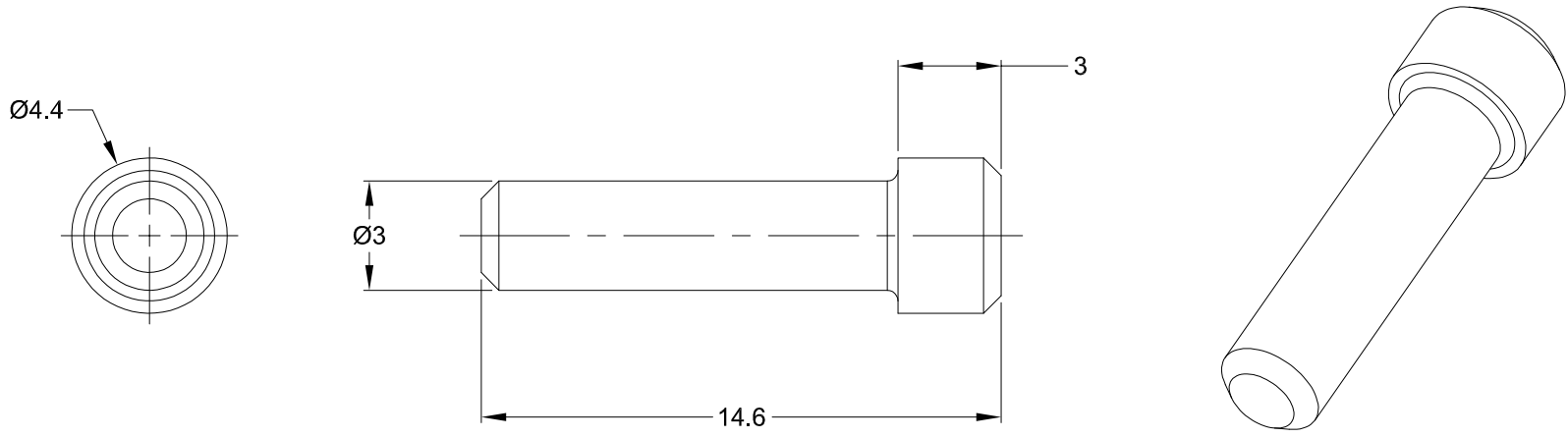

NOTES: UNLESS OTHERWISE SPECIFIED

1. MATERIAL: THERMOPLASTIC; RoHS COMPLIANT
2. COLOR: WHITE
3. CONTACT SIZE: 16
4. FITS AT, ATP & AHD SERIES CONNECTORS
5. ALL DIMENSIONS ARE FOR REFERENCE USE ONLY.

A114017													
PART NUMBER		DESCRIPTION			ITEM								
QUANTITY	MATERIALS LIST												
<small>UNLESS OTHERWISE SPECIFIED</small> 1) All dimensions are in metric(mm). 2) Tolerances are as follows: 1 PL DEC ± 0.30 2 PL DEC ± 0.15 3 PL DEC ± 0.08 3) Note reference =	SIGNATURES		DATE		<h1 style="text-align: center;">Amphenol</h1> <p style="text-align: center;">Sine Systems - www.amphenol-sine.com 44724 Morley Drive Clinton Township, MI 48036</p> <p style="text-align: center;">SEAL, PLUG, CONTACT SIZE 16, AT, ATP & AHD SERIES</p>								
	DRAWN: D.PARKS		06NOV13										
	CHECKED:												
	ENGINEER:												
MATERIAL SPECIFICATIONS:		APPROVAL:											
PROCESS SPECIFICATIONS:		CUSTOMER:											
NEXT ASSY:		<small>THIS DRAWING IS SUPPLIED FOR INFORMATION ONLY. DESIGN FEATURES, SPECIFICATIONS AND PERFORMANCE DATA SHOWN HEREON ARE THE PROPERTY OF THE AMPHENOL CORPORATION. NO RIGHTS OF REPRODUCTION ARE IMPLIED. ALL DIMENSIONS ARE SUBJECT TO NORMAL MANUFACTURING VARIATIONS.</small>		<table border="1"> <tr> <td>SIZE</td> <td>TYPE</td> <td>DWG NO:</td> <td>REVISION</td> </tr> <tr> <td>A</td> <td>C-</td> <td>A114017</td> <td>A3</td> </tr> </table>		SIZE	TYPE	DWG NO:	REVISION	A	C-	A114017	A3
SIZE	TYPE	DWG NO:	REVISION										
A	C-	A114017	A3										
		SCALE: NONE		SHEET 1 OF 1									