

Rectangular Type

DC

3-wire

Basic series

10 mm not embed.
15 mm not embed.

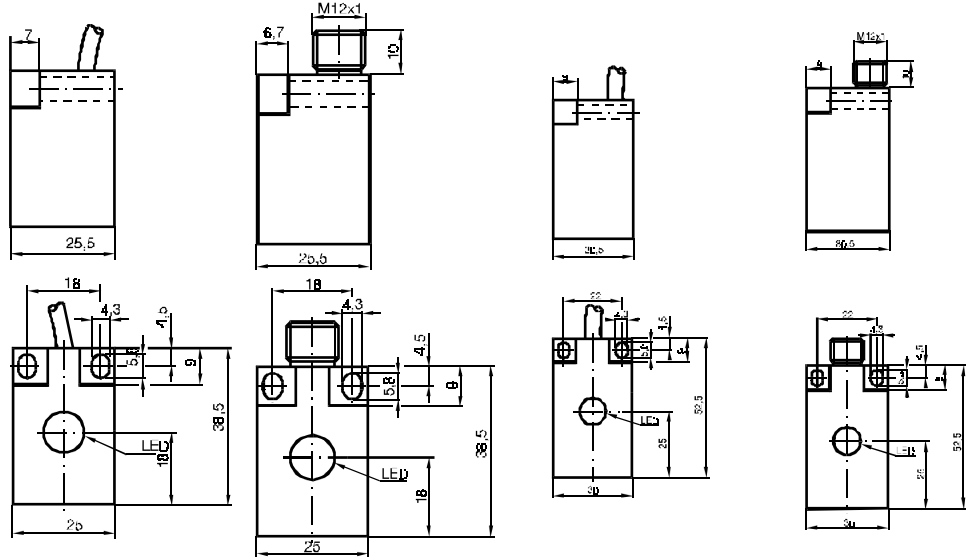

Operating dist. s_n, mounting	10 mm, not embedd.	10 mm, not embedd.	15 mm, not embedd.	15 mm, not embedd.
PNP	Make function	NBN10-F10-E2	NBN10-F10-E2-V1	NBN15-F11-E2
	Break function			
NPN	Make function	NBN10-F10-E0	NBN10-F10-E0-V1	NBN15-F11-E0
	Break function			
Assured operat. dist. s _a [mm]	0 ... 7,65	0 ... 7,65	0 ... 12,15	0 ... 12,15
Reduction factor	r _{V2A}	0,6	0,6	0,6
	r _{AI}	0,3	0,3	0,3
	r _{Cu}	0,2	0,2	0,2
Operating voltage U _B [V]	10 ... 30	10 ... 30	10 ... 30	10 ... 30
Operational current I _L [mA]	150	150	150	150
Switching frequency [Hz]	500	500	150	150
No-load supply current [mA]	15	15	15	15
Voltage drop [V]	3	3	3	3
Short circuit protection	pulsing	pulsing	pulsing	pulsing
Reverse polarity protection	yes	yes	yes	yes
Output indicator	LED, yellow	LED, yellow	LED, yellow	LED, yellow
Operating temperature [°C]	-25 ... 70	-25 ... 70	-25 ... 70	-25 ... 70
In compliance with	EN60947-5-2	EN60947-5-2	EN60947-5-2	EN60947-5-2
Protection to DIN 40050	IP 67	IP 67	IP 67	IP 67
Connection	2 m, PVC-cable	V1- connector	2 m, PVC-cable	V1- connector
Conductor cross section	0,34 mm ²	-	0,34 mm ²	-
Housing material	PBT	PBT	PBT	PBT
Sensing face	PBT	PBT	PBT	PBT

Standard symbol / connection

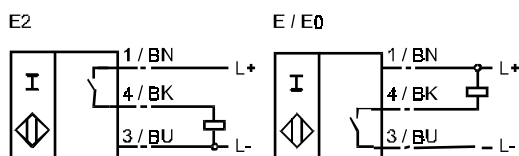

Inductive sensors