

Miniature Circular Plastic Connector (CPC)

DESCRIPTION

Revised 09/02 1309175

- Connector system available in wire-to-wire, wire-to-board and wire-to-panel configurations.
- Two shell sizes: Size 8 (1-4) or Size 11 (5-9) contact positions
- Utilizes existing Mini-Universal MATE-N-LOK stamped and formed contacts designed for up to 500 mating cycles when plated with gold or up to 50 cycles with tin plating.

APPLICATIONS

- Ideal for Industrial, Instrumentation and Transportation applications where size, contact density and environmental exposure are primary concerns.
- Nylon housings offer good resistance to a wide range of chemical agents while the IP67 sealing prevents ingress of dirt or fluids that could have an adverse effect on the contact interface.



KEY FEATURES

- Pre-positioned 1/4 turn coupling ring with positive lock and alignment features
- Unique contact pattern for each position size helps prevent accidental mating with other position sizes
- Sealed to IP67
- Front or rear jam nut mounting
- No assembly required
- Receptacle available in free-hanging or panel mount versions
- Alternate keys available

ELECTRICAL

- Current carrying capacity: 5 amps
- Operating voltage: 600 VAC minimum
- Dielectric withstanding voltage: 2200 VAC minimum

MECHANICAL

- Field repairable contacts
- Positive latching
- Housing - single piece design, plastic
- Wire termination - crimp
- Mating application:
 - wire-to-wire
 - wire-to-panel (able to be sealed at the panel - jam nut mounting)
 - wire-to-board (vertical and right-angle)

STANDARDS & SPECS

- Design Objectives: 108-2079

Miniature CPC

MATERIALS

- | | | | |
|---------------------|----------------------------|--------------------------|----------------------|
| • Seal, Wire Entry: | Elastomer, Yellow or White | • Ring, Coupling: | Thermoplastic, Black |
| • Seal, Peripheral: | Elastomer, Gray | • Nut, Jam | Brass, Nickel Plated |
| • Housing: | Thermoplastic, Black | • Plate, Seal Retention: | Thermoplastic, Black |

CABLE ASSEMBLIES

- Wide variety of custom discrete type cable assemblies, terminated with Terminals and Splices, Soft-Shell, and Circular Plastic Connectors and other crimp and mass-terminated products.
- Capability to produce custom overmolded assemblies and insert and injection molding.
- Jacketed cable assemblies and discrete wire: Subminiature-D, SCSI, Circular Plastic, VHDCI, USB and Shielded Data Link
- For more information on our cable assembly capabilities, see our website at www.tycoelectronics.com/cables

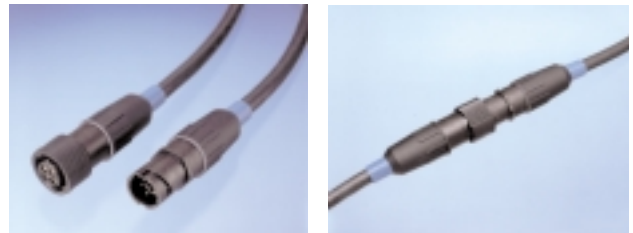

PRODUCT DIMENSIONS

Shell Size 8 (4 Position shown)

Receptacle Assembly, Panel Mount

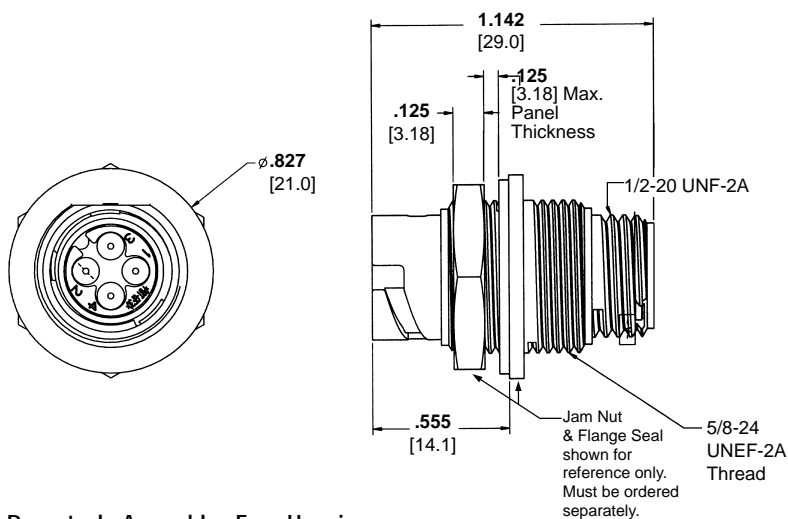

Plug Assembly

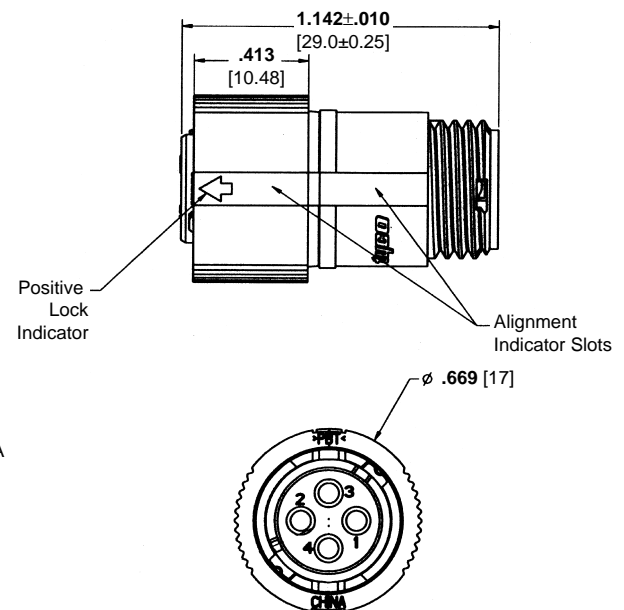

Receptacle Assembly, Free-Hanging

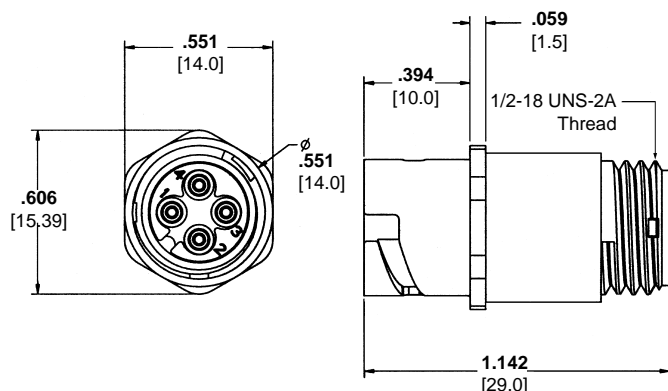

Miniature CPC

PRODUCT DIMENSIONS

Shell Size 11 (9 Position shown)

Receptacle Assembly, Panel-Mount

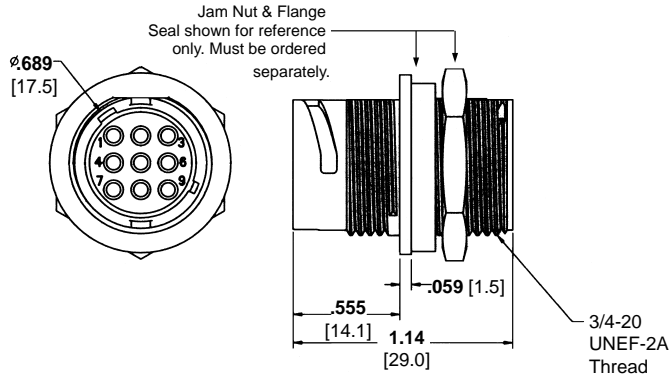

Plug Assembly

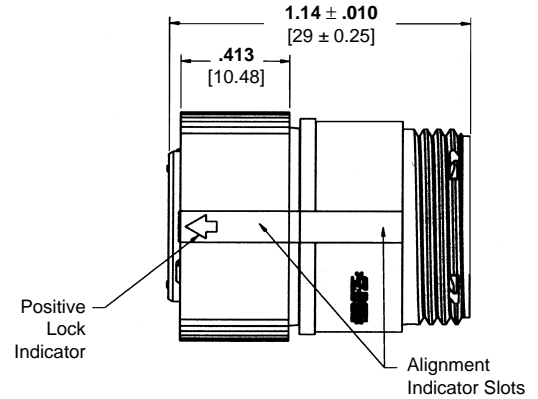

Receptacle Assembly, Free-Hanging

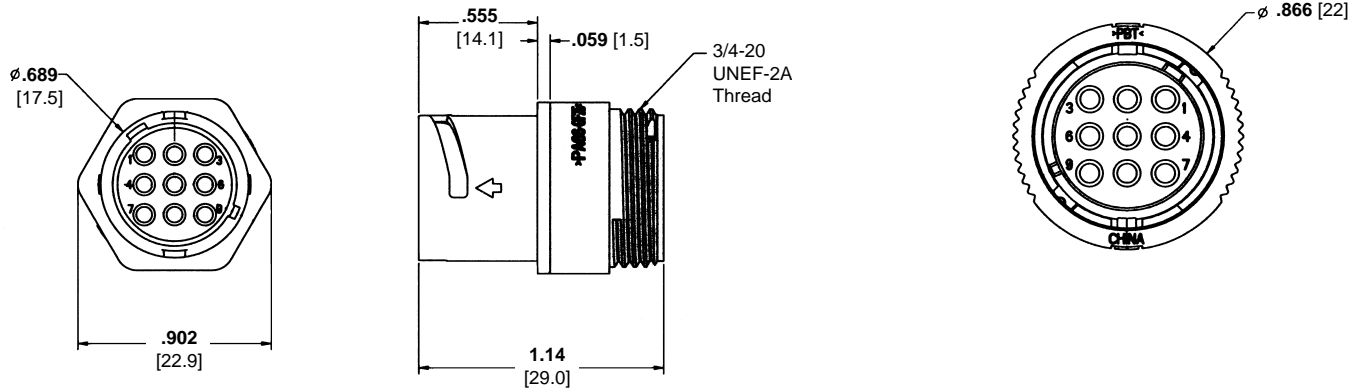

Accessories

Strain Reliefs

Shell Size	Dimensions		Part Number	
	A	B	Straight	Right-Angle
8	.925 [23.5]	.709 [18.0]	1445730-1	1445771-1
11	1.10 [28]	.964 [24.5]	1445856-1	1445857-1

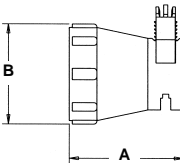

Jam Nuts

Shell Size	Dimensions		Thread	Part Number
	A	B		
8	.875 [22.25]	.125 [3.2]	3/4-20 UNEF-2B	1445904-1
11	.75 [19]	.125 [3.2]	5/8-24 UNEF-2B	1604196-1

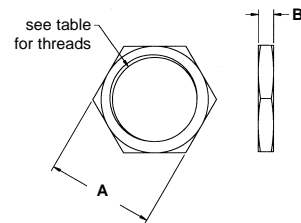

Flange Seals

Shell Size	Dimensions		Part Number
	A	B	
8	.60 [15.3]	0.26 [6.6]	1445420-1
11	0.73 [18.5]	0.33 [8.5]	1445420-2

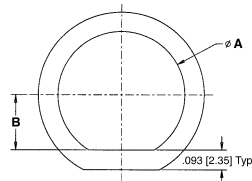

Dust Caps

Shell Size	Dimensions		Part Number
	A	B	
8	.795 [20.2]	.551 [14]	1604089-1
11	.89 [22.6]	.736 [18.7]	1604089-2

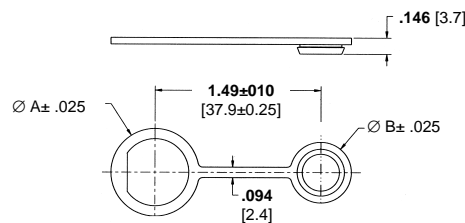

Miniature CPC

PRODUCT OFFERING

Housing Part Numbers

Arrangement	Insulation Diameter Range	Housing Part Numbers		
		Panel Mount	Free-Hanging	
		Receptacle	Receptacle	Plug
8-1	.035-.059 [.89-1.5]	1445539-1	1445526-1	1445536-1
	.059-.110 [1.5-2.39]	1445539-3	1445526-3	1445536-3
8-2	.035-.059 [.89-1.5]	1445538-1	1445522-1	1445535-1
	.059-.110 [1.5-2.39]	1445538-3	1445522-3	1445535-3
8-3	.035-.059 [.89-1.5]	1445537-1	1445510-1	1445534-1
	.059-.110 [1.5-2.39]	1445537-3	1445510-3	1445534-3
8-4	.035-.059 [.89-1.5]	1445421-1	1445389-1	1445390-1
	.059-.110 [1.5-2.39]	1445421-3	1445389-3	1445390-3
11-5	.035-.059 [.89-1.5]	1445824-1	1445829-1	1445820-1
	.059-.110 [1.5-2.39]	1445824-3	1445829-3	1445820-3
11-6	.035-.059 [.89-1.5]	1445823-1	1445828-1	1445819-1
	.059-.110 [1.5-2.39]	1445823-3	1445828-3	1445819-3
11-7	.035-.059 [.89-1.5]	1445822-1	1445827-1	1445818-1
	.059-.110 [1.5-2.39]	1445822-3	1445827-3	1445818-3
11-8	.035-.059 [.89-1.5]	1445821-1	1445826-1	1445817-1
	.059-.110 [1.5-2.39]	1445821-3	1445826-3	1445817-3
11-9	.035-.059 [.89-1.5]	1445816-1	1445825-1	1445807-1
	.059-.110 [1.5-2.39]	1445816-3	1445825-3	1445807-3

Note: Alternate keys available (115° part numbers shown in above chart)

STANDARD STOCKED PART NUMBERS

Contact and Tooling Part Numbers

Pin

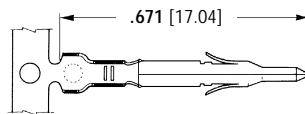

Socket

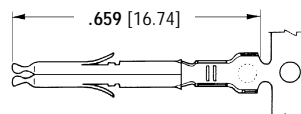

Contact Part Numbers

Wire Size Range AWG [mm²]	Ins. Dia. Range	Finish	Sockets						HDM Applicator Part No.	Hand Tool Part No.
			Pin		Brass		Phos Bronze			
			Strip Form	Loose Form	Strip Form	Loose Form	Strip Form	Loose Form		
30-26 [.05-.12]	.035-.050 .889-.127	Pre-tin Duplex ¹	770835-1	794059-1	770834-1	794058-1	770834-4	567418-1 ²	—	
			770835-3	794059-3	770834-3	794058-3	770834-6	567418-2 ²		
26-22 [.12-.3]	.047-.069 1.19-1.75	Pre-tin Duplex ¹	770901-1	770985-1	770902-1	770986-1	770902-4	567418-3 ²		90710-2
			770901-3	770985-3	770902-3	770986-3	770902-6	567066-3 ³		
22-18 [.3-.8]	.059-.110 1.50-2.39	Pre-tin Duplex ¹	770903-1	770987-1	770904-1	770988-1	770904-4	567066-4 ³	90711-2	
			770903-3	770987-3	770904-3	770988-3	770904-6	567066-5 ³		
								567067-1 ²		
								567067-2 ²		
								567067-3 ²		

¹ Duplex Finish— Plated with .000030 [.000762] min. gold in mating area and .000100 [.00254] min. tin-lead in crimping area over .000050 [.00127] min. nickel underplate on entire contact

² HDM Applicator part number ending in -1 is used on AMPOMATOR CLS Machine with T or G Terminators, -2 is used on AMP-O-LECTRIC Model K Machine, -3 is used on AMP-O-LECTRIC Model G Machine.

³ HDM Applicator part number ending in -3 is used on AMPOMATOR CLS Machine with T or G Terminators, -4 is used on AMP-O-LECTRIC Model K Machine, -5 is used on AMP-O-LECTRIC Model G Machine.



Contact Extraction Tool
Part No. 189727-1
Instruction Sheet 408-4118



Contact Insertion Tool
(For inserting contacts applied to small diameter wire)
Part No. 455830-1
Instruction Sheet 408-7984

