

PRODUCT DESCRIPTION CODE :

10131932-YXXXLF

PLATING :

1 = 0.76 µm GOLD ON CONTACT AREA
2.54µm MIN MATTE TIN ON TAIL

2 = 0.38µm GOLD ON CONTACT AREA
2.54µm MIN MATTE TIN ON TAIL

3 = 0.20µm GOLD ON CONTACT AREA
2.54µm MIN MATTE TIN ON TAIL

4 = 0.76 µm GXT ON CONTACT AREA
2.54µm MIN MATTE TIN ON TAIL

5 = 0.38µm GXT ON CONTACT AREA
2.54µm MIN MATTE TIN ON TAIL

6 = 0.20µm GXT ON CONTACT AREA
2.54µm MIN MATTE TIN ON TAIL

9 = 2.54µm MIN MATTE TIN FULL PLATED

1.27µm NICKEL MIN UNDERLAYER

NOTES :

1 - MATERIAL
HOUSING : HIGH TEMPERATURE GLASS FILLED FLAME
RETARDANT PER UL 94 V-0
TERMINAL: COPPER ALLOY

2- TO DETERMINE DIMENSIONS :
N = NUMBER OF POSITIONS PER ROW
EXAMPLE : 8 POS N x 2 = 16mm

3 - RoHS COMPATIBLE PRODUCT SPECIFICATIONS
a - PLATING :
"LF" MEANS THE PRODUCT IS LEAD-FREE, 2µm MINIMUM MATTE TIN OVER
1.27µm MINIMUM NICKEL UNDERPLATE

b - MANUFACTURING PROCESS COMPATIBILITY
THE HOUSING WILL WITHSTAND EXPOSURE TO 260°C ±5°C SOLDER BATH
TEMPERATURE FOR 5 SECONDS IN A WAVE SOLDER APPLICATION WITH A
1.6mm MIN THICK CIRCUIT BOARD.

c - LABELLING :
MEETS PACKAGING SPECS AS PER GS-14-920
d - LEGAL STATEMENT : SEE GS-47-0004

RoHS COMPATIBLE, SEE NOTE 3
PACKAGING : "U" FOR TUBE
TOTAL NUMBER OF POSITIONS 04 TO 50

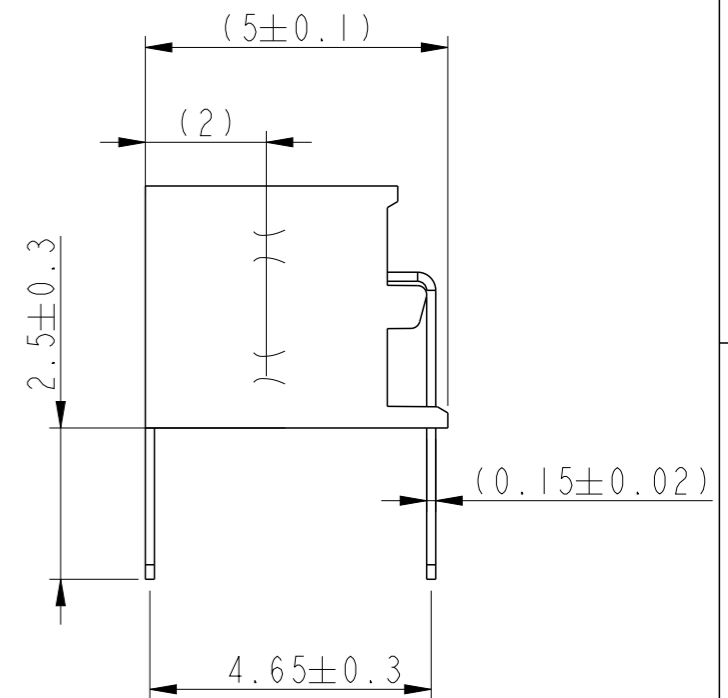
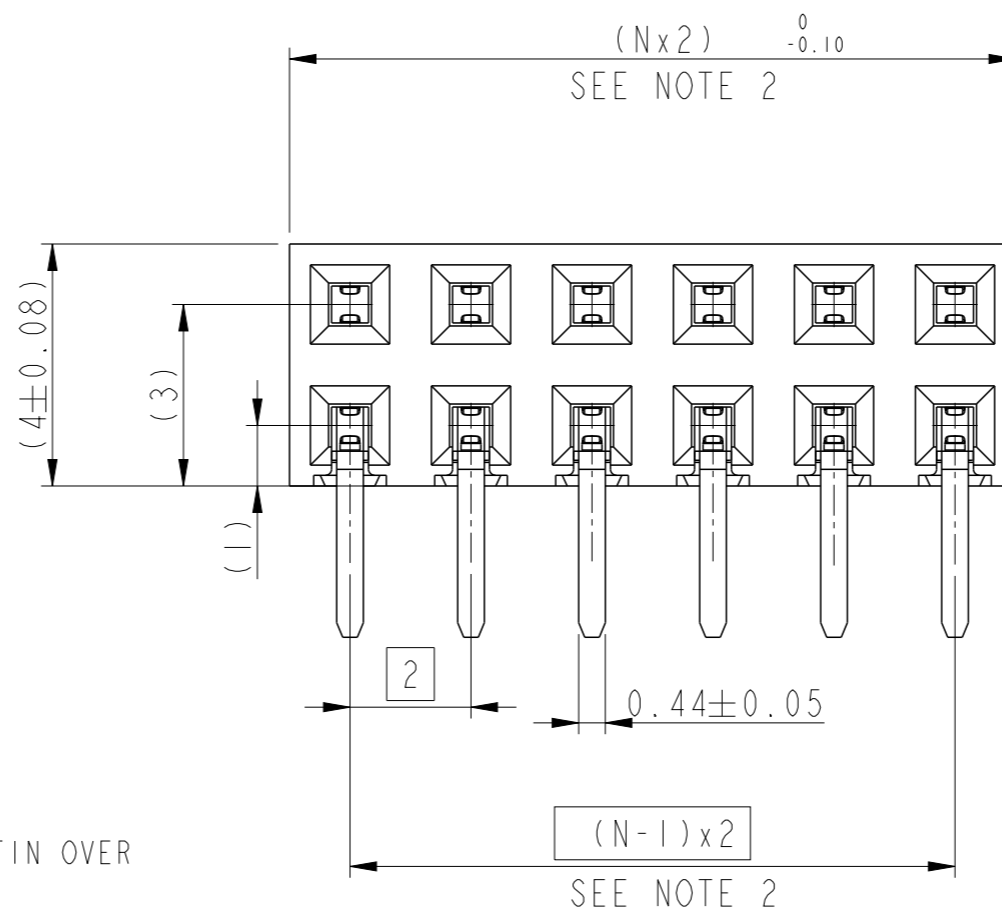
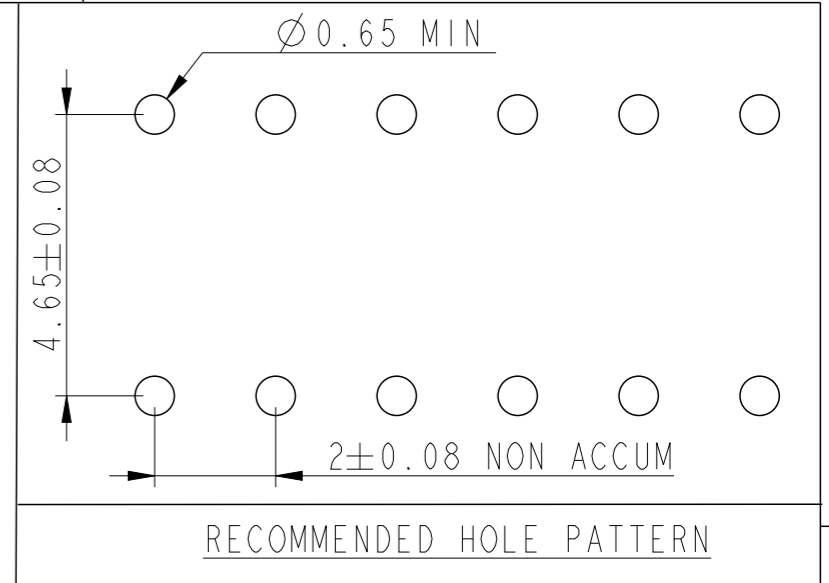

PRELIMINARY

spec ref	GS-12-1326	dr	Cyril Jeune	2014/12/02	projection	mm	size	A3	scale	8:1
tolerance std	ISO 406 ISO 1101	eng	Cyril Jeune	2015/11/18			ecn no	-	rel level	Preliminary
surface	ISO 1302	chr	-	-			product family	-	rel level	Preliminary
		appr	-	-			dwg no	10131932	rev	2
					MINITEK RECEPTACLE 2MM ASSEMBLY HCC DR TMT		cat. no.	-	Product - Customer Drw	sheet 1 of 1



Copyright FCI.