



✓ RoHS Compliant

MMPSA 240/100

Proximity Switch

Specification		
Contact Form		Normally Open
Switch Capacity	Max W/VA	10
Switched Voltage	Max VDC/AC	400
Switched Current	Max A	0.5
Carry Current	Max A	1.0
Contact Resistance		Less than 1 Ω
Operating Temperature	Deg C	-20 to +70

Features

- Blue Nylon 66 Housing
- 2 core PVC cable

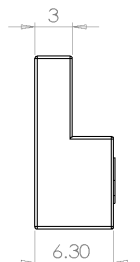
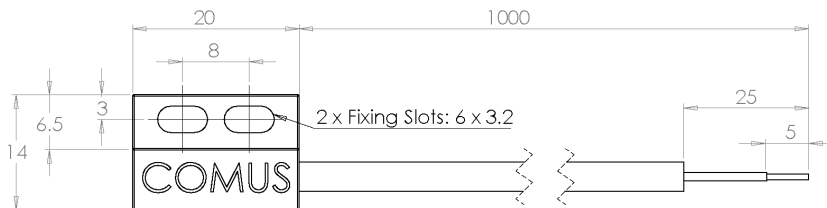

Note: Molded text may increase depth of housing by 0.15-0.20mm

Drawings not to scale (all dimensions in mm nominal)



Phone: +44(0) 1255 862236 **Fax:** +44(0) 1255 862014 **Website:** www.comus-intl.com

©2018 Copyright Comus Europe Ltd, Unit 7, Rice Bridge Industrial Estate, Thorpe-Le-Soken, Essex, CO16 0HL, England.

ISO 9001:2015
Certificate No: FM21080

Revision Number: 1 Date: 27.06.2018 Author: H.C.