



SIMATIC NET,
 DP/AS-INTERFACE LINK 20 E ;
 GATEWAY PROFIBUS-DP / AS-INTERFACE ACC. TO AS-
 INTERFACE SPEC. V3.0 IN PROTECTION MODE IP20.

General technical data:

product designation		PROFIBUS DP/AS-Interface Link
Protection class IP		IP20
Design of the electrical connection / of the AS-Interface		Screw-type connection
Type of voltage supply		via AS-i
Operating condition / separate power supply 24 V		No
[nicht versorgt: PMD_ABS773_001_000]		
<ul style="list-style-type: none"> [nicht versorgt: PMD_ABS773_001_000] with external 24 V-supply voltage / maximum 	mA	200
Resistive loss	W	4.5
Insulation voltage / rated value	V	500
Product function / adapted for AS-i Power24V		No
Product feature / redundancy capability		Yes
<ul style="list-style-type: none"> comment 		in connection with Y-Link
Product function / web-based management		No
Product function / diagnosis via E-mail		No
Product function / galvanic isolation		Yes
<ul style="list-style-type: none"> as status display by LED 		PWR, APF, CER, AUP, CM, BF, SF
Type of projection / of the AS-interface		Set pushbutton on device, STEP7, GSD, command interface

Communication:		
Version / of the AS-interface specification		V 3.0
AS-interface masterprofile / will be supported		M4 (in acc. with AS-interface specification V 3.0)
Type of data transmission		PROFIBUS
Number of interfaces		
• as AS-interface		1
• according to RS 485		1
• according to Industrial Ethernet		0
• according to PROFINET		0
• according to wireless		0
• according to USB		0
• others		1
Product component / optical interface		No
Protocol / will be supported		
• ASIsafe(Safety at work) protocol		No
• PROFIsafe protocol		No
• PROFIBUS protocol		Yes
• PROFINET IO protocol		No
• PROFINET CBA protocol		No
• TCP/IP		No
• SNMP		No
Standard for wireless communication / IEEE 802.11		No

Ein- und Ausgänge:		
Number of inputs / for AS Interface / maximum		496
Number of outputs / for AS Interface / maximum		496
Number of AS-i slaves / per AS-Interface / maximum		62
Bus cycle time / of the AS-interface		
• at 31 slaves	ms	5
• at 62 slaves	ms	10
Access to digital I/O data		via process diagram/peripheral addresses and data record transfer
Access to analog I/O data		via data record transfer

Mechanical design:		
Width	mm	90
Height	mm	80
Depth	mm	62
Type of mounting		snap-on fastening on 35 mm standard rail
Module format		IP20

Ambient conditions:

Ambient temperature

• if installed on horizontal mounting rail / during operation	°C	0 ... 60
• if installed on vertical mounting rail / during operation	°C	0 ... 45
• during transport	°C	-40 ... +70
• during storage	°C	-40 ... +70

Relative humidity / at 25 °C / during operating / maximum

% 95

Installation altitude / at a height over sea level / maximum

m 2,000

Safety:

Acceptability for application / safety-related function

No

Explosion protection labeling / for intrinsic safety of related operating resources

• EEX ia	No
• EEX ib	No

Explosion protection category for gas

none

Explosion protection category for dust

none

Certificates/approvals:

General Product Approval



Further information:

Information- and Downloadcenter (Catalogs, Brochures,...)

<http://www.siemens.com/industrial-controls/catalogs>

Industry Mall (Online ordering system)

<http://www.siemens.com/industrial-controls/mall>

Cax online generator:

<http://www.siemens.com/cax>

Service&Support (Manuals, Certificates, Characteristics, FAQs,...)

<http://support.automation.siemens.com/WW/view/en/6GK1415-2AA10/all>

Image database (product images, 2D dimension drawings, 3D models, device circuit diagrams, ...)

http://www.automation.siemens.com/bilddb/cax_en.aspx?mlfb=6GK1415-2AA10

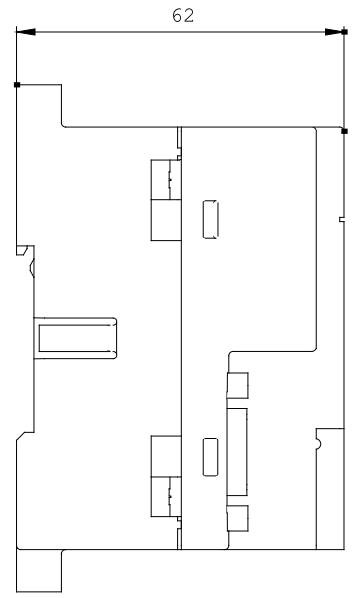
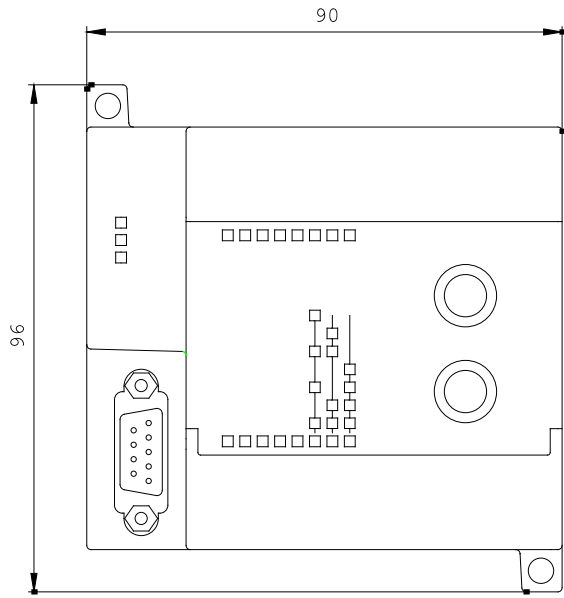

last change:

Apr 9, 2012