

Datasheet

ENGLISH

RS Pro Ceramic Tube Fuse, 40-80A, 14.6 x 22.3 mm

Stock No: 1884496,1884497,1884498,1884500

1884666,1884608,1884615,1884621



Specifications:

Materials

Tube (Body): Non-Transparent ceramic tube. Breaking or deformation is not allowed.

Two brass end caps: Made of brass of good conductivity.

Coating of brass caps: Plating the surface with nickel.

Interrupting Ratings

100,000 amperes at 170V DC

Operating Temperature

-55°C to +125°C

Drawing (mm):

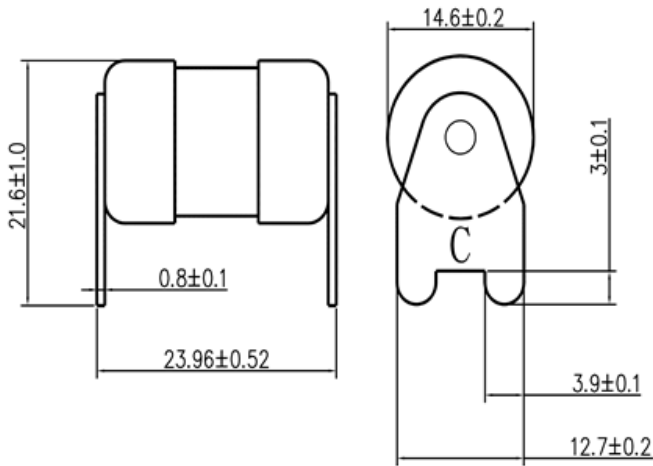

Recommend Circuit Board distance

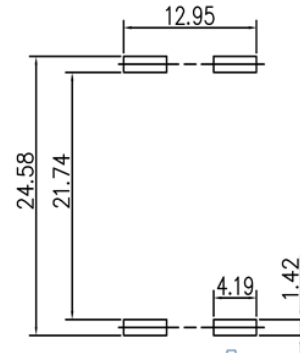

NO.	Part Name		Volume
A	Brass Cap	Nickel Plating	2
B	Ceramic Tube	Non-Transparent Ceramic Tube	1
C	Terminal	Copper (Tin plating)	2

Electrical Characteristic:

	100% Rating		135% Rating		200% Rating	
Rating	Min.	Max.	Min.	Max.	Min.	Max.
40~60A	4 Hrs			1Hrs		6min
61~80A	4 Hrs			2Hrs		8min

		Nominal Resistance	Nominal Melting I ² t
		Cold Ohms	A ² Sec
40	A	0.00156	1974
50	A	0.00123	4139
60	A	0.0009	6454
80	A	0.00074	8236

Reference:

Stock No	Rating amperes
1884496	40A 170V
1884666	40A 170V
1884497	50A 170V
1884608	50A 170V
1884498	60A 170V
1884615	60A 170V
1884500	80A 170V
1884621	80A 170V