



Fast evacuation

Decentralised vacuum generation leads to faster evacuation times and greater productivity. This is now also possible with large volumes using the vacuum generators VN. For even higher suction volumes, new nozzle sizes have been added, so that the series now covers all the nozzle sizes you need from 0.45 to 3 mm.

Greater energy efficiency!

With their low weight and minimal space requirements, these generators are ideal for installation right in the gripping zone. The advantages: Short tubing lines and faster evacuation of large volumes.

Reliable!

Secure gripping even of porous workpieces such as cartons: Thanks to their high flow rates, VN vacuum generators are better able to compensate for leakages.

Short cycle times!

Guaranteed. High vacuum with the new nozzle sizes for reliable vacuum supply with several load devices, for example applications with spider-type grippers.

Easy to install!

Via the Festo plug & work® principle, providing a holistic solution compared with vacuum pumps. No need to install a reservoir, long tubing lines or special vacuum valves.



Reliable

Directly in the gripping zone

Plug & work®

Vacuum generators VN

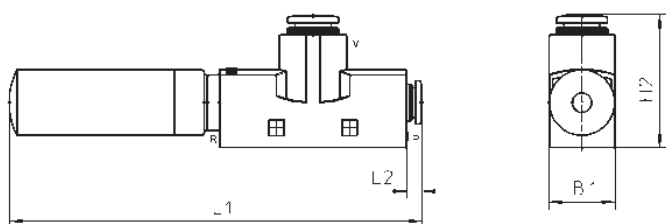

Vacuum generators Type	B1	H2	L1	L2	Silencers
VN-05-...-RO1	10	32	87	4	UO-M7
VN-05-...-RO1	14	31	98	4	UO-1/8
VN-07-...-RO1	10	32	87	4	UO-M7
VN-07-...-RO1	14	31	98	4	UO-1/8
VN-10-...-RO1	14	31	98	4	UO-1/8
VN-10-...-RO2	18	36	126	4	UOM-1/4
VN-14-...-RO1	18	36	113	4	UO-1/4
VN-14-...-RO2	18	36	126	4	UOM-1/4
VN-20/30-...-RO2	24	92	221	5	UOM-3/8

Product features:

- Block-mountable plastic housings
- Wide choice of connection variants: QS push-in fittings, screw-in threads, push-in sleeves, screw-in silencers
- Two housing types: T-shape for indirect snap-mounting onto a mounting plate, and straight form for direct installation in a tubing line
- Two operating principles: Standard and in-line (with vacuum and exhaust connections interchanged)
- Two variants in vacuum operation: For high vacuum and for high suction flow rate

System comparison

High vacuum versus high suction flow
 In the first case, the venturi nozzles are optimised to produce a high vacuum at comparatively low suction flow rates. In the second case, on the other hand, the high suction flow rates with relatively low vacuum allow very short evacuation times to be achieved.

Maintenance-free thanks to open silencers

Especially suitable for cases where there is heavy demand for vacuum and the intake air is dirty: The open silencers fitted as standard guarantee maintenance-free operation and a low noise level. Optional silencer sets can be fitted in cases where the maximum silencing effect is required.



VN-30 with open silencers



Open silencer with add-on piece

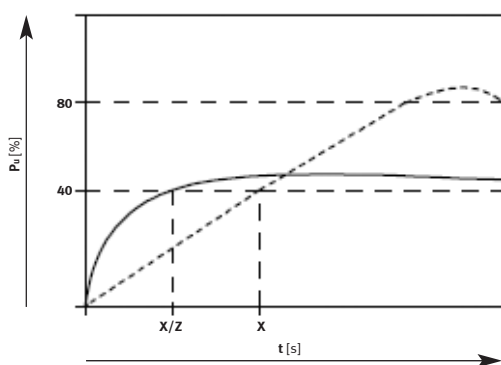

----- High vacuum
 ——— High suction flow rate

Technical data

Vacuum generators VN	
Operating medium	Dried filtered (40 μ m) unlubricated compressed air
Operating pressure [bar]	1 ... 8 (optimum 4.5 ... 6)
Ambient temperature [°C]	0 ... +60
Weight [g]	12 ... 180
Nominal venturi size [mm]	0.5/0.7/0.95/1.4/2.0/3.0
Variants	High vacuum High suction flow rate
Max. vacuum (at 6 bar)	L type: 50 %; H type: 88 %



In-line version with ESG suction cup

Festo AG & Co. KG

Ruiter Strasse 82
 73734 Esslingen
 Internet www.festo.com
 Tel. ++49 (0)711 347-0
 Fax ++49 (0)711 347-21 44
 E-mail service_international@festo.com