

RS 673-822 = JX-400A  
RS 806-533 = JS-400



8915



RS Components

---

# SUBMERSIBLE PUMP

---

## Installation and Operating Instructions

---

### Models

<b>JS(X)-60</b>	<b>Auto with Float Switch</b>
<b>JS(X)-100</b>	<b>JS(X)-100A</b>
<b>JS(X)-150</b>	<b>JS(X)-150A</b>
<b>JS(X)-250</b>	<b>JS(X)-250A</b>
<b>JS(X)-400</b>	<b>JS(X)-400A</b>
<b>JS(X)-150SV</b>	<b>JS(X)-150SVA</b>
<b>JS(X)-250SV</b>	<b>JS(X)-250SVA</b>
<b>JS(X)-400SV</b>	<b>JS(X)-400SVA</b>

---

# Installation & Operating Instructions

Range of Submersible Pumps are suited for the small to medium De-watering (or recirculating) applications.

They are extremely quiet in operation which makes them ideal for applications within residential areas for sillage pits, pool emptying, waterfalls and general drainage.

## Other ideal applications are:

Lift Wells

Car Park Sumps

Basements

Cable Pits, etc.

This Submersible Pump has been factory checked prior to delivery; however, please check for any damage during transport.

Sales and service is available from Pumps or Authorised Dealers.

## Do Not

- Lift the pump by the motor lead
- Run the pump dry
- Attempt electrical repairs
- Run the pump with the motor fully exposed for long periods
- Install the pump on soft or loose ground

## CAUTION:

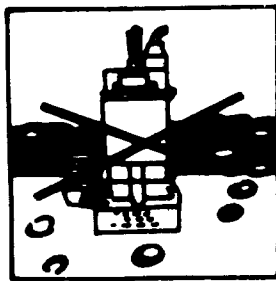

DON'T OPERATE  
IF PUMP SUBM-  
ERSED BY SAND.

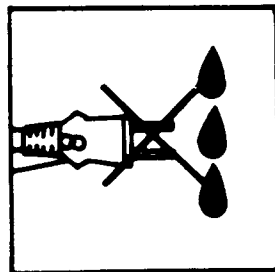

KEEP PLUG DRY.

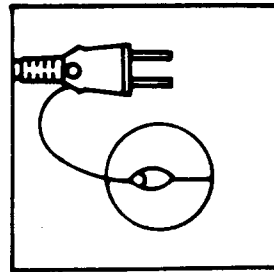

FOR SAFETY PUT  
POWER BREAKER.

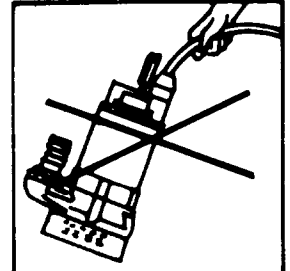

DON'T LIFT OR  
CARRY THE PUMP  
BY POWER CABLE.

## Installation

The Pump is completely submersible and should be placed on a solid flat surface (if not available sit the pump on timber or house bricks) in the vertical position. Automatic versions should be placed in a sump which has adequate dimensions so as not to restrict the movement of the float switch.

**AUTOMATIC PUMP** has been factory set to provide the correct ON-OFF switching mode. Always use the biggest diameter hose possible, a better flow is obtained and the pump will work easier. All hose can be obtained from our factory if required.

This pump is not a slurry pump, It cannot pump stones.

- \* **15TH EDITION IEE REGULATIONS. ALWAYS USE A POWER BREAKER WITH OUTSIDE ELECTRICITY. IF IN DOUBT CONSULT AN APPROVED NICEIC ELECTRICIAN.**

---

## Fault Checks

### (A) Pump will not start:

#### (1) MANUAL TYPE

- Power switched ON
- Blown fuse (consult an electrician)
- If \*extension lead fitted check connection
- Impeller jammed
- Thermal cut out switch has not reset (5 minutes)
- If pump does not start from new then the seal has possibly stuck due to the length of time it has been standing since it was manufactured. In this case, remove bottom strainer and turn the impeller nut clockwise with a pair of pliers, this will release the initial friction on the seal and once the power is connected will allow the pump to work.

#### (2) AUTO TYPE (WITH FLOAT SWITCH)

- Check all in (1) above
- Float switch jammed against sump side wall
- Insufficient liquid to place the float switch in the ON position i.e. higher than the horizontal
- \* **If fitting an extension lead a QUALIFIED ELECTRICIAN should be consulted to ensure correct rating is provided.**

If float switch is faulty a qualified electrician should replace. Float switches are available from your local Supplier.

### (B) Pump will start but does not pump:

- Insufficient liquid in sump
- Strainer blocked
- Impeller blocked
- Impeller damaged
- Entrained air present
- Excessive back pressure

### (C) Pump will not stop:

#### (1) MANUAL TYPE

- **Must be switched off at the power supply**

#### (2) AUTO TYPE (WITH FLOAT SWITCH)

- Float switch is prevented from moving to the fully down position
- Float switch may be faulty

Do not run dry as this will damage the seal and reduce the life of the pump.

With simple cleaning and regular examination this pump should give many years of service.

For a full spares and repair service on any of our pumps send pump properly packed and post paid to

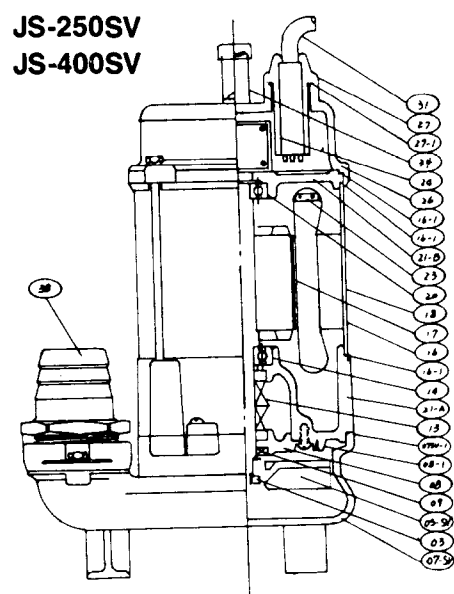
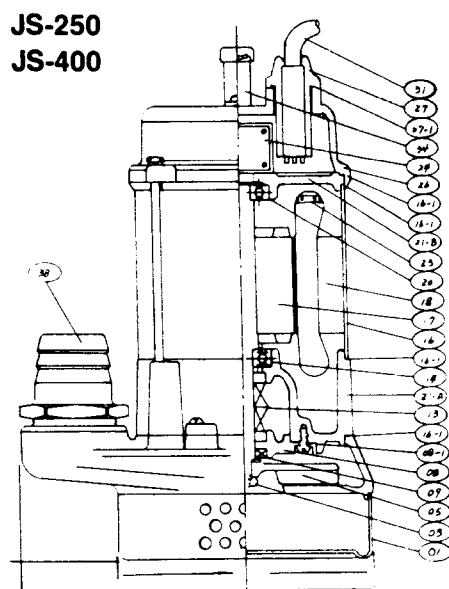
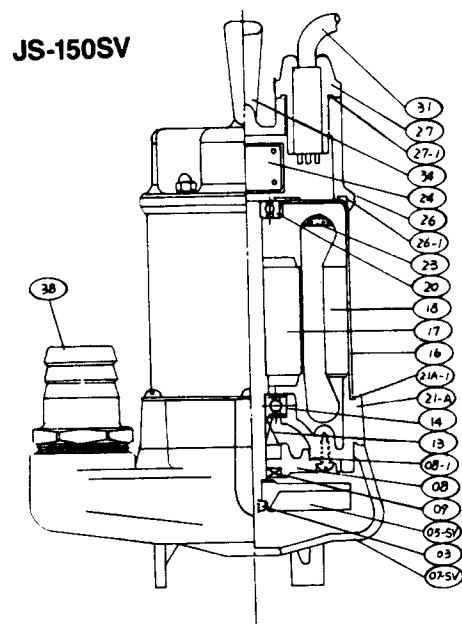
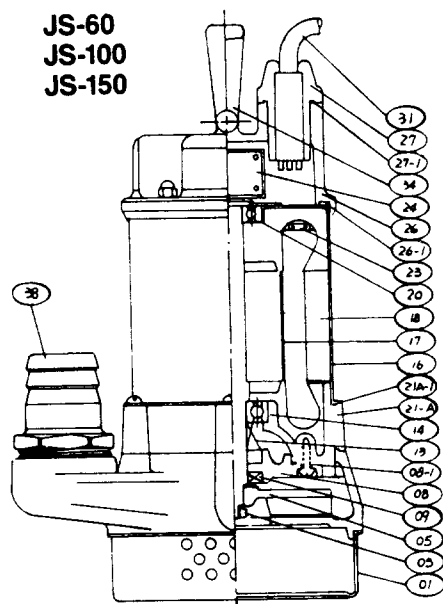

NO.	DESCRIPTION	NO.	DESCRIPTION	NO.	DESCRIPTION
01	STRAINER	16	OUTER PUMP CASING	24	CONDENSOR
03	NUT (IMPELLER)	16-1	O-RING	26	PUMP UPPER COVER
05	IMPELLER (SEMI-OPEN TYPE)	17	ROTOR SHAFT	26-1	GASKET
07	IMPELLER HOUSING	18	STATOR	27	CABLE GLAND
07-1	O-RING	20	BEARING (UPPER)	27-1	O-RING
08	OIL COVER	21B	MOTOR UPPER COVER	31	CABLE
08-1	O-RING	21B-1	O-RING	34	HANDLE
09	LIPSEAL	21B-2	O-RING	38	HOSE COUPLING
13	MECHANICAL SEAL (DOUBLE)	21-A	OIL CHAMBER HOUSING		
14	BEARING (BOTTOM)	21-A1	O-RING		

## TECHNICAL DATA:

Pump Type	Outlet Diameter	Output Watts Single Phase	Continuous		Maximum		Cable $\phi \times \text{mm}^2 \times \text{m}$	Option
			Head m	Capacity L/min	Total Head m	Max Capacity L/m.m		Auto
JX-60	1"(25)	60	3	40	5.5	65	3 × 0.75 × 3.5	
JX-100	1"(25)	100	3.5	60	7	100		JX-100A
JX-150	1¼"(32)	150	4	80	9	150		JX-150A
JX-250	1½"(40)	250	6	110	12	200	3 × 1 × 6	JX-250A
JX-400	2"(50)	400	7	130	14	240	3 × 1.25 × 6	JX-400A
→ JX-400S	2"(50)	400	3	130	8	180		JX-400S-A