



## AVR 66 SERIES

Luminaire for interior and exterior use in damp and dry conditions (IP 44). Can be used as a single unit or built into an integrated system. The base is of non-corrosive white painted aluminium. Diffuser of opal polycarbonate.



These luminaires offer a wide range of lighting solutions in residential as well as commercial locations.

## LIGHT DISTRIBUTION

431-4678  
Scale division 20 cd/klm  
 $\eta = 56\%$

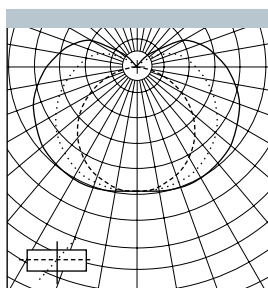

## TECHNICAL INFORMATION

Dimensions and cable entries. Cable entries are located in both ends and in the centre.

Light sources TC 11W, T15 – 58W.

Delivered with low loss ballast.

Available with electronic ballast (HF) and electronic ballast (HFD), for dimmer units, control 1 – 10V DC.

850°C IP 44 3 x 2,5 mm<sup>2</sup> 3 x 2,5 mm<sup>2</sup> + 2 x 1,5 mm<sup>2</sup>

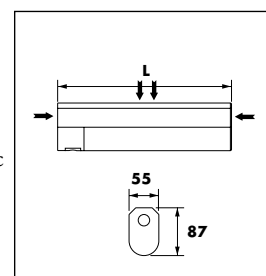

RS Stock No. Length mm Lamp Cap

( ' %4( \* \* & ..... ( + ..... % K ' H ; %  
( ' %4( \* +, ..... \* \* % ..... % K ' H ; %  
( ' %4( \* , ( ..... % & ( % ..... \* K ' H ; %

