

Angled plug socket



www.festo.com

8189918
2023-12a
[8189920]



8189918

© 2024 all rights reserved to Festo SE & Co. KG

i

All available documents for the product → www.festo.com/sp.

2.1 Safety instructions

- ## 2.2 Intended use

2.3 Training of qualified personnel

3 Additional information

- Contact the regional Festo contact if you have technical problems
➔ www.festo.com.
- Accessories and spare parts ➔ www.festo.com/catalogue.

4.1 Scope of delivery

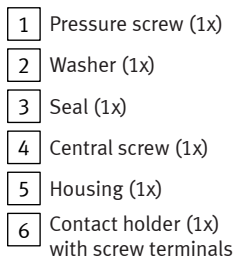

Fig.1

7 Pressure switch (1x)
PEV-1/4-A-SW27

8 Cable (1x)

Fig.2

Electrical connection 1 Field device side	Connection		Electrical connection 2 Controller side
	1	Operating voltage	1
	2	N/C contact	2
	3	Earthing	3
	4	N/O contact	4

Tab. 1: Contact assignment

6.1 Preparation

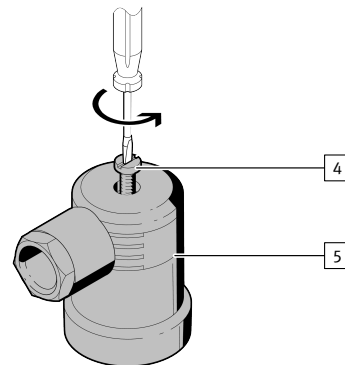

Fig.3

- Screw the central screw **4** out of the housing **5**.

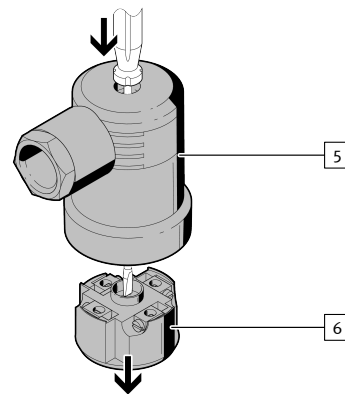

Fig.4

- Press the contact holder **[6]** out of the housing **[5]**.

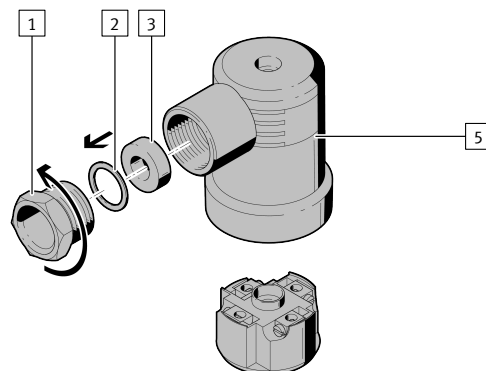

Fig.5

1. Unscrew the pressure screw **1**.
2. Remove the washer **2** and the seal **3** from the housing **5**.

6.2 Assembling

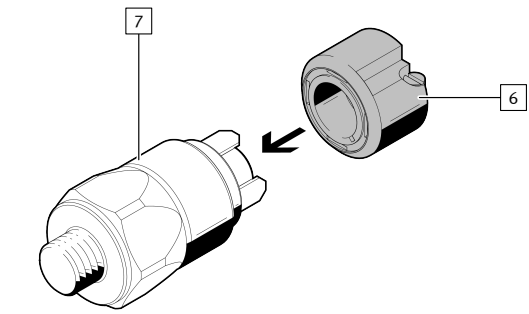

Fig.6

- Plug the contact holder [6] onto the pressure switch [7]. Note the orientation of the contacts.

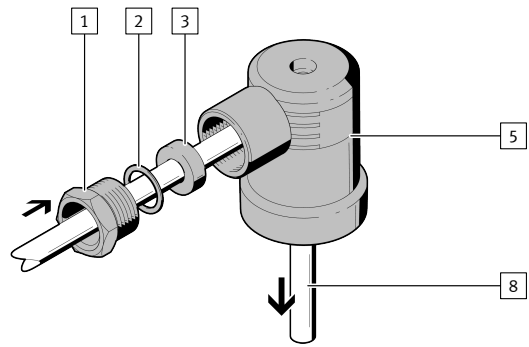

Fig.7

1. Push the pressure screw [1], the washer [2] and the seal [3] onto the cable [8].
2. Run the cable [8] through the housing [5].

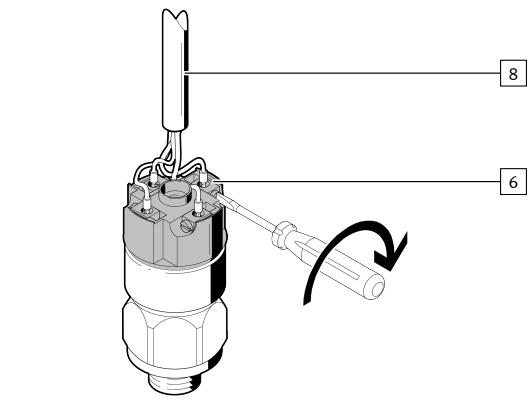

Fig.8

1. Strip the cable [8] by 40 mm.
2. Strip 5 mm of insulation from the conductors. Use wire ferrules for flexible conductors.
3. Guide the conductors into the screw terminals of the contact holder [6]. Tighten the screws of the screw terminals. Tightening torque: 0.2 Nm ± 20%

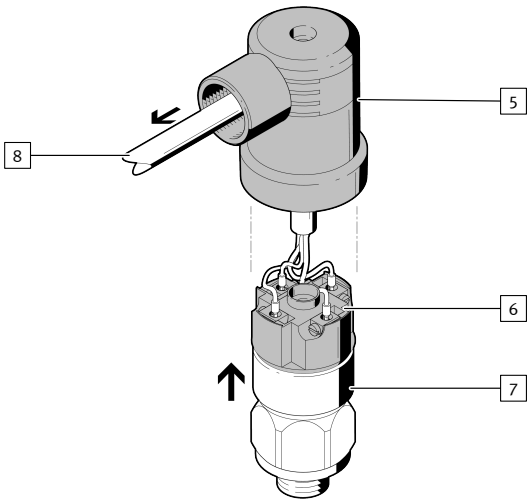

Fig.9

1. Run the cable [8] through the housing [5].
2. Do not cover the hole for the central screw.
3. Plug the housing [5] on the pressure switch [7] with the contact holder [6].

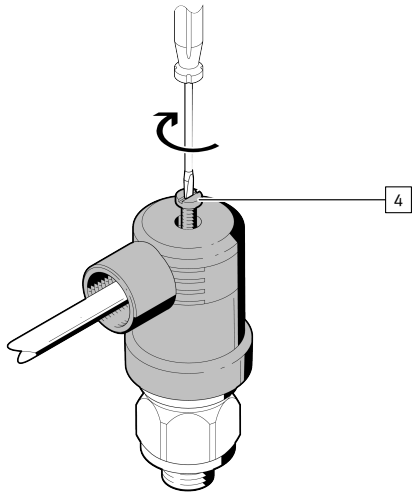

Fig.10

- Tighten the central screw [4]. Tightening torque: 0.55 Nm ± 10%

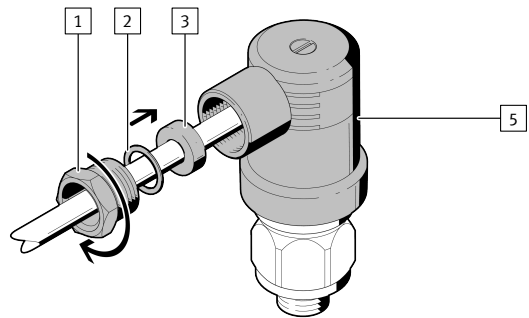

Fig.11

1. Push the seal [3], the washer [2] and the pressure screw [1] into the housing [5].
2. Tighten the pressure screw [1]. Tightening torque: 0.35 Nm ± 20%

7 Technical data

PEV-1/4-A-WD	
Certificates, declaration of conformity	➔ www.festo.com/sp
Cable diameter [mm]	4.5 ... 6.5
Cable fitting	Pg9
Operating voltage range DC [V]	250
Operating voltage range AC [V]	250
Current rating at 40 °C [A]	4
Degree of protection In assembled state	IP65
Pollution degree	3
Ambient temperature [°C]	-20 ... +100
Electrical connection 1	
Function	Field device side
Connection type	Socket
Number of pins/wires	4
Assigned pins/wires	4
Type of mounting	Central screw
Electrical connection 2	
Function	Controller side
Connection technology	Screw terminal
Connection cross section with Wire end sleeve [mm²]	0.1 ... 1.5
Number of pins/wires	4
Assigned pins/wires	4

Tab. 2: Technical data