

Features

- 300-1250 ppr. Resolution
- Incremental encoder output: Push-Pull, TTL, Linedriver or HLD output

RS PRO Motion Control Sensor Optic Rotary Incremental Encoder

Stock No.. 100482, 100483, 100485, 100430,
100431, 100481



RS Professionally Approved Products bring to you professional quality parts across all product categories. Our product range has been tested by engineers and provides a comparable quality to the leading brands without paying a premium price.

Product Description

Series designed as compact, highly robust, rotary motion control sensors, using incremental optic measuring technology, up to 5000 ppr. resolution. Series provides angular speed & displacement feedback for wide range of industrial applications.

Mechanical Specifications

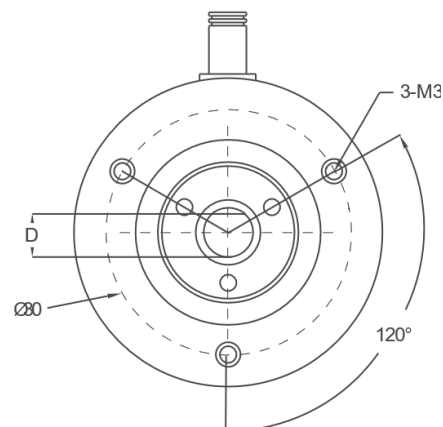
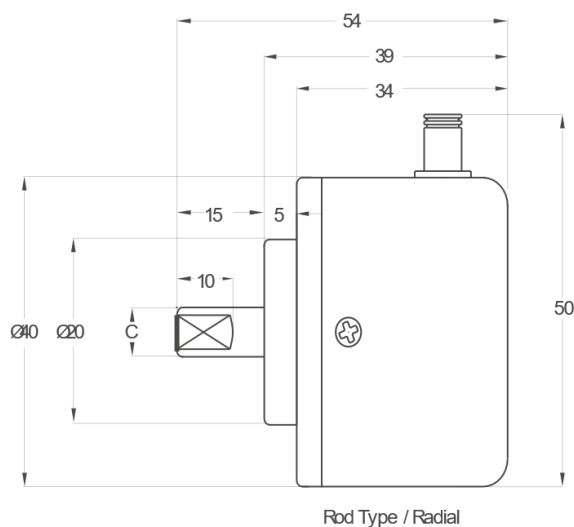

PRI 40	R (rod)	
	C	D
	Ø4mm	3.30mm
	Ø6mm	5.30mm

Push-Pull Cable Output

+V : Brown
0V : White
GND : Shield
Ch A : Yellow
Ch B : Green
Ch Z : Gray

TTL - HLD - Linedriver Cable Output

+V Brown
0V : White
GND : Shield
Ch A : Yellow
Ch B : Green
Ch Z : Gray
Ch Ainv. : Blue
Ch Binv. : Red
Ch Zinv. : Pink

General Specifications

Resolution	300-1250 ppr.
Output channels	A,B,Z or AA,BB, ZZ
Output type	TTL, Linedriver, Push-Pull, HLD
Power supply	5 VDC, 5-24 VDC or 8-24 VDC
Power consumption(without load)	<40 mA (24 VDC)
Cable	2.5 meter (standard) 5 wire + shield (Push-Pull) 2.5 meter (standard) 8 wire + shield (Linedriver)
Maximum permissible shaft loading radial	80 N
Displacement speed	3500 rpm
Rod diameter	Ø4-6 mm
Rod material	Stainless steel
Case dimension	Ø40 mm
Case material	Aluminium and painted steel
Protection level	IP 54
Operating temperature	-20°C ... +80°C
Storage temperature	-30°C ... +90°C

Approvals

Declarations	CE, UKCA, ROHS, REACH
--------------	-----------------------

Articles In Series

RS PRO Part Number	MPN	Shaft Diameter	Output	Resolution	Pover Supply	Connector / Cable
	0100482	6	High Line driver A, A', B, B' Z, Z'	1024 ppr.	8-24 VDC	2,5 meter cable
	0100483	6	Line driver A, A', B, B' Z, Z'	1000 ppr.	5 VDC	2,5 meter cable
	0100485	6	Line driver A, A', B, B' Z, Z'	1024 ppr.	5 VDC	2,5 meter cable
	0100430	6	Push Pull A, B, Z	1000 ppr.	5-24 VDC	2,5 meter cable
	0100431	6	Push Pull A, B, Z	1024 ppr.	5-24 VDC	2,5 meter cable
	0100481	6	TTL A, B, Z	1024 ppr.	5 VDC	2,5 meter cable