

**FAG****6010-RSR**

Deep groove ball bearing

Deep groove ball bearing 60...-RSR, single row, seal, steel sheet metal cage

Technical information

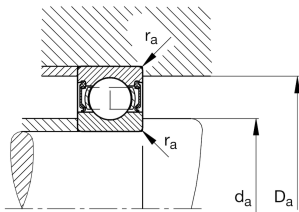
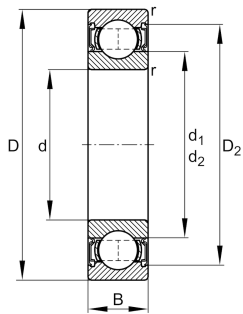

Your current product variant

Sealing	RSR	Contact seal on one side
Cage	JN	Steel sheet metal
Tolerance class	PN	Normal (PN)
Dimensional / heat stabilization	SN	Rings dimensional stabilized up to 120°
Lubricant	Without	Bearing not greased
Radial internal clearance	CN (Group N)	Normal internal clearance
Bore type	Z	Cylindrical

Main Dimensions & Performance Data

d	50 mm	Bore diameter
D	80 mm	Outside diameter
B	16 mm	Width
C _r	22,000 N	Basic dynamic load rating, radial
C _{0r}	15,800 N	Basic static load rating, radial
C _{ur}	800 N	Fatigue load limit, radial
n _G	4,450 1/min	Limiting speed
≈m	260.1 g	Weight

Mounting dimensions

d _{a min}	54.6 mm	Minimum diameter shaft shoulder
D _{a max}	75.4 mm	Maximum diameter of housing shoulder
r _{a max}	1 mm	Maximum fillet radius



Dimensions

r_{min}	1 mm	Minimum chamfer dimension
D_1	70.2 mm	Shoulder diameter outer ring
D_2	72.94 mm	Caliber diameter outer ring
d_1	59.75 mm	Shoulder diameter inner ring







Temperature range

T_{min}	-30 °C	Operating temperature min.
T_{max}	100 °C	Operating temperature max.

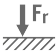
Calculation factors

f_0	15.6	Calculation factor
-------	------	--------------------

Characteristics

-  Radial load
-  Axial load in one direction
-  Axial load in two directions
-  Grease Lubrication
-  Oil Lubrication
-  Sealed on one side