

PTE 1,5/ 2-7,5 EU - PCB terminal block



1709231

<https://www.phoenixcontact.com/gb/products/1709231>

Please be informed that the data shown in this PDF document is generated from our online catalog. Please find the complete data in the user documentation. Our general terms of use for downloads are valid.



Printed circuit board terminal, number of potentials: 2, number of rows: 1, number of positions per row: 2, product range: PTE 1,5, pitch: 7.5 mm, connection method: Screw connection with tension sleeve, screw head form: L Slotted, mounting: Wave soldering, conductor/PCB connection direction: 0 °, color: black, Pin layout: Linear pinning, Solder pin [P]: 3 mm, number of solder pins per potential: 1, type of packaging: packed in cardboard. For special applications, a rated insulation voltage of 250 V at a rated surge voltage of 1 kV is also possible according to overvoltage category IV and degree of pollution 3.

Your advantages

- Well-known connection principle allows worldwide use
- Low temperature rise, thanks to maximum contact force
- Allows connection of two conductors

Commercial data

| | |
|--------------------------------------|--------------------------------|
| Item number | 1709231 |
| Packing unit | 250 pc |
| Minimum order quantity | 250 pc |
| Note | Made to order (non-returnable) |
| Sales key | AALFNA |
| Product key | AALFNA |
| GTIN | 4055626053318 |
| Weight per piece (including packing) | 4.224 g |
| Weight per piece (excluding packing) | 4.157 g |
| Customs tariff number | 85369010 |
| Country of origin | CN |

PTE 1,5/ 2-7,5 EU - PCB terminal block



1709231

<https://www.phoenixcontact.com/gb/products/1709231>

Technical data

Product properties

| | |
|---------------------------|--------------------------------|
| Product type | Printed circuit board terminal |
| Product family | PTE 1,5 |
| Product line | COMBICON Terminals S |
| Type | PC termination block |
| Number of positions | 2 |
| Pitch | 7.5 mm |
| Number of connections | 2 |
| Number of rows | 1 |
| Number of potentials | 2 |
| Pin layout | Linear pinning |
| Solder pins per potential | 1 |

Mounting

| | |
|---------------|----------------|
| Mounting type | Wave soldering |
| Pin layout | Linear pinning |

Material specifications

Material data - housing

| | |
|-----------------|--------------|
| Color (Housing) | black (9005) |
|-----------------|--------------|

Dimensions

| | |
|-----------------------|--|
| Dimensional drawing |  |
| Pitch | 7.5 mm |
| Width [w] | 13.24 mm |
| Height [h] | 16.58 mm |
| Length [l] | 13 mm |
| Installed height | 13.58 mm |
| Solder pin length [P] | 3 mm |

PCB design

| | |
|---------------|--------|
| Pin spacing | 7.5 mm |
| Hole diameter | 1.3 mm |

Environmental and real-life conditions

Ambient conditions

| | |
|---------------------------------|--|
| Ambient temperature (operation) | -40 °C (dependent on the derating curve) |
|---------------------------------|--|

PTE 1,5/ 2-7,5 EU - PCB terminal block



1709231

<https://www.phoenixcontact.com/gb/products/1709231>

| | |
|---|------------------|
| Ambient temperature (storage/transport) | -40 °C ... 70 °C |
| Ambient temperature (assembly) | -5 °C ... 100 °C |

Packaging specifications

| | |
|----------------------|---------------------|
| Type of packaging | packed in cardboard |
| Outer packaging type | Carton |

PTE 1,5/ 2-7,5 EU - PCB terminal block

1709231

<https://www.phoenixcontact.com/gb/products/1709231>

Drawings

Dimensional drawing

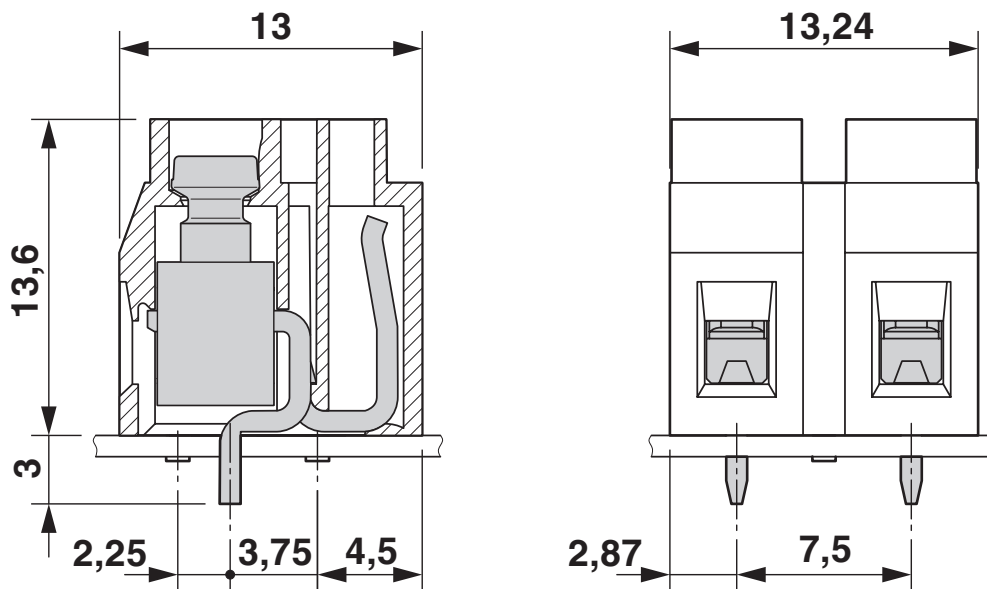

Drilling plan/solder pad geometry

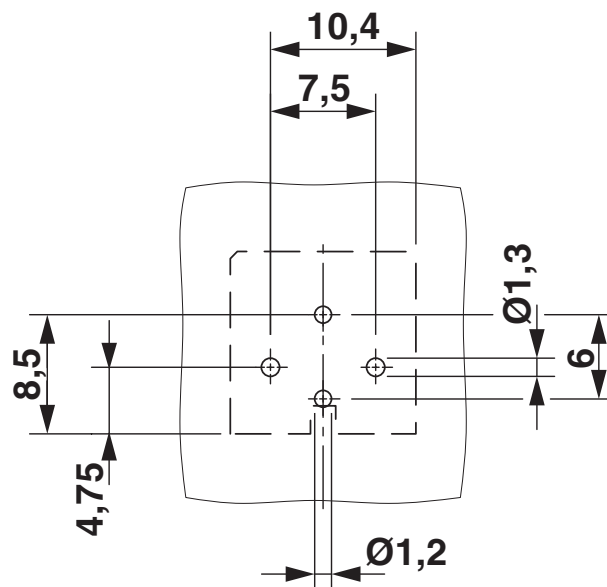

PTE 1,5/ 2-7,5 EU - PCB terminal block



1709231

<https://www.phoenixcontact.com/gb/products/1709231>

Classifications

ECLASS

| | |
|-------------|----------|
| ECLASS-13.0 | 27460101 |
|-------------|----------|

ETIM

| | |
|----------|----------|
| ETIM 9.0 | EC002643 |
|----------|----------|

UNSPSC

| | |
|-------------|----------|
| UNSPSC 21.0 | 39121400 |
|-------------|----------|

PTE 1,5/ 2-7,5 EU - PCB terminal block



1709231

<https://www.phoenixcontact.com/gb/products/1709231>

Environmental product compliance

EU RoHS

| | |
|---|--------------------|
| Fulfills EU RoHS substance requirements | Yes, No exemptions |
|---|--------------------|

China RoHS

| | |
|--|--|
| Environment friendly use period (EFUP) | EFUP-E |
| | No hazardous substances above the limits |

EU REACH SVHC

| | |
|-------------------------------------|----------------------------|
| REACH candidate substance (CAS No.) | No substance above 0.1 wt% |
|-------------------------------------|----------------------------|

Phoenix Contact 2025 © - all rights reserved
<https://www.phoenixcontact.com>

PHOENIX CONTACT Ltd
Halesfield 13, Telford
Shropshire, TF7 4PG
01952 681700
info@phoenixcontact.co.uk