



output coupler with integrated relay, 24 V DC (0.7-1.25 x Us), 1 change-over contact, spring-loaded terminal (push-in), width 6.2 mm, thermal current 6 A, (with painted APCB)

| | |
|---|---|
| product brand name | SIRIUS |
| product category | SIRIUS 3RQ4 coupling relay, narrow design |
| product designation | Coupling relay with integrated relay output |
| design of the product | output coupling link |
| product type designation | 3RQ4 |
| General technical data | |
| display version LED | Yes |
| product feature protective coating on printed-circuit board | Yes; acc. to IPC-A-610 |
| product component | |
| • relay output | Yes |
| • semi-conductor output | No |
| power loss [W] maximum | 0.3 W |
| consumed active power | 0.3 W |
| insulation voltage for overvoltage category III according to IEC 60664 with degree of pollution 3 rated value | 300 V |
| surge voltage resistance rated value | 4 kV |
| maximum permissible voltage for protective separation | |
| • between control and auxiliary circuit | 300 V |
| • between control and auxiliary circuit according to IEC 60947-1 | 300 V |
| percental drop-out voltage related to the input voltage | 14.6 % |
| flammability class of enclosure material | UL94 V-0 |
| shock resistance | |
| • for railway applications according to EN 61373 | Category 1, Class B |
| vibration resistance | |
| • for railway applications according to EN 61373 | Category 1, Class B |
| operating frequency maximum | 72 000 1/h |
| switching behavior | monostable |
| mechanical service life (operating cycles) typical | 10 000 000 |
| electrical endurance (operating cycles) | |
| • at AC-15 at 250 V typical | 100 000 |
| thermal current | 6 A; for derating see characteristics |
| reference code according to IEC 81346-2 | K |
| Substance Prohibitance (Date) | 09/26/2024 |
| Weight | 34 g |
| Control circuit/ Control | |
| control supply voltage at DC rated value | 24 V |
| operating range factor control supply voltage rated value at DC | |
| • initial value | 0.7 |
| • full-scale value | 1.25 |

| | |
|---|--|
| design of the surge suppressor at input | Varistor |
| ON-delay time | |
| • at DC maximum | 5 ms |
| OFF-delay time maximum | 10 ms |
| Switching Function | |
| design of the switching function positively driven | No |
| Digital Outputs | |
| property of the output short-circuit proof | No |
| Mechanical data | |
| product component plug-in socket | No |
| design of the relay operating mechanism | poled |
| Short-circuit protection | |
| design of the fuse link for short-circuit protection of the auxiliary switch required | fuse gG: 4 A |
| Auxiliary circuit | |
| type of switching contact | Changeover contact |
| material of switching contacts | AgSnO ₂ |
| number of CO contacts for auxiliary contacts | 1 |
| operational current of auxiliary contacts at AC-15 | |
| • at 24 V | 3 A |
| • at 250 V | 3 A |
| operational current of auxiliary contacts at DC-13 | |
| • at 24 V | 1 A |
| • at 125 V | 0.2 A |
| • at 250 V | 0.1 A |
| contact reliability of auxiliary contacts | one incorrect switching operation of 100 million switching operations (17 V, 5 mA) |
| Main circuit | |
| type of voltage | DC |
| ampacity of the output relay at AC-15 at 250 V at 50/60 Hz | 3 A |
| ampacity of the output relay at DC-13 | |
| • at 24 V | 1 A |
| • at 125 V | 0.2 A |
| • at 250 V | 0.1 A |
| Electromagnetic compatibility | |
| electromagnetic compatibility | acc. to DIN EN 50121-3-2 |
| EMC emitted interference according to IEC 60947-1 | ambience A (industrial sector) |
| EMC immunity according to IEC 60947-1 | corresponds to degree of severity 3 |
| conducted interference | |
| • due to burst according to IEC 61000-4-4 | 2 kV |
| • due to conductor-earth surge according to IEC 61000-4-5 | 2 kV |
| • due to conductor-conductor surge according to IEC 61000-4-5 | 1 kV |
| field-based interference according to IEC 61000-4-3 | 10 V/m |
| electrostatic discharge according to IEC 61000-4-2 | 6 kV contact discharge / 8 kV air discharge |
| Display | |
| display version as status display by LED | LED green |
| Safety related data | |
| B10d value | 1 200 000 |
| Connections/ Terminals | |
| product function removable terminal | No |
| type of electrical connection | |
| • for auxiliary and control circuit | spring-loaded terminals (push-in) |
| type of connectable conductor cross-sections | |
| • solid | 1x (0.25 ... 2.5 mm ²) |
| • finely stranded with core end processing | 1x (0.25 ... 1.5 mm ²) |
| • finely stranded without core end processing | 1x (0.25 ... 2.5 mm ²) |
| • for AWG cables solid | 1 x (20 ... 14) |
| • for AWG cables stranded | 1x (20 ... 14) |
| connectable conductor cross-section | |
| • solid | 0.25 ... 2.5 mm ² |

| | | |
|--|---|--------------------|
| <ul style="list-style-type: none">finely stranded with core end processing | 0.25 ... 1.5 mm² | |
| <ul style="list-style-type: none">finely stranded without core end processing | 0.25 ... 2.5 mm² | |
| AWG number as coded connectable conductor cross section | | |
| <ul style="list-style-type: none">solid | 20 ... 14 | |
| <ul style="list-style-type: none">stranded | 20 ... 14 | |
| size of the screwdriver tip | PZ1 | |
| stripped length | 10 mm | |
| Installation/ mounting/ dimensions | | |
| mounting position | any | |
| fastening method | snap-on mounting | |
| height | 93 mm | |
| width | 6.2 mm | |
| depth | 84.5 mm | |
| required spacing <ul style="list-style-type: none">with side-by-side mounting<ul style="list-style-type: none">forwardsbackwardsupwardsdownwardsat the sidefor grounded parts<ul style="list-style-type: none">forwardsbackwardsupwardsat the sidedownwardsfor live parts<ul style="list-style-type: none">forwardsbackwardsupwardsdownwardsat the side | <div>0 mm</div> <div>0 mm</div> <div>0 mm</div> <div>0 mm</div> <div>0 mm</div> <div>0 mm</div> <div>0 mm</div> <div>0 mm</div> <div>0 mm</div> <div>0 mm</div> <div>0 mm</div> <div>0 mm</div> <div>0 mm</div> <div>0 mm</div> | |
| Ambient conditions | | |
| installation altitude at height above sea level maximum | 2 000 m | |
| ambient temperature <ul style="list-style-type: none">during operationduring storageduring transport | <div>-40 ... +70 °C</div> <div>-40 ... +85 °C</div> <div>-40 ... +85 °C</div> | |
| relative humidity during operation | 10 ... 95 % | |
| Approvals Certificates | | |
| General Product Approval | other | Environment |



[Confirmation](#)



Further information

Information on the packaging

<https://support.industry.siemens.com/cs/ww/en/view/109813875>

Information- and Downloadcenter (Catalogs, Brochures,...)

<https://www.siemens.com/ic10>

Industry Mall (Online ordering system)

<https://mall.industry.siemens.com/mall/en/en/Catalog/product?mlfb=3RQ4018-2AM08-0AX0>

Cax online generator

<http://support.automation.siemens.com/WW/CAXorder/default.aspx?lang=en&mlfb=3RQ4018-2AM08-0AX0>

Service&Support (Manuals, Certificates, Characteristics, FAQs,...)

<https://support.industry.siemens.com/cs/ww/en/ps/3RQ4018-2AM08-0AX0>

Image database (product images, 2D dimension drawings, 3D models, device circuit diagrams, EPLAN macros, ...)

http://www.automation.siemens.com/bilddb/cax_de.aspx?mlfb=3RQ4018-2AM08-0AX0&lang=en

Characteristic: Derating

<https://support.industry.siemens.com/cs/ww/en/ps/3RQ4018-2AM08-0AX0/manual>

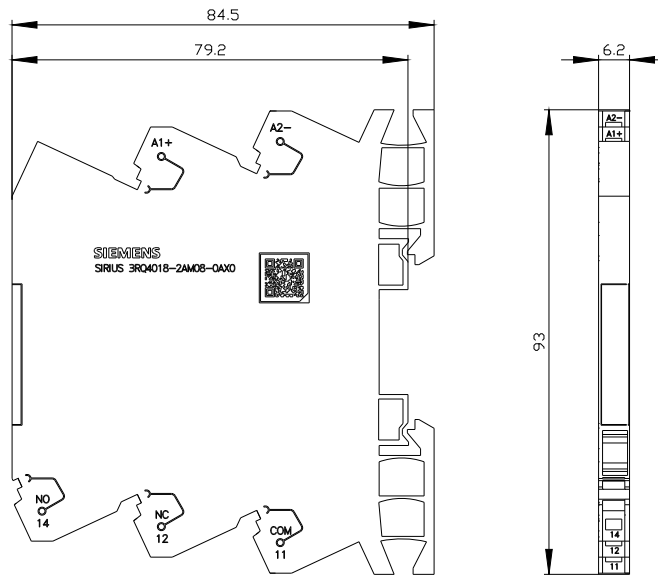

last modified:

5/16/2025 