

Data sheet Tubular cable lug, stainless steel

Available from 0,5 up to 95mm², bolt size M4 up to M12.

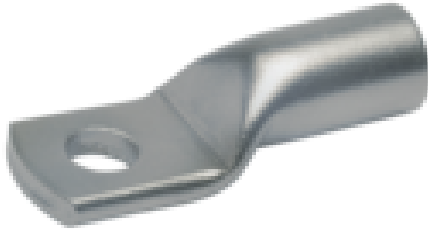
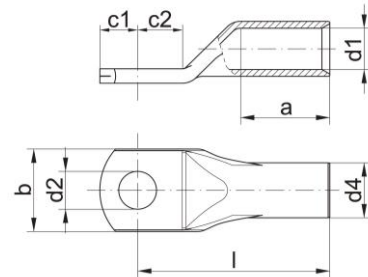

Figure similar



Drawing

A: Dimensions:

Nominal cross section mm ²	Size of bolt dia.	Part No.	Dimension mm								Weight/ 100 pcs. ~ kg	Packing unit/ pcs
			d1	a	b	c1	c2	d2	d4	l		
0.5 - 1	M4	79V44	1.6	6	6,5	4,5	4,5	4,3	3.2	13	0.080	100
1.5 - 2.5	M4	80V44	3.0	8	9.0	5	5.5	4.3	5.0	17	0.260	100
	M6	80V46	3.0	8	9.5	6.5	6.5	6.5	5.0	19	0.215	100
4 - 6	M4	81V44	4.0	9	9.0	5	5.5	4.3	6.0	18	0.260	100
	M5	81V45	4.0	9	9.5	6	6	5.5	6.0	19	0.280	100
	M6	81V46	4.0	9	10.0	7	6.5	6.5	6.0	19	0.280	100
10	M5	82V45	5.0	10	12.5	6.5	7.5	5.5	8.0	22	0.710	100
	M6	82V46	5.0	10	12.5	6.5	7.5	6.5	8.0	22	0.780	100
	M8	82V48	5.0	10	15.0	9	10	8.5	8.0	25	0.780	100
16	M5	83V45	6.0	13	12.0	5.5	6.5	5.5	8.0	28	0.500	50
	M6	83V46	6.0	13	12.0	6	7.5	6.5	8.0	28	0.550	50
	M8	83V48	6.0	13	15.0	8.5	9.5	8.5	8.0	29	0.600	50
25	M6	84V46	7.0	15	14.0	7.5	7.5	6.5	10.0	30	1.210	50
	M8	84V48	7.0	15	16.0	9	10	8.5	10.0	32	1.850	50
35	M6	85V46	9.0	17	17.0	7.5	7.5	6.5	12.0	32	1.600	50
	M8	85V48	9.0	17	17.0	10	10	8.5	12.0	35	1.850	50
50	M6	86V46	10.0	19	20.0	10	10	6.5	14.0	37	2.800	50
	M8	86V48	10.0	19	20.0	10	10	8.5	14.0	37	2.600	50
	M10	86V410	10.0	19	20.0	12	12	10.5	14.0	39	2.800	50
	M12	86V412	10.0	19	20.0	13	13	13.0	14.0	43	2.960	50
70	M8	87V48	12.0	21	23.0	10	10	8.5	16.0	43	3.650	25
	M10	87V410	12.0	21	23.0	12	12	10.5	16.0	44	3.930	25
	M12	87V412	12.0	21	23.0	13	13	13.0	16.0	46	3.850	25
	M16	87V416	12.0	21	26.0	16	16	17.0	16.0	46	3.960	25
	M12	88V412	14.0	25	26.0	13	13	13.0	18.0	49	5.540	25

B: Material specifications:

1. General

Material: M 1.4571

2. Condition

2.1 Surface

2.1.1 smooth, bright, even, no tears, scoring, folds, blisters, no other defects

2.1.2 Maximum temperature: Max. 400°C

C: Processing information:

3. Standard crimping indent dies

3.1 Series 4

3.1.1 Compatible tools

3.1.1.1 Battery hydraulic tools: EK35/4ML, EK35/4

3.1.1.2 Hand tools: K35/4

Part No.	HN446	HN410	HN416	HN4051	HN41525
Cross section mm ²	4 - 6	10	16	0,5 - 1,0	1,5 - 2,5

3.2 Series 22

3.2.1 Compatible tools

3.2.1.1 Battery hydraulic tools: EKM60/22IS, EKM60/22, EK60/22, EKM60UNV, EK60UNV

3.2.1.2 Hand hydraulic tools: HK60/22

3.2.1.3 Hand tools: K22

3.2.1.4 Hydraulic tool for workbench: THK22

Part No.	N2210	N2216	N2225	N2235	N2250
Cross section mm ²	10	16	25	35	50

3.3 Series 13

3.3.1 Compatible tools

3.3.1.1 Battery hydraulic tools: EK120/32, EK120/42, EK120UNV, EK120U, EK135FT

3.3.1.2 Hand hydraulic tools: HK120/30, HK120/42, HK120U

3.3.1.3 Crimping heads: PK120/42, PK120U

3.3.1.4 Hydraulic tool for workbench: THK120

Part No.	HN1310	HN1316	HN1325	HN1335	HN1350	HN1370	HN1395
Cross section mm ²	10	16	25	35	50	70	95

3.4 Hand tools with not interchangeable dies:

K25 0,5-6 mm²