

FEATURES

- Primary voltage rating of 2x115V ac
- Secondary voltage rating of 2x5, 2x6, 2x9, 2x12, 2x15, 2x18, 2x20 or 2x24V
- Power rating of 6 - 50VA
- Operating frequency of 50/60Hz
- Maximum temperature of 130°C
- Isolation of 4kV RMS
- Full varnish impregnation
- Low noise laminations
- Protection class IP00

RS PRO Clamp Mount Transformers – 2x115V RS Stock No: see below



RS Professionally Approved Products bring to you professional quality parts across all product categories. Our product range has been tested by engineers and provides a comparable quality to the leading brands without paying a premium price.

Product Description

The Clamp Mount Transformers 6VA to 50VA are high quality isolating transformers designed for use in general applications. Both input and output can be connected for double voltage or for double power – by series connection or parallel connection. Designed according to the following specifications.

- Low noise laminations
- Double section bobbin construction providing double or re-enforced insulation with the shrouds
- Fully shrouded bobbins
- 2-hole clamp fixing
- Solder tag terminations
- Full varnish impregnation
- Optional terminal shrouds
- Detailed product specification on permanent label
- High efficiency, low regulation design
- 100% electrical and flash tested

General Specifications

Number of Outputs	2
Output Protection Type	None. Suggested fusing according to current rating.
Applications	Electromagnetic applications, electronic and electrical control systems, relays, pumps, speed changers, heating elements

Mechanical Specifications

Mounting Type	Clamp mount
Length	45-79mm
Width	40-62mm
Depth	37 - 65mm
Weight	0.2 – 1kg

Electrical Specifications

Power Rating	6 - 50VA
Primary Voltage Rating	2x115V ac
Secondary Voltage Rating	2x5, 2x6, 2x9, 2x12, 2x15, 2x18, 2x20 or 2x24V
Isolation	4kV RMS
Temperature Class	B (70°C)

Input Data	
Rated Input Voltage	2x115V ac
Switch-On Time	100%
Minimum Operating Frequency	50Hz
Maximum Operating Frequency	60Hz

Output Data	
Rated Output Voltage	2x5, 2x6, 2x9, 2x12, 2x15, 2x18, 2x20 or 2x24V
Rated Power	6 - 50VA

Protection Category

IP Rating	IP00
------------------	------

Approvals

Declarations	MFR Declaration of Conformity
Compliance	RoHS, CE
Standards Met	IEC/BS/EN 61558-1 AS/NZS 61558.1 IEC/BS/EN 61558-2-6 AS/NZS 61558.2.6

Order Details

RS Stock number	Power VA	Specification	No-load voltage	According to
503994	6	Clamp mounting Transformer, 2x115V / 2x6V	8.0 V	IEC61558-2-6
503990	6	Clamp mounting Transformer, 2x115V / 2x9V	11.7 V	IEC61558-2-6
503984	6	Clamp mounting Transformer, 2x115V / 2x12V	15.5 V	IEC61558-2-6
503972	6	Clamp mounting Transformer, 2x115V / 2x15V	19.5 V	IEC61558-2-6
503962	6	Clamp mounting Transformer, 2x115V / 2x24V	31.8 V	IEC61558-2-6
503966	12	Clamp mounting Transformer, 2x115V / 2x6V	6.85 V	IEC61558-2-6
503978	12	Clamp mounting Transformer, 2x115V / 2x9V	10.35 V	IEC61558-2-6
503988	12	Clamp mounting Transformer, 2x115V / 2x12V	13.6 V	IEC61558-2-6
504284	12	Clamp mounting Transformer, 2x115V / 2x15V	17.3 V	IEC61558-2-6
504268	12	Clamp mounting Transformer, 2x115V / 2x24V	27.2 V	IEC61558-2-6
504278	20	Clamp mounting Transformer, 2x115V / 2x6V	6.95 V	IEC61558-2-6
504274	20	Clamp mounting Transformer, 2x115V / 2x9V	10.35 V	IEC61558-2-6
504280	20	Clamp mounting Transformer, 2x115V / 2x12V	13.9 V	IEC61558-2-6
504262	20	Clamp mounting Transformer, 2x115V / 2x15V	17.5 V	IEC61558-2-6
504230	20	Clamp mounting Transformer, 2x115V / 2x24V	27.8 V	IEC61558-2-6
504240	50	Clamp mounting Transformer, 2x115V / 2x6V	6.6 V	IEC61558-2-6
504246	50	Clamp mounting Transformer, 2x115V / 2x9V	10.0 V	IEC61558-2-6
504256	50	Clamp mounting Transformer, 2x115V / 2x12V	13.3 V	IEC61558-2-6
504252	50	Clamp mounting Transformer, 2x115V / 2x15V	16.7 V	IEC61558-2-6
504329	50	Clamp mounting Transformer, 2x115V / 2x24V	26.7 V	IEC61558-2-6

Mechanical Drawings

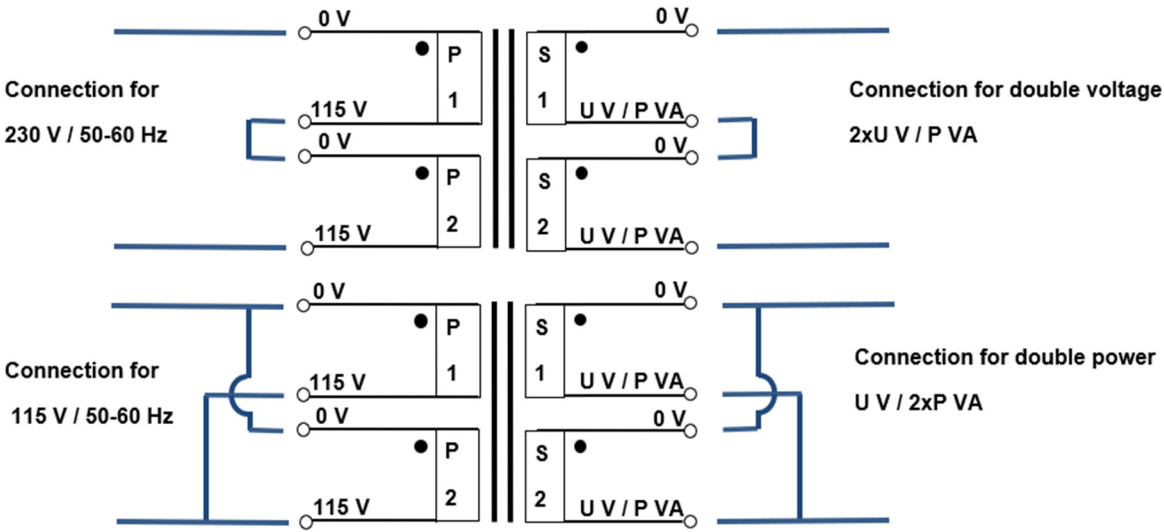
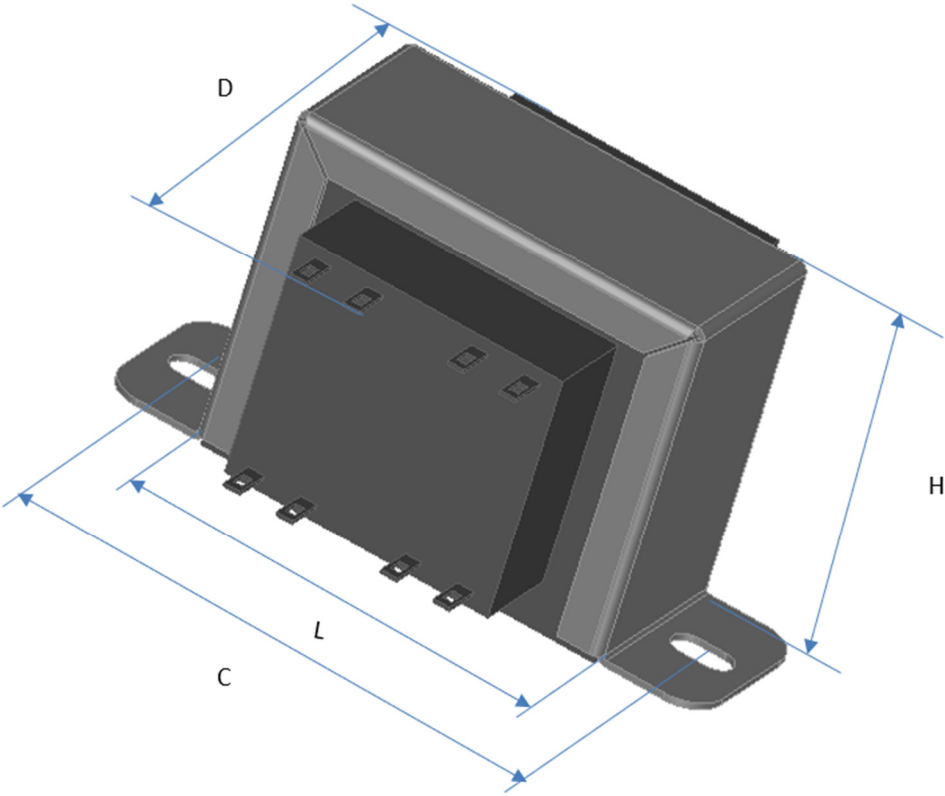

Subject to errors and changes in data sheets. D4586177

Power	Overall Size	Fixing		Weight	Efficiency
[VA]	L x D x H [mm]	C [mm]	Slot size	[kg]	%
6	45 x 40 x 37	53.5	4 x 5.5	0.20	> 80 %
12	59 x 50 x 50	70	4.7x8.7	0.4	>87%
20	59x57x50	70	4.7x8.7	0.55	> 80 %
50	79x62x65	92	4.7x9.5	1.0	>84%

Safety precautions: **Never touch the primary side unless not connected to the mains.**

Do not mix primary side and secondary side connections.

For 115V always use both primary windings in parallel.