

MATERIALS AND FINISHES

BODY BRASS
PLATED GOLD

CENTER CONTACT BERYLLIUM COPPER
PLATED GOLD

INSULATOR TEFLON

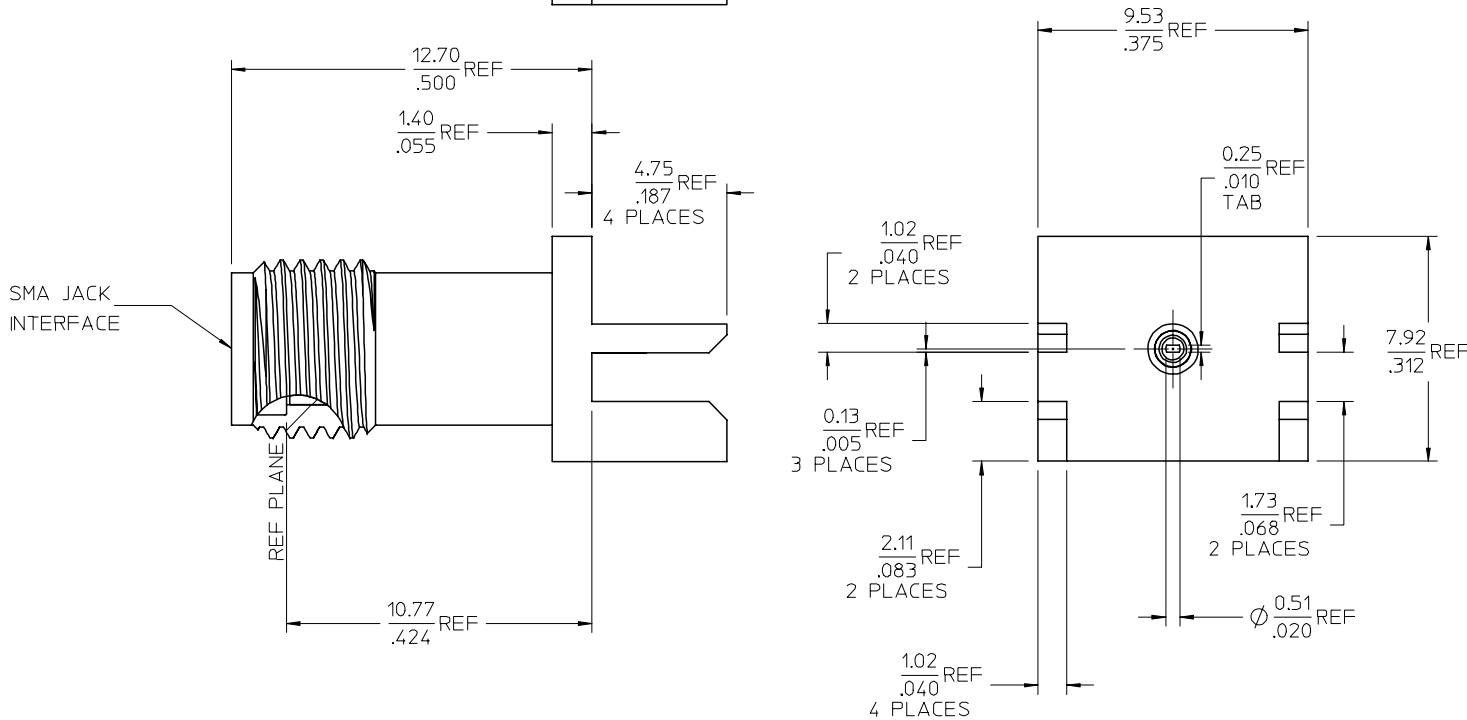
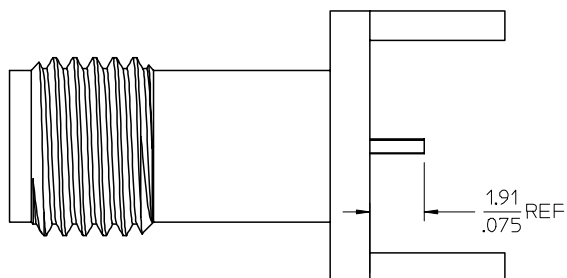
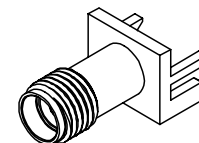

PS-89675-2820	PRODUCT SPECIFICATION
MIL-STD-348A, FIG. 310.2	INTERFACE
SPECIFICATION	DESCRIPTION

73251-0621	73251-0620, ONE PER BAG
73251-0620	BULK
PART NO.	PACKAGING

CHG: REDRAWN TO SHOW REVISED COMPONENTS
 EC NO: URF2008-0025
 DRAWN: FLAHERTY 2007/07/13
 CHKD: SHAH 2007/07/13
 APPR: JIMENER 2007/07/13
 A2

QUALITY SYMBOLS

GENERAL TOLERANCES (UNLESS SPECIFIED)	
mm	INCH
4 PLACES ± .005	± .0004
3 PLACES ± .008	± .0005
2 PLACES ± .010	± .0006
1 PLACE ± .015	± .0008

DIMENSION STYLE	
MM/IN	SCALE
DRAWN BY: GMH	DATE: 1998/10/13
CHECKED BY:	DATE:
APPROVED BY:	DATE:

THIRD ANGLE PROJECTION
SMA JACK, EDGE MOUNT
50 OHMS, EWR-3335
SMA-JR
MOLEX INCORPORATED

DRAFT WHERE APPLICABLE MUST REMAIN WITHIN DIMENSIONS

MATERIAL NO.	DOCUMENT NO.	SHEET NO.
SEE TABLE	SD-73251-062	1 OF 1