

KOOLBREEZE

Koolmist 300

Evaporative Misting Fan Cooler

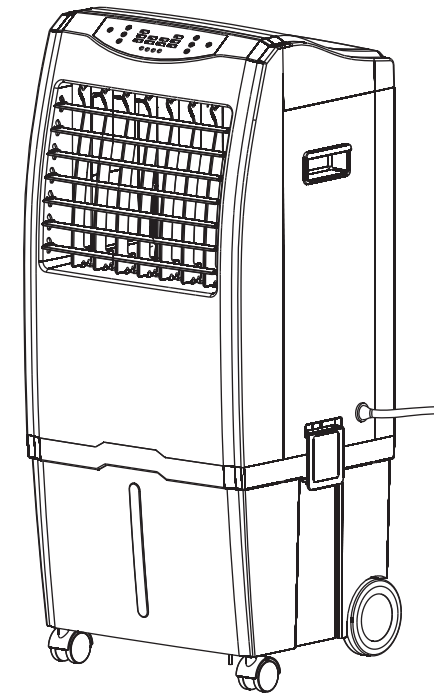

MODEL KME300

Keep these instructions for future reference

In the event of a warranty claim you should
in the first instance apply to
the Retailer from whom you purchased the unit

Imported by:

Koolbreeze
Cottage Stores LLP
7 Harris Drive Rugby CV22 6DX
United Kingdom

Table of Contents

Product Features	1
Description of parts	2
Operation Instruction	2
Circuit Diagram	5
Technical Parameters	5
Maintenance and Cleaning	5
Trouble Shooting	6

Thank you for purchasing our air cooler. Please read all the instructions in detail before first time use, to ensure proper use of the unit. Also, please keep the manual for future reference.

Product Features

- **Cool**
Provides refreshing cool air by blowing micro droplets of cold water into the room using a powerful yet quiet fan
- **Humidifier**
Humidifies the air to avoid dryness
- **Ionizer**
It releases negative ions to freshen the air
- **Detachable construction, easy to clean**
The main body and water tank are detachable, easy to clean.
- **Wide angle application**
Wide angle effect, comfortable and all-around. 3 fan speeds: HIGH-MID-LOW
- **Remote Control**
Remote control , 120 angle wide range receiver
- **Protect function**
when not enough water in water tank, the water pump will stop working automatically.
- **Energy saving, high-efficiency, friendly environment**

Safety Caution

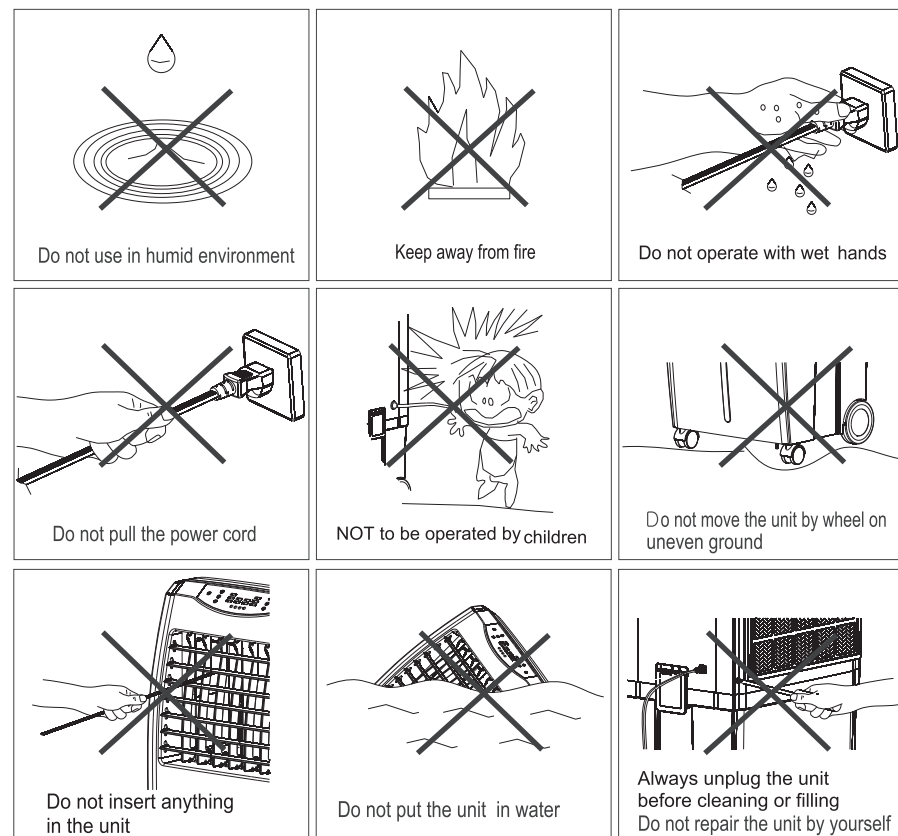

Trouble Shooting

Problems	Solutions
No power	Check the plug and make sure the voltage is applicable
Cool or humidity function not working	Check water tank if the water is enough
Small tweet from water tank	Water in water tank is not enough, add water or switch off "cool" function
Water spilt from vent	Check the cooling pad, make sure it is assembled properly
Air not circulating	Activate louvres

◆ Instruction for remote control

You can operate the unit by remote control:

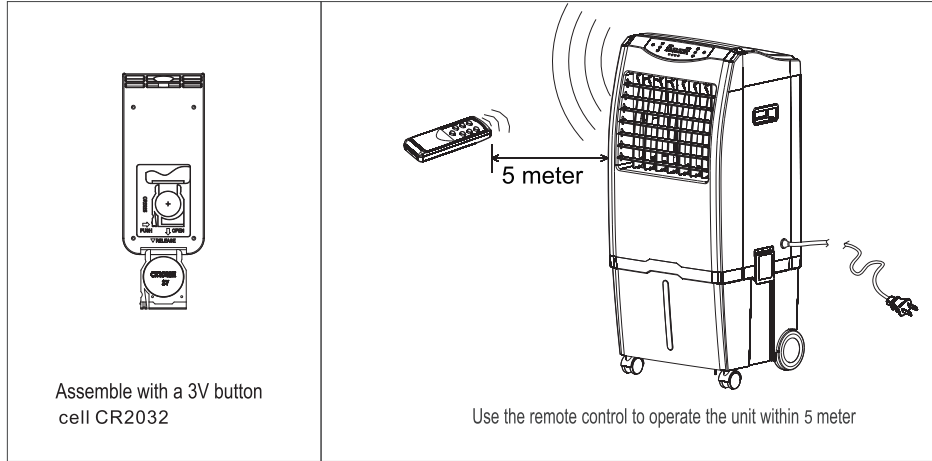

Circuit Diagram

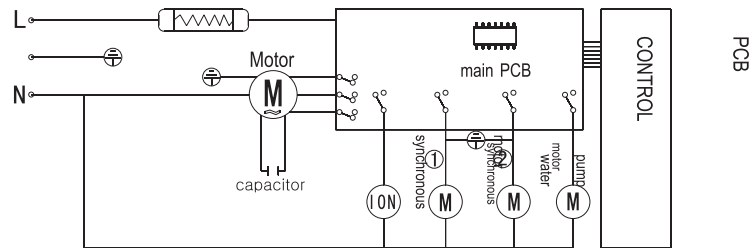

Technical Parameters

Model	Rated voltage	Power	water tank	Air Flow
KME300	220V/50Hz	130 W	20L	1132.56 m ³ /Hr

Maintenance and Cleaning

- ◆ Before cleaning, be sure to pull the plug out from socket.
- ◆ Wipe the machine with half-dry cloth, don't flush the machine by water.
- ◆ Please refer "water tank dismounting and assembling instruction" to dismounting and clean water tank.
- ◆ Please refer "Dismounting and assembling instruction for paper cooling pad" to dismounting and clean paper cooling pad

Description of parts

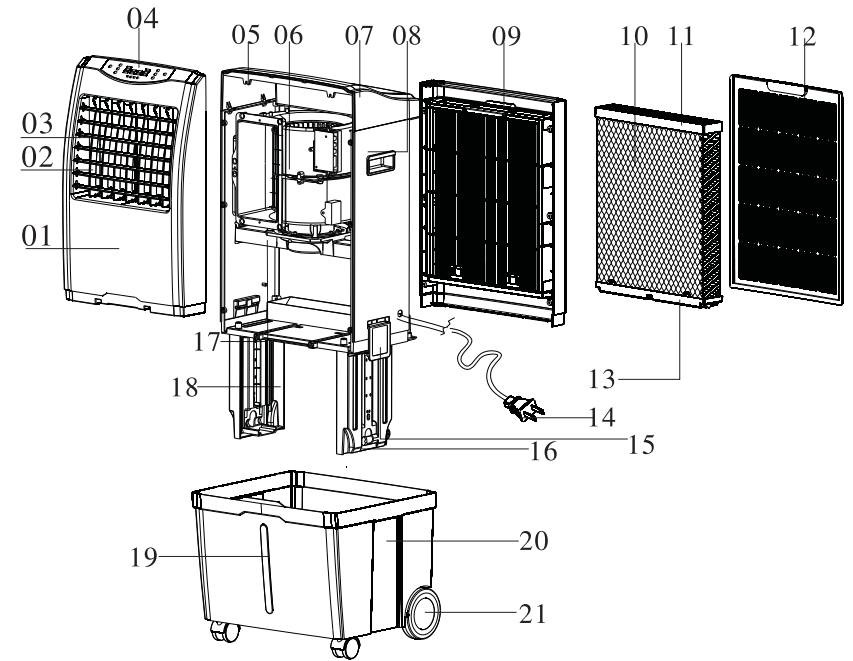

- 01: Front cover
- 02: Transverse swing louvres
- 03: Vertical swing louvres
- 04: Control Panel
- 05: Top cover
- 06: Wind rotor
- 07: Water chamber cover
- 08: Side cover
- 09: Back cover
- 10: Paper cooling pad
- 11: top cover for cooling pad
- 12: Air rair filter
- 13: Bottom cover for cooling pad
- 14: Power cord
- 15: Buckle of water tank
- 16: water pump
- 17: Motor
- 18: Bracket for water pump
- 19: Water level indicator
- 20: Water tank
- 21: Castor

Operation Instruction



Please check below information before start using the unit.

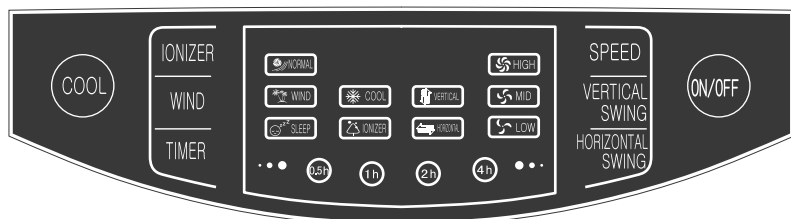

Read all the information on page 6 of this manual, ensure the unit is on a flat surface and:



- ◆ Paper cooling pad and rear air filter are assembled in the unit.
- ◆ Rating voltage on the rating label is correct
- ◆ There is no damage on the power cord.





Insert the plug into a socket. A small "beep" indicates the unit is ready in standby



ON/OFF Press once and the unit will start working. The Low fan light  and "standard wind" light  will both come on. Press ON/OFF again to turn off the unit.





SPEED Press this button to select desired fan speed, "LOW" "MID" "HIGH", in turn.    Each option will light in turn.

SWING Press "HORIZONTAL SWING" button to make horizontal louvers move; up and down. Press this button again to fix the air direction.  will light. Press "VERTICAL SWING" button to make vertical swing louvers move; left and right. Press this button again to fix the air direction.  will light.

COOL Press once only to start the evaporative cooling function.  will light. Press this button again to switch off this cooling function. before using this function, please make sure the water tank has enough water.

IONIZER Press this button to switch on ionizer function.  will light. Press this button again to switch off this function.

WIND Press this button to select desired wind mode. NORMAL wind, NATURE wind, SLEEP wind,    Each option will light in turn. Normal provides constant air. Nature is Gusts of wind and sleep reduces in intensity over time.

TIMER The unit has 7.5 hours timer function, press 0.5h, 1h, 2h, 4h button to choose timing time.     will light on correspondently.

3. Operation instruction for removable parts.(Be sure the plug is pulled out from socket.)

- ◆ Water tank
You can remove the water tank and clean it: clean monthly and before storage

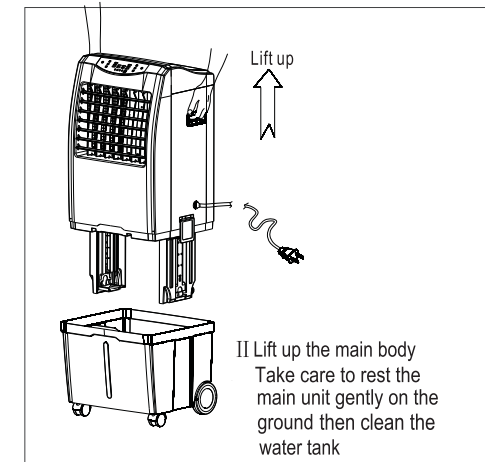
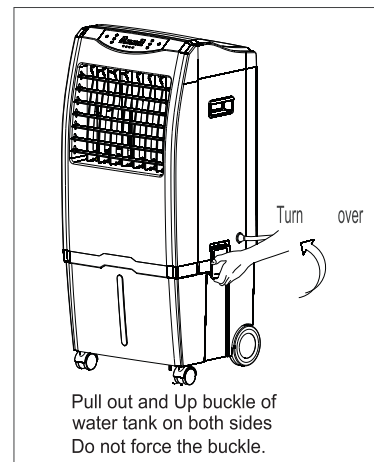

- ◆ Paper Cooling pad
You can remove the paper cooling pad and clean.

