

(THM) THRU HOLE MOUNT TEST POINTS - COLOR KEYED

- Color keyed for visibility and quick identification
- Economical choice for PC test point terminations
- Snap-fit mounting provides positive retention for wave soldering
- Wire form loop for safe, non-slip testing
- Space saving, ultra low and low profile designs
- High profile design for difficult to reach applications
- Suitable for high density packaging on .062 (1.57) and .093 (2.36) PC boards
- Practical replacement for wire-wrap posts and turrets
- Secure grip for J hooks, EZ hooks, grabbers, alligator clips, tips or probes
- High temperature nylon base ideal for reflow soldering
- Ideal for reliable production testing and field service troubleshooting



COLOR KEYED

MINIATURE

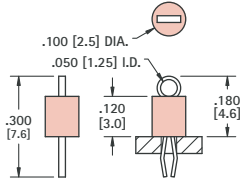

SPECIFICATIONS

Terminal:
 .010 (.25) x .020 (.51) Phosphor Bronze,
 Silver Plate
Base: Nylon 46, UL Rated 94V-0
Mtg. Hole: .040 (1.0) Diameter

CAT. NO.	BASE COLOR	CAT. NO.	BASE COLOR
5000	RED	5115	BROWN
5001	BLACK	5116	GREEN
5002	WHITE	5117	BLUE
5003	ORANGE	5118	GREY
5004	YELLOW	5119	PURPLE

COMPACT

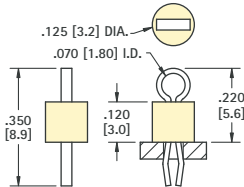

SPECIFICATIONS

Terminal:
 .015 (.38) x .032 (.81) Phosphor Bronze,
 Silver Plate
Base: Nylon 46, UL Rated 94V-0
Mtg. Hole: .063 (1.6) Diameter

CAT. NO.	BASE COLOR	CAT. NO.	BASE COLOR
5005	RED	5120	BROWN
5006	BLACK	5121	GREEN
5007	WHITE	5122	BLUE
5008	ORANGE	5123	GREY
5009	YELLOW	5124	PURPLE

MULTIPURPOSE

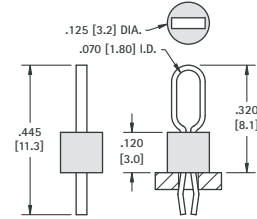

SPECIFICATIONS

Terminal:
 .015 (.38) x .032 (.81) Phosphor Bronze,
 Silver Plate
Base: Nylon 46, UL Rated 94V-0
Mtg. Hole: .063 (1.6) Diameter

CAT. NO.	BASE COLOR	CAT. NO.	BASE COLOR
5010	RED	5125	BROWN
5011	BLACK	5126	GREEN
5012	WHITE	5127	BLUE
5013	ORANGE	5128	GREY
5014	YELLOW	5129	PURPLE

ULTRA LOW PROFILE

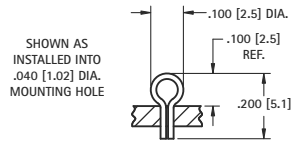

MATERIAL: .017 (.43) Dia.
 Phosphor Bronze Silver plate
Mtg Hole: .040 (1.0)

CAT. NO. 5021

LOW PROFILE

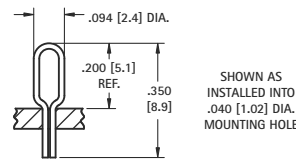

MATERIAL: .016 (.40) x .028 (.71)
 Phosphor Bronze Silver plate
Mtg Hole: .040 (1.0)

CAT. NO. 5020

STANDARD

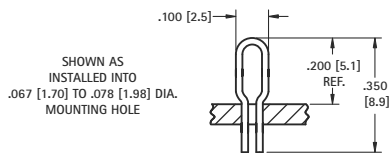

MATERIAL: .020 (.50) Dia.
 Phosphor Bronze Silver plate
Mtg Hole: .073 (1.85)

CAT. NO. 5023

LARGE

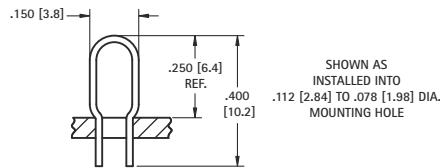

MATERIAL: .020 (.50) Dia.
 Phosphor Bronze Silver plate
Mtg Hole: .114 (2.9)

CAT. NO. 5024

JUMPERS

.100 SPACING

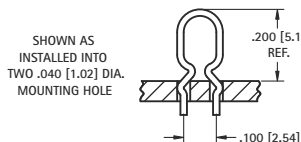

Mounting Detail

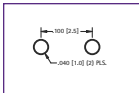

MATERIAL: .020 (.50) Dia.
 Phosphor Bronze Silver plate
Mtg Hole: .040 (1.0)

CAT. NO. 5025

.200 SPACING

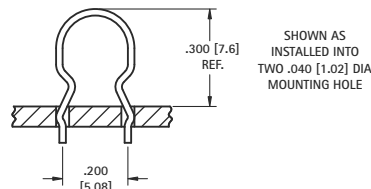

Mounting Detail

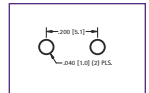

MATERIAL: .016 (.40) x .028 (.71)
 Phosphor Bronze Silver plate
Mtg Hole: .040 (1.0)

CAT. NO. 5026