

E

D

A

C

B

DO NOT SCALE DRAWING

EC NO. DRWN: CHK: APPR:	EC NO. DRWN: CHK: APPR:	EC NO. DRWN: CHK: APPR:	EC NO. DRWN: CHK: APPR:	EC NO. DRWN: CHK: APPR:	REDRAWN EC NO. JC2000-0629 DRWN: K.KOHAMA 000 3/28 CHK: T.YAMAGUCHI 000 3/30 APPR: M.FUKUSHIMA 000 3/30
INS. RANGE 被覆外径	WIRE RANGE 適用電線範囲	FINISH 仕上げ	DESCRIPTION	MATERIAL 材料	REVISION
—//—	—//—	—//—	—//—	ナイロン66, 94V-0 NYLON66,94V-0 色: オフホワイト COLOR:OFF WHITE	REV

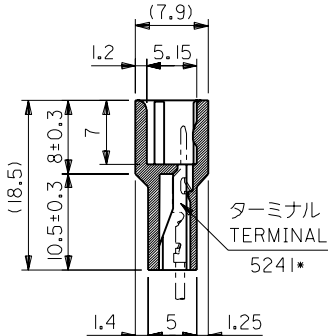
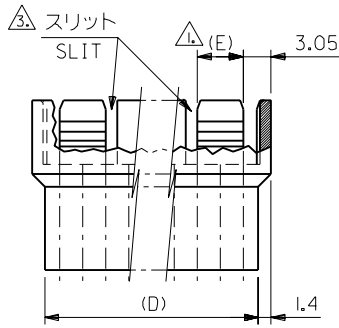
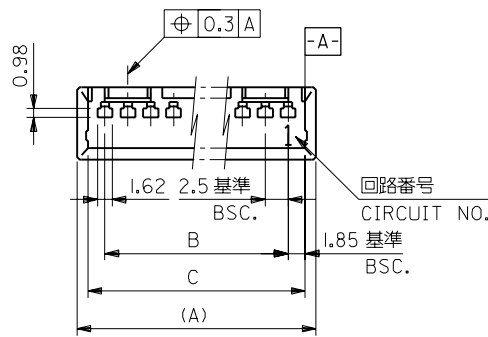

注)  
NOTE.

フリクションロック構成:  
FRICTION LOCK CONFIGURATION:  
4極までは1箇所  
4CKT AND UNDER - 1LOCK  
5極以上は2箇所  
5CKT AND OVER - 2LOCKS

2. 嵌合相手: 5102-N  
MATES WITH HOUSING: 5102-N

スリット構成:  
SLIT CONFIGURATION:  
4極以下はなし  
4CKT AND UNDER - NO SLIT  
5及び6極は1箇所  
5 AND 6CKTS - 1 SLIT  
7極以上は2箇所  
7CKT AND OVER - 2 SLITS

29-11-0153	5240-151	35	38.7	41.1	5	38.3		15
-0143	-141	32.5	36.2	38.6	5	35.8		14
-0133	-131	30	33.7	36.1	5	33.3		13
-0123	-121	27.5	31.2	33.6	5	30.8		12
-0113	-111	25	28.7	31.1	5	28.3		11
-0103	-101	22.5	26.2	28.6	5	25.8		10
-0093	-091	20	23.7	26.1	5	23.3		9
-0083	-081	17.5	21.2	23.6	5	20.8		8
-0073	-071	15	18.7	21.1	5	18.3		7
-0063	-061	12.5	16.2	18.6	5	15.8		6
-0053	-051	10	13.7	16.1	3.75	13.3		5
-0043	-041	7.5	11.2	13.6	7.5	10.8		4
-0033	-031	5	8.7	11.1	5	8.3		3
29-11-0023	5240-021	2.5	6.2	8.6	2.5	5.8		2
EDP.NO.	ENG.NO.	B	C	(A)	(E)	(D)	極数	CKT.

SCALE 2:1	DESIGN UNITS <input checked="" type="checkbox"/> mm <input type="checkbox"/> INCH	THIRD ANGLE PROJECTION	TITLE: MINI. SPOX PLUG HSG.	SHT REV
DRAWN BY & DATE K.KOHAMA 000/ 3/28	CHECKED BY & DATE T.YAMAGUCHI 000/ 3/30	APPROVED BY & DATE M.FUKUSHIMA 000/ 3/30	CAD FILENAME S5240.S01	MATERIAL NO. 5240-***I
10 UNDER 未満	10 OVER 以上	30 UNDER 未満	30 OVER 以上	ANGLE 角度
±0.2	±0.25	±0.3	±3°	
THIS DRAWING CONTAINS INFORMATION THAT IS PROPRIETARY TO MOLEX INCORPORATED AND SHOULD NOT BE USED WITHOUT WRITTEN PERMISSION.				SIZE B

5240.S01