

DIRECT SOLENOID VALVE SV32C

DESCRIPTION

3/2 Way solenoid valves are available as single station units. Standard valve is normally closed and comes with one plug.

MAIN FEATURES

Port size: 1/4"
Fluid: compressed air (filtered through 40 microns filter elements)
Sectional area: 1,5mm²
Operating: Inner spring return
Max. pressure: 10 bar
Temperature range: -10 °C to 60 °C
Coil type: DIN
Protection: IP65 (DIN 40 050)
Standard voltage: 220VAC, 24 VDC, 24 VAC

BODY MATERIAL

Aluminium alloy

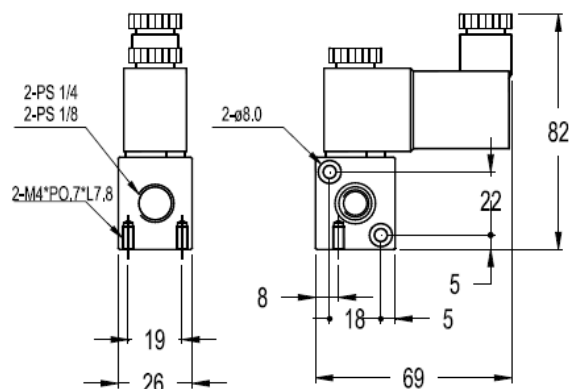

D-LUX DIGITAL TIMERS

SPECIFICATIONS	
TIMER	
Interval time	0,5 - 45 minutes
Discharge time	0,5 - 10 seconds
Supply voltage	240 V (24V on request)
Current consumption	4 mA Max.
Operating temperature	-40°C to +60°C
Environmental protection	IP 65
Housing material	ABS Plastic FR grade
Connection	DIN 43650A ISO 4400/6952
Indicators	1LED (yellow) to indicate on phase
	1LED (yellow) to indicate off phase

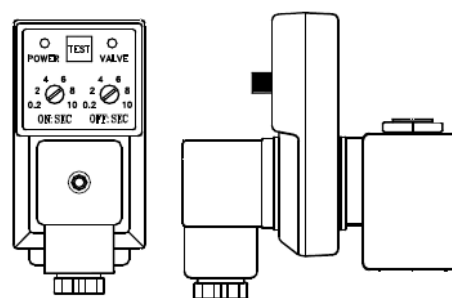

NOTE : SEE DATA SHEET REFERENCE 'IMI.2.145.E.09.13' FOR FURTHER INFORMATION