



Image may differ from product. See technical specification for details.

FRB 13.5/200

Locating (stabilizing) ring

A bearing in the locating position must be secured axially in the housing. If the bearing seat in the housing and the bearing width do not match, locating (stabilizing) rings are required. Typically, two locating rings are required per housing. One ring should be placed on each side of the bearing. If only one locating ring is required, it should be installed on the same side as the lock nut.

Overview

Dimensions

| | |
|------------------|---------|
| Outside diameter | 200 mm |
| Inside diameter | 187 mm |
| Width | 13.5 mm |

Properties

| | |
|----------------|---------------|
| Accessory type | Locating ring |
|----------------|---------------|

Logistics

| | |
|--------------------|-------------|
| Product net weight | 0.266 kg |
| eClass code | 23-05-17-90 |
| UNSPSC code | 31171519 |

Technical specification

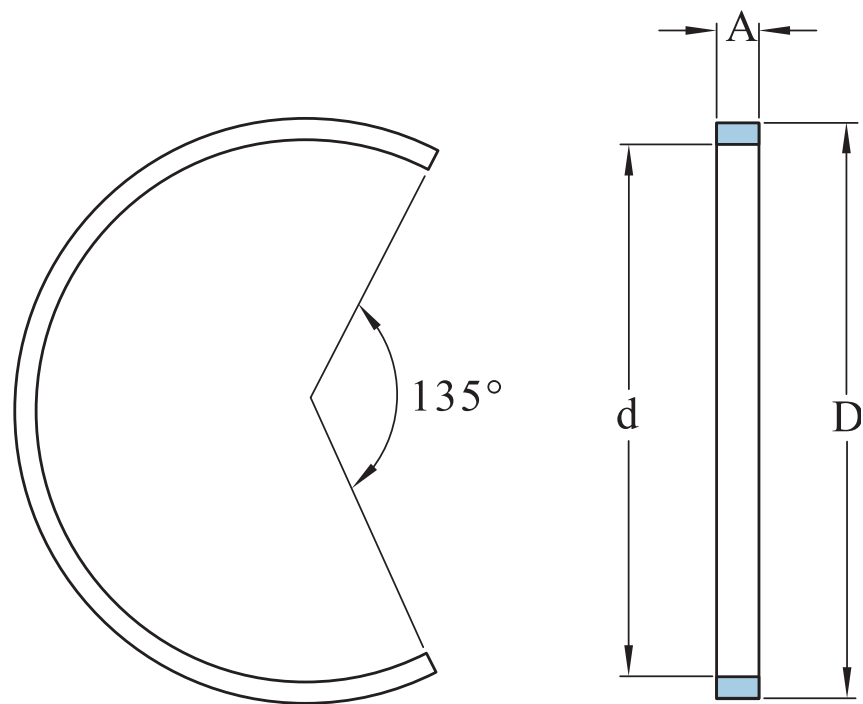

Dimensions

| | | |
|---|---------|------------------|
| D | 200 mm | Outside diameter |
| d | 187 mm | Inside diameter |
| A | 13.5 mm | Width |



Terms of use