

RASEY90-XL

Plummer block housing unit

Plummer block housing units RASEY, cast iron housing, radial insert ball bearing with grub screws in inner ring, R seals

X-life

Technical information

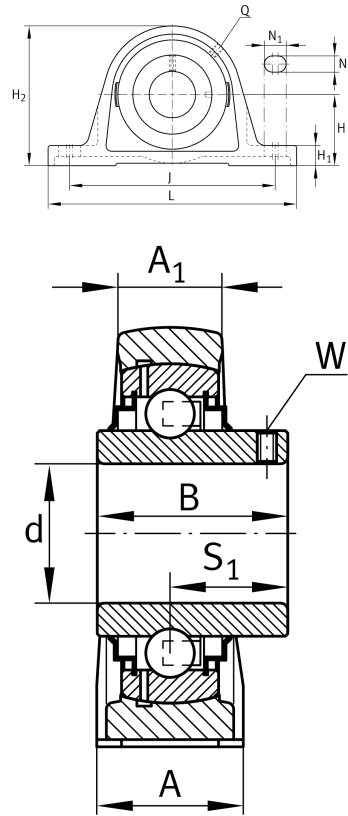

Your current product variant

Material	GG	Grey cast iron
----------	----	----------------

Main Dimensions & Performance Data

d	90 mm	Bore diameter
L	330 mm	Length total
H 2	200 mm	Height
≈m	12.39 kg	Weight

Mounting dimensions

J	268 mm	Distance fixing bore
N	27 mm	Width (slot)
N 1	35 mm	Length (slot)

Dimensions

H	101.6 mm	Distance shaft axis
A	85 mm	Width (base)
A 1	55 mm	Width (head)
H 1	35 mm	Heigth (base)
B	96 mm	Width
S 1	56.3 mm	Distance of raceway to locking collar
Q	M6	Connection thread for lubrication



Additional information

ASE18	Housing
GYE90-XL-KRR-B	Bearing designation

Temperature range

T _{min}	-20 °C	Operating temperature min.
T _{max}	100 °C	Operating temperature max.