

**TECHNICAL DATA // Series 1007**

Standard-Test Probe 50 mil / 1.27 mm

**HIGHLIGHTS**

Universal field of application

Compact design

Short travel

Contacting of assembled PCBs

**MECHANICAL DATA**

Center	1.27 mm/50 mil
Full travel	2.80 mm
Working travel	2.40 mm
Pre-loaded spring force	0.25/ 0.25/ 0.40 N
Spring force at working travel	0.70/ 1.00/ 1.70 N
Temperature range	-30 °C - +120 °C

**ELECTRICAL DATA**

Continuous current	3.0 A
Typical continuity resistance	<= 30 mOhm

**MATERIALS**

Barrel	Bronze, gold-plated
Plunger	Steel, CuBe, gold-plated
Receptacle	Bronze, gold-plated

**RECOMMENDED DIAMETER OF DRILL**

HP 2361.1 / EP CP 201 (trolitax)	0.86 mm
With pressed-in ring	0.93 mm
HGW 2372 (glass filled material)	0.88 mm
With pressed-in ring	0.94 mm



# TECHNICAL DATA // Series 1007

Standard-Test Probe 50 mil / 1.27 mm

## TIP STYLE - DIAMETER - PLATING



A  
0.90 Au



B  
0.49C Au

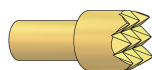

C  
0.90C Au  
1.50 Au



D  
0.49 Au

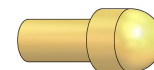

D  
0.85C Au



G  
0.49C LF

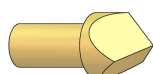

H  
0.90 Au  
1.50 Au

1007

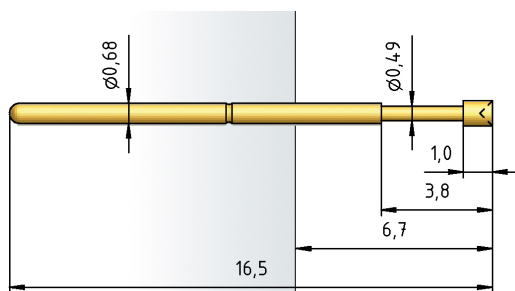

1007  
(for Tip Style  
C / H)

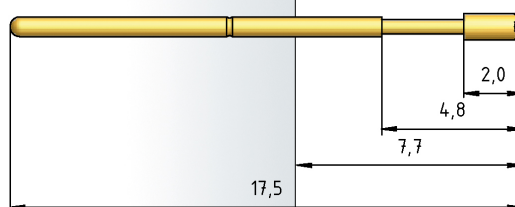

H 1007 C

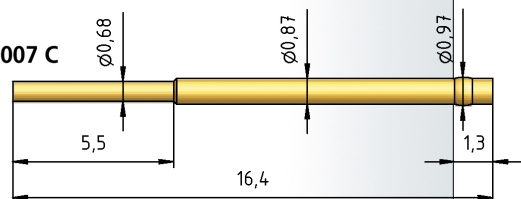

H 1007 L





**PTR HARTMANN**

A Phoenix Mecano Company

## TECHNICAL DATA // Series 1007

Standard-Test Probe 50 mil / 1.27 mm

### HOW TO ORDER

<u>1007</u>	-	<u>A</u>	-	<u>0.7 N</u>	-	<u>Au</u>	-	<u>0.9</u>	<u>C</u>
1		2		3		4		5	6

1. Series 2. Tip Style 3. Spring Force  
4. Tip Plating 5. Tip Diameter 6. Tip Material (only for CuBe)