

# Datasheet

## Hydraulic Quick Couplings

### Zinc-plated, Yellow Chromate Steel

Hydraulic Quick Couplings that enable the fluid flow to be shut off instantly in order to prevent hydraulic fluid leakage. O-ring seals the plug surface to prevent further leakage.

#### Technical Features

- NBR O-ring seals
- Stainless Steel balls
- Double shut-off
- Interchangeable with FASTER ANV Series, STUCCHI BIR Series, INTERTRACO A Series, SAFEWAY S565, HANSEN HA 15000 (GROMELLE)
- Operating temperature range: -25 to +125°C



**Female Self-Sealing Coupler**  
– (e.g. 745-4704)



**Male Self-Sealing Coupler**  
– (e.g. 745-4700)

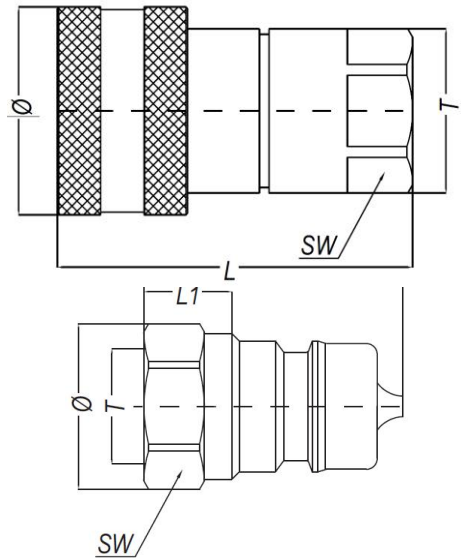

#### Dimensions

RS Article No.	Type	Description	Connection 'T' (in.)	Diameter (mm)	Hex. 'SW' (mm)	Length 'L' (mm)	'L1' (mm)
745-4704	FEMALE	1/4in BSP Female Self-Sealing Coupler	G 1/4	25	19mm	48	N/A
745-4716	FEMALE	3/8in BSP Female Self-Sealing Coupler	G 3/8	31	22mm	57	N/A
745-4693	FEMALE	1/2in BSP Female Self-Sealing Coupler	G1/2	38	27mm	66	N/A
745-4697	FEMALE	3/4in BSP Female Self-Sealing Coupler	G 3/4	48	34mm	82.5	N/A
745-4729	FEMALE	1in BSP Female Self-Sealing Coupler	G 1	56	41mm	100	N/A
745-4700	MALE	1/4in BSP Male Self-Sealing Coupler	G 1/4	22	19mm	38.6	14.5
745-4722	MALE	3/8in BSP Male Self-Sealing Coupler	G 3/8	26.5	23mm	39	18
745-4710	MALE	1/2in BSP Male Self-Sealing Coupler	G 1/2	31	27mm	44	22
745-4707	MALE	3/4in BSP Male Self-Sealing Coupler	G 3/4	40	35mm	55	27.5
745-4713	MALE	1in BSP Male Self-Sealing Coupler	G 1	47	41mm	66	34