

Features

- In accordance with ISO6432 standard
- Version without cushioning
- Working temperature - 10°C ÷ +80°C
- Working pressure 1-10 bar

RS PRO Pneumatic Piston Rod Cylinder

RS PRO 0360718



RS PRO is the own brand of RS. The RS PRO Seal of Approval is your assurance of professional quality, a guarantee that every part is rigorously tested, inspected, and audited against demanding standards. Making RS PRO the Smart Choice for our customers.

Product Description

- Compact and efficient solutions for industrial applications
- These pneumatic cylinders comply with international standards, delivering reliable performance in tight spaces.
- Designed to meet the stringent ISO 6432 standard, they ensure uniformity and seamless system integration.
- Despite their compact size, they offer significant power, making them ideal for applications that require precision and force in confined industrial environments.

General Specifications

Manufacturer Series	RS PRO FDNM
Action	Double Acting

Mechanical Specifications

Stroke	See table below for more details
Bore	See table below for more details
Length	See table below for more details
Piston Rod Thread Gender	Male
Maximum Operating Pressure	10 bar
Working Pressure Range	1-10 bar
Working Temperature	-10 °C ÷ +80 °C
Absolute Maximum Pressure	12 bar
Cushioning Type	Elastomer plate
Pneumatic Connection	See table below for more details
Diameter	See table below for more details
Port Connection	See table below for more details
Width	See table below for more details
Height	See table below for more details
Dimensions	See table below for more details

Approvals

Declarations	MFR Declaration of Conformity
Standards Met	ISO6432

Products within this series

Stock No.	Bore (mm)	Stroke (mm)	Length (mm)	Height (mm)	Width (mm)	Diameter (mm)	Pneumatic Connect. (Port Connection)
0360718	10	25	111	17	17	10	M5
0360720	16	10	121	22	22	16	M5
0360722	25	50	187	29	29	25	1/8"
0360723	25	80	217	29	29	25	1/8"
0360724	25	100	237	29	29	25	1/8"

Drawings / Dimensions / Internal Structure / Materials

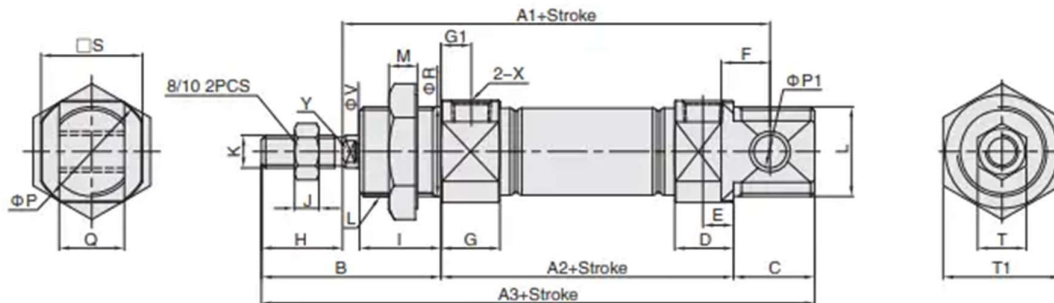

Stock No.	Bore	A1	A2	A3	B	C	D	E	F	G	G1	H	I	J	K	L	M	P	P1	R	T	T1	S	Q	V	X	Y
0360718	10	64	46	86	28	12	9.5	5.2	6	11.5	7	12	12	3	M4x1.25	M12x1.25	7	17	4	12	7	17	15	8	4	M5x0.8	-
0360720	16	82	56	111	38	17	10.5	5.5	9	12.5	7	16	17	5	M6x1.0	M16x1.5	6	22	6	16	10	22	20	12	6	M5x0.8	5
0360722	25	104	65	137	50	22	16	8	12	16	8	22	22	6	M10x1.25	M22x1.5	7	33.5	8	22	17	29	30	16	10	1/8"	8
0360723	25	104	65	137	50	22	16	8	12	16	8	22	22	6	M10x1.25	M22x1.5	7	33.5	8	22	17	29	30	16	10	1/8"	8
0360724	25	104	65	137	50	22	16	8	12	16	8	22	22	6	M10x1.25	M22x1.5	7	33.5	8	22	17	29	30	16	10	1/8"	8