

# PHE L110NR

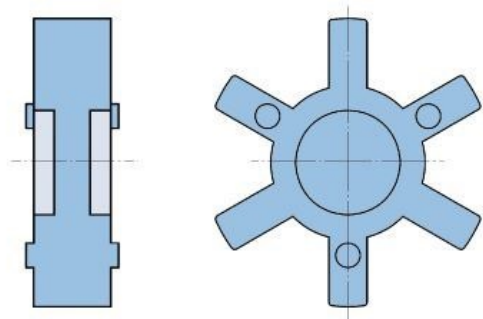

|                            |            |
|----------------------------|------------|
| Size                       | 110        |
| Nominal torque (Nm)        | 105        |
| Nominal torque (lbft)      | 77.44      |
| Speed Max. (r/min)         | 5000       |
| Weight                     | 0.06       |
| Weight (lbs)               | 0.13       |
| Temperature range (°C)     | -40 to 100 |
| Angular misalignment (°)   | 1          |
| Parallel misalignment (mm) | 0.38       |
| Parallel misalignment (in) | 0.01       |