

Self-Lube[®] bearing inserts 1000G and 1100 Series

1000G

With spherical outside diameter and integral set screw lock

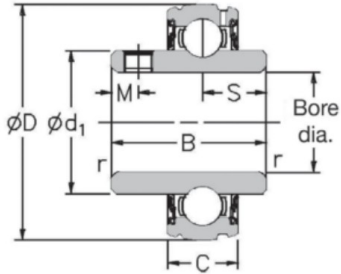

1100

With parallel outside diameter and integral set screw lock

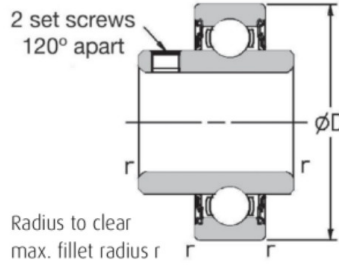

Shaft diameter		RHP designation		Dimensions (mm)						ISO Load ratings		Rec. max. speed	Mass (approx.)	
mm	inches	1000G Series	1100 Series	D	C	B	s	d1	M	r	dynamic Cr newtons	static Cor newtons	rev/min	kg
12		1017-12G	1117-12	40.000	12.00	27.38	11.58	24.80	5.00	0.60	9550	4800	7000	0.09
15		1017-15G	1117-15											
16		1017-16G	1117-16											
17		1017-17G	1117-17											
	1/2	1017-1/2G	1117-1/2											
	5/8	1017-5/8G	1117-5/8											
20		1020-20G	1120-20	47.000	14.00	31.00	12.73	28.30	5.00	1.00	12800	6650	6700	0.13
	3/4	1020-3/4G	1120-3/4											
25		1025-25G	1125-25	52.000	15.00	34.10	14.33	34.00	5.00	1.00	14000	7880	6250	0.17
	7/8	1025-7/8G	1125-7/8											
	1 1/16	1025-1 1/16G	1125-1 1/16											
	1	1025-1G	1125-1											
25		1030-25G	1130-25	62.000	16.00	38.10	15.93	40.30	5.00	1.00	19500	11300	5300	0.37
30		1030-30G	1130-30											
	1	1030-1G	1130-1											
	1 1/8	1030-1 1/8G	1130-1 1/8											
	1 3/16	1030-1 3/16G	1130-1 3/16											
	1 1/4	1030-1 1/4G	1130-1 1/4											
30		1035-30G	1135-30	72.000	17.00	42.90	17.53	46.90	6.50	1.00	25700	15300	4500	0.51
35		1035-35G	1135-35											
	1 3/16	1035-1 3/16G	1135-1 3/16											
	1 1/4	1035-1 1/4G	1135-1 1/4											
	1 5/16	1035-1 5/16G	1135-1 5/16											
	1 3/8	1035-1 3/8G	1135-1 3/8											
	1 7/16	1035-1 7/16G	1135-1 7/16											
35		1040-35G	1140-35	80.000	18.00	49.20	19.03	52.40	8.00	1.00	32500	19900	4000	0.64
40		1040-40G	1140-40											
	1 3/8	1040-1 3/8G	1140-1 3/8											
	1 7/16	1040-1 7/16G	1140-1 7/16											
	1 1/2	1040-1 1/2G	1140-1 1/2											
40		1045-40G	1145-40	85.000	19.00	49.20	19.04	57.40	8.00	1.00	32500	20500	3700	0.73
45		1045-45G	1145-45											
	1 1/2	1045-1 1/2G	1145-1 1/2											
	1 5/8	1045-1 5/8G	1145-1 5/8											
	1 11/16	1045-1 11/16G	1145-1 11/16											
	1 3/4	1045-1 3/4G	1145-1 3/4											
45		1050-45G	1150-45	90.000	20.00	51.60	19.04	62.40	10.00	1.00	35000	23200	3400	0.91
50		1050-50G	1150-50											
	1 11/16	1050-1 11/16G	1150-1 11/16											
	1 3/4	1050-1 3/4G	1150-1 3/4											
	1 7/8	1050-1 7/8G	1150-1 7/8											
	1 15/16	1050-1 15/16G	1150-1 15/16											
	2	1050-2G	1150-2											
50		1055-50G	1155-50	100.000	21.00	55.60	22.24	68.90	10.00	1.50	43500	29200	3100	1.12
55		1055-55G	1155-55											
	1 7/8	1055-1 7/8G	1155-1 7/8											
	1 15/16	1055-1 15/16G	1155-1 15/16											
	2	1055-2G	1155-2											
	2 1/8	1055-2 1/8G	1155-2 1/8											
	2 3/16	1055-2 3/16G	1155-2 3/16											

Please check availability

Shaft diameter		RHP designation		Dimensions (mm)						ISO Load ratings		Rec. max. speed	Mass (approx.)	
mm	inches	1000G Series	1100 Series	D	C	B	s	d1	M	r	dynamic Cr newtons	static Cor newtons	rev/min	kg
55		1060-55G	1160-55	110.000	22.00	65.10	25.44	76.00	10.00	1.50	48000	33000	2800	1.47
60		1060-60G	1160-60											
	2 ³ / ₁₆	1060-2 ³ / ₁₆ G	1160-2 ³ / ₁₆											
	2 ¹ / ₄	1060-2 ¹ / ₄ G	1160-2 ¹ / ₄											
	2 ³ / ₈	1060-2 ³ / ₈ G	1160-2 ³ / ₈											
	2 ⁷ / ₁₆	1060-2 ⁷ / ₁₆ G	1160-2 ⁷ / ₁₆											
60		1065-60G	1165-60	120.000	23.00	65.10	25.44	82.50	10.00	1.50	57500	40000	2600	2.02
65		1065-65G	1165-65											
	2 ¹ / ₂	1065-2 ¹ / ₂ G	1165-2 ¹ / ₂											
60		1070-60G	1170-60	125.000	24.00	74.60	30.24	89.00	12.00	1.50	61000	45000	2450	2.27
65		1070-65G	1170-65											
70		1070-70G	1170-70											
	2 ⁷ / ₁₆	1070-2 ⁷ / ₁₆ G	1170-2 ⁷ / ₁₆											
	2 ¹ / ₂	1070-2 ¹ / ₂ G	1170-2 ¹ / ₂											
	2 ⁵ / ₈	1070-2 ⁵ / ₈ G	1170-2 ⁵ / ₈											
	2 ¹¹ / ₁₆	1070-2 ¹¹ / ₁₆ G	1170-2 ¹¹ / ₁₆											
65		1075-65G	1175-65	130.000	25.00	77.80	33.34	94.00	12.00	1.50	66000	49500	2300	2.61
70		1075-70G	1175-70											
75		1075-75G	1175-75											
	2 ¹¹ / ₁₆	1075-2 ¹¹ / ₁₆ G	1175-2 ¹¹ / ₁₆											
	2 ³ / ₄	1075-2 ³ / ₄ G	1175-2 ³ / ₄											
	2 ⁷ / ₈	1075-2 ⁷ / ₈ G	1175-2 ⁷ / ₈											
	2 ¹⁵ / ₁₆	1075-2 ¹⁵ / ₁₆ G	1175-2 ¹⁵ / ₁₆											
	3	1075-3G	1175-3											
75		1080-75G	1180-75	140.000	26.00	82.60	33.34	100.00	12.00	2.00	71500	54500	2150	3.23
80		1080-80G	1180-80											
	2 ¹⁵ / ₁₆	1080-2 ¹⁵ / ₁₆ G	1180-2 ¹⁵ / ₁₆											
	3	1080-3G	1180-3											
	3 ³ / ₁₆	1080-3 ³ / ₁₆ G	1180-3 ³ / ₁₆											
	3 ¹ / ₄	1080-3 ¹ / ₄ G	1180-3 ¹ / ₄											
80		1085-80G	1185-80	150.000	28.00	85.70	34.15	107.10	12.00	2.00	83000	64000	2000	3.74
85		1085-85G	1185-85											
	3 ³ / ₁₆	1085-3 ³ / ₁₆ G	1185-3 ³ / ₁₆											
	3 ¹ / ₄	1085-3 ¹ / ₄ G	1185-3 ¹ / ₄											
	3 ³ / ₈	1085-3 ³ / ₈ G	1185-3 ³ / ₈											
	3 ⁷ / ₁₆	1085-3 ⁷ / ₁₆ G	1185-3 ⁷ / ₁₆											
85		1090-85G	1190-85	160.000	30.00	96.00	39.74	111.50	15.00	2.00	96000	71500	1900	4.99
90		1090-90G	1190-90											
	3 ⁷ / ₁₆	1090-3 ⁷ / ₁₆ G	1190-3 ⁷ / ₁₆											
	3 ¹ / ₂	1090-3 ¹ / ₂ G	1190-3 ¹ / ₂											
95		3095-95G		200.000	45.00	117.48	49.31	127.10	16.00	2.50	157000	122000	1600	9.53
100		3095-100G												
	3 ¹⁵ / ₁₆	3095-3 ¹⁵ / ₁₆ G												
	4	3095-4G												