

THIS DRAWING IS UNPUBLISHED. RELEASED FOR PUBLICATION
 © COPYRIGHT - By - ALL RIGHTS RESERVED.

| LOC | | DIST | | REVISIONS | | | |
|-----|-----|---------------------------|--|-----------|-----|------|--|
| P | LTR | DESCRIPTION | | DATE | DWN | APVD | |
| B1 | | REVISED PER ECO-11-004820 | | 11MAR11 | RK | HMR | |

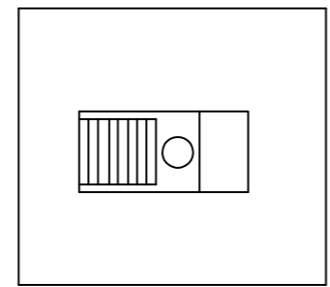
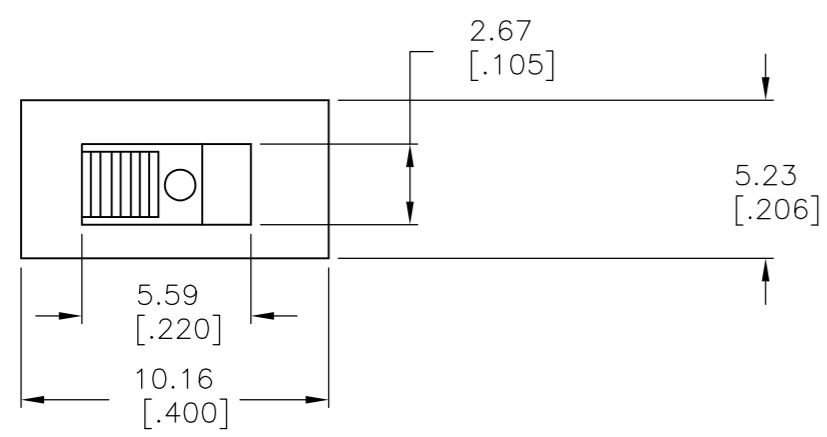

MATERIALS:
 CASE: LCP, 94V-0.
 ACTUATOR: PBT, 94V-0.
 MOVING CONTACT: COPPER, GOLD PLATE OVER NICKEL.
 FIXED CONTACT/TERMINAL: COPPER, GOLD PLATE OVER NICKEL.

ELECTRICAL:
 CONTACT RATING: 0.4 VA MAX. @ 20 VDC OR PEAK AC.
 INITIAL CONTACT RESISTANCE: 20 MILLIOHMS MAX. 100 MV & 1 MA. MIN. AT 500 VDC.
 INSULATION RESISTANCE: 1,000 M
 DIELECTRIC STRENGTH: 1000 VOLTS RMS AT SEA LEVEL.
 LIFE: 60,000 - 80,000 CYCLES.

MECHANICAL:
 ACTUATION FORCE: 150-600 GRAMS

ENVIRONMENTAL:
 OPERATING TEMPERATURE: -4°F TO + 176°F (-20°C TO +80°C)
 STORAGE TEMPERATURE: -4°F TO + 176°F (-20°C TO +80°C)
 SOLDER HEAT RESISTANCE PER EIA-364-56A, PROCEDURE 3, COND. B
 SOLDERABILITY PER EID 364-52, CLASS 2 CATEGORY 1

- 1 CENTER TERMINAL NOT FURNISHED.
- 2 ALL MATERIALS AND FINISHES SHALL COMPLY WITH EU DIRECTIVE 2002/95/EC OF 27JAN2003 (ROHS).

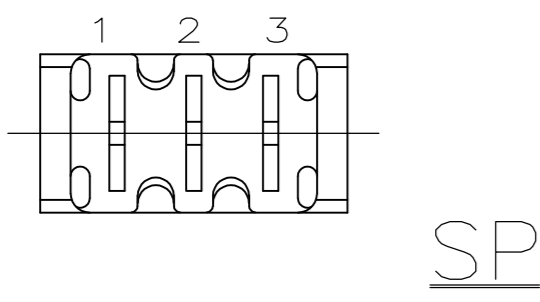
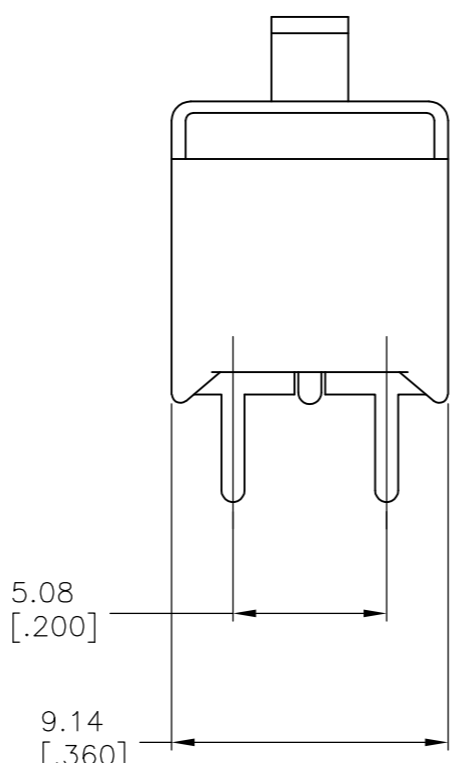
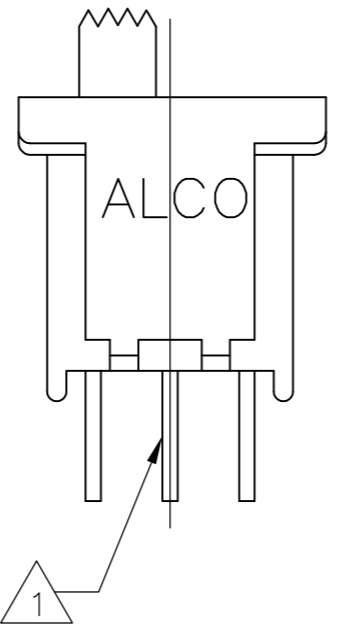
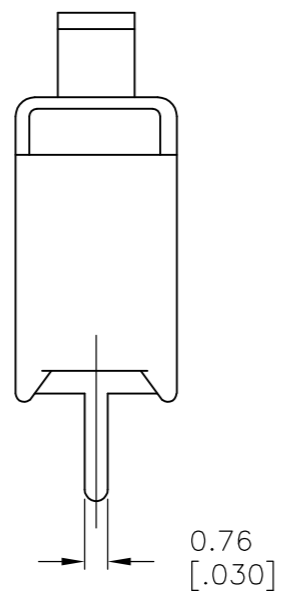
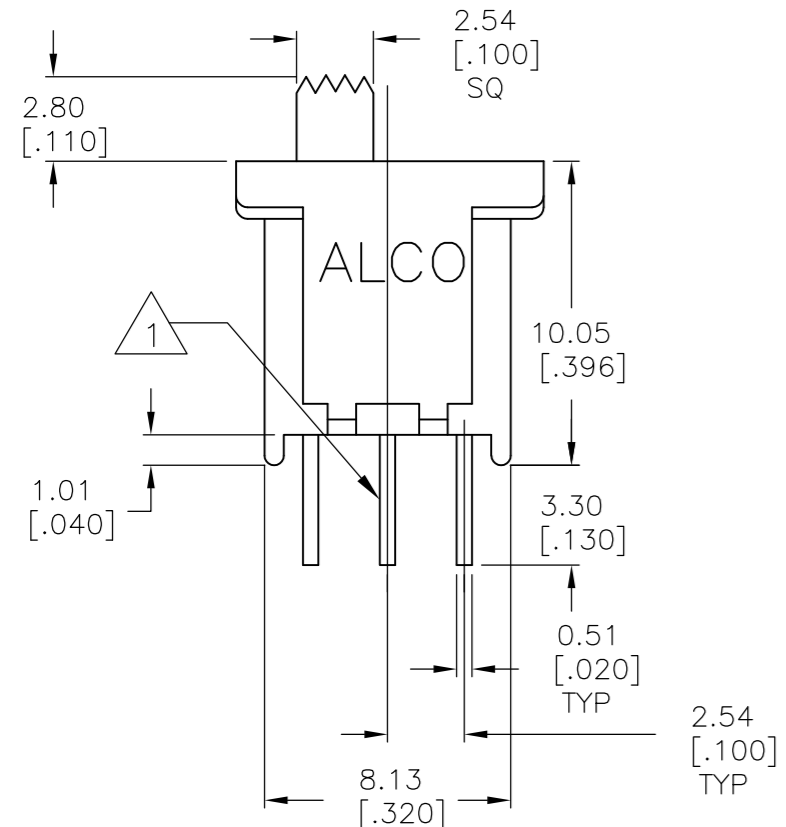

SP

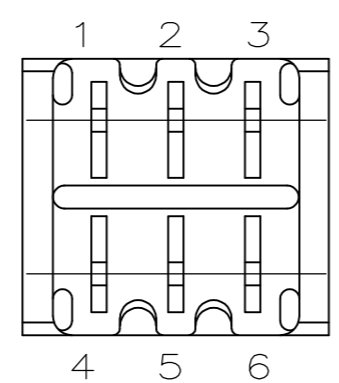

DP

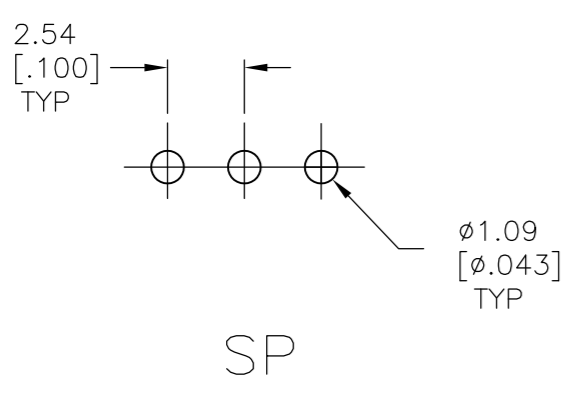

SP

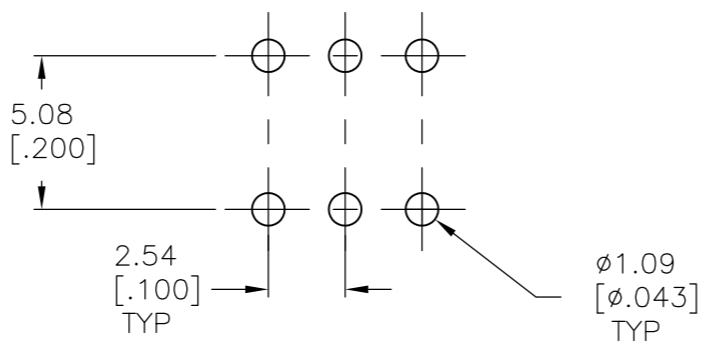

DP

RECOMMENDED HOLE LAYOUT
 LAYOUT TOLERANCES ±0.05[.002]

| P/N | Alco P/N | Actuator Flush/Extended | Position | Type | | | |
|-----------|--------------|-------------------------|----------|------|--------------|------|----------|
| 1571982-1 | TSS11DGPC04 | Extended | 2 | SPDT | 1,2 4 5 6 | None | 2,3 |
| 1571982-2 | TSS11DG1PC04 | Flush | 2 | SPDT | 1,2 | None | 2,3 |
| 1571982-3 | TSS11EG1PC04 | Flush | 3 | SPDT | 1,2 | Off | 2,3 |
| 1571982-4 | TSS11EGPC04 | Extended | 3 | SPDT | 1,2 | Off | 2,3 |
| 1571982-5 | TSS21KGPC04 | Extended | 2 | DPDT | 1-3, 4-6 | None | Off |
| 1571982-6 | TSS21NG1PC04 | Flush | 2 | DPDT | 1-2, 4-5 | None | 2-3, 5-6 |
| 1571982-7 | TSS21NGPC04 | Extended | 2 | DPDT | 1-2, 4-5 | None | 2-3, 5-6 |
| 1571982-8 | TSS21PG1PC04 | Flush | 3 | DPDT | 1-2, 4-5 | Off | 2-3, 5-6 |
| 1571982-9 | TSS21PGPC04 | Extended | 3 | DPDT | 1-2, 4-5 | Off | 2-3, 5-6 |

1

THIS DRAWING IS A CONTROLLED DOCUMENT. 28FEB2006

| | | | | |
|------------------|---|-----------|------------|---------------|
| DWN M.BINNER | TE Connectivity SLIDE SWITCH TSS11 AND TSS21 SERIES | | | |
| CHK M.SARVER | | | | |
| APVD M.SARVER | | | | |
| PRODUCT SPEC | | | | |
| APPLICATION SPEC | NAME | | | |
| WEIGHT | SIZE | CAGE CODE | DRAWING NO | RESTRICTED TO |
| CUSTOMER DRAWING | A2 | 00779 | C=1571982 | - |
| | SCALE | SHEET | REV | |
| | 1:1 | 1 OF 1 | B1 | |