

**Professionally approved products.
Datasheet**

Straight RS Female DIN 41612 Series Copper Alloy DIN Connector Contact

RS Stock 301-6935



Dimensions: (mm)

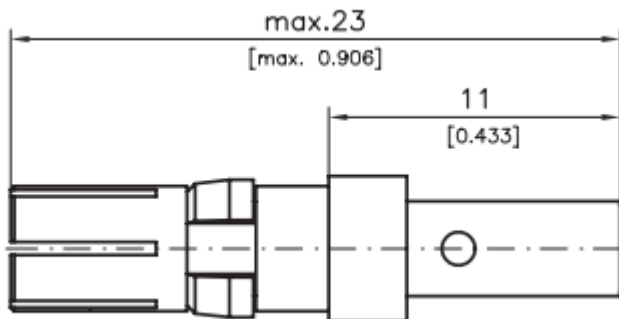

Professionally approved products.

Datasheet

Electrical Data

- Contact Resistance: max. 1mΩ
- Max. Contact Current: 25-30

Mechanical Data

- Contact forces according to DIN 41626 T1

Mating Force: max. 10N

Unmating Force: min. 1.6 N

- No of Mating Cycles

Performance class 1: >500 mating cycles

Performance class 2: >400 mating cycles

Performance class 3: > 50 mating cycles

Materials

- Contacts: CU Alloy
- Retaining Clip: CU Alloy

Thermal Data

- Operating Temperature: -55°C bis + 125°C