

**FAG****51126** [↗](#)

Axial deep groove ball bearing

Axial deep groove ball bearing 511, single direction, steel sheet metal cage

## Technical information

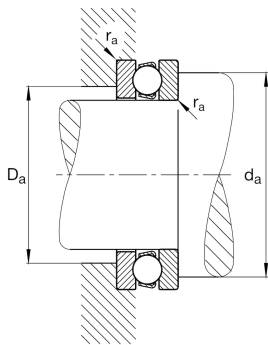
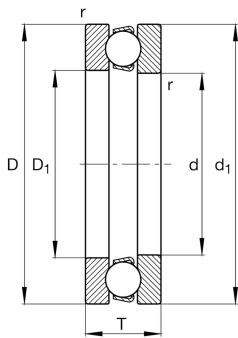

## Your current product variant

Cage	JP	Steel sheet metal
Tolerance class	PN	Normal (PN)

## Main Dimensions &amp; Performance Data

d	130 mm	Inner diameter shaft washer
D	170 mm	Outer diameter housing washer
T	30 mm	Height
C <sub>a</sub>	111,000 N	Basic dynamic load rating, axial
C <sub>0a</sub>	390,000 N	Basic static load rating, axial
C <sub>ua</sub>	14,600 N	Fatigue load limit, axial
n <sub>G</sub>	2,850 1/min	Limiting speed
n <sub>gr</sub>	2,490 1/min	Reference speed
≈m	1.757 kg	Weight

## Mounting dimensions

d <sub>a min</sub>	154 mm	Minimum diameter shaft shoulder
D <sub>a max</sub>	146 mm	Maximum diameter of housing shoulder
r <sub>a max</sub>	1 mm	Maximum filled radius



Dimensions

r <sub>min</sub>	1 mm	Minimum chamfer dimension
D <sub>1</sub>	132 mm	Inner diameter housing washer
d <sub>1</sub>	170 mm	Outer diameter shaft washer





Temperature range

T <sub>min</sub>	-30 °C	Operating temperature min.
T <sub>max</sub>	150 °C	Operating temperature max.

Calculation factors

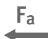
A	0.76	Minimum load factor
---	------	---------------------

Characteristics

	Axial load in one direction
	Grease Lubrication
	Oil Lubrication
	Not sealed