

**FAG****626-2RSR-HLN-C3**

Deep groove ball bearing

Deep groove ball bearing 62...-2RSR, single row, seals, steel sheet metal cage

## Technical information

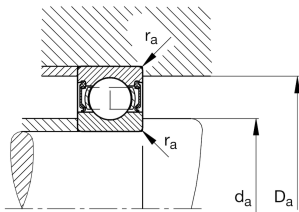
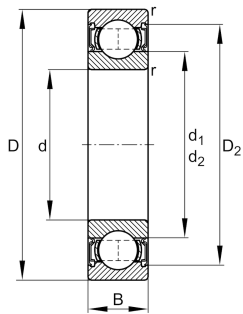

## Your current product variant

Logistical code	HLN	-
Sealing	2RSR	Contact seal on both sides
Cage	J	Steel sheet metal
Tolerance class	PN	Normal (PN)
Dimensional / heat stabilization	SN	Rings dimensional stabilized up to 120°
Lubricant	Lubricating grease	
Radial internal clearance	C3 (Group 3)	Internal clearance larger than CN
Bore type	Z	Cylindrical

## Main Dimensions &amp; Performance Data

d	6 mm	Bore diameter
D	19 mm	Outside diameter
B	6 mm	Width
C <sub>r</sub>	2,610 N	Basic dynamic load rating, radial
C <sub>0r</sub>	1,050 N	Basic static load rating, radial
≈m	0.008 kg	Weight

## Mounting dimensions

d <sub>a min</sub>	8.4 mm	Minimum diameter shaft shoulder
D <sub>a max</sub>	16.6 mm	Maximum diameter of housing shoulder
r <sub>a max</sub>	0.3 mm	Maximum fillet radius



Dimensions

r <sub>min</sub>	0.3 mm	Minimum chamfer dimension
D <sub>1</sub>	15.5 mm	Shoulder diameter outer ring
D <sub>2</sub>	16.7 mm	Caliber diameter outer ring
d <sub>1</sub>	10.4 mm	Shoulder diameter inner ring
d <sub>2</sub>	9 mm	Caliber diameter inner ring





Temperature range

T <sub>min</sub>	-30 °C	Operating temperature min.
T <sub>max</sub>	100 °C	Operating temperature max.

Calculation factors

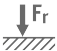
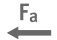
f <sub>0</sub>	12.4	Calculation factor
----------------	------	--------------------

Characteristics

-  Radial load
-  Axial load in one direction
-  Axial load in two directions
-  Lifetime lubrication, freedom from maintenance
-  Grease Lubrication
-  Sealed on both sides