

Datasheet

RS Pro 0.25L Spray Gun with 1 mm Tip

RS Stock No: **297-9936**



Product Details

RS Pro spray gun features 1 mm tip and 0.25 L nylon container. It is suitable for detail spraying to small refinishing repair work. The gun comes complete with a stainless steel fluid nozzle. The needle makes it suitable for both water and solvent based paints.

Features and Benefits

- 0.25 L nylon container
- 60cc paint jar with swivel adapter
- 1.0 mm stainless steel nozzle
- Air consumption is 5 to 7 CFM



ENGLISH

Specifications:

Air Inlet (BSP)	1/4 in
Container Capacity	0.25 L
Tip Size	1 mm

OPERATION:

A. Starting :

- Use spanner to tight the nozzle.
- Check for correct tightening of stuffing box to avoid any air leakage.
- Air hose should be blow out before fitting with the air connection.
- Before using this gun, Please make sure that it is carefully flushed w/solvent.

D. Exchange of Nozzle Set

Make sure that the complete nozzle set is exchanged when changing to another nozzle.
A set comprises of air cap, paint nozzle and paint needle.

E. Tensioning of Packing Screw on Needle Seal

The needle seal is effected by a teflon seal and a needle packing with self-tensioning compression spring.

To Change the packing during general overhaul, please use the socket spanner.

F. Cleaning and Gun Care

- Flush gun thoroughly with solvent.
- Clean air nozzle with brush. Never place the whole gun to solvent.
- Clogged holes should never be cleaned with hard objects as the smallest amount of damage may badly influence the spray pattern.
- Packing must be slightly lubricated after cleaning of gun.

****WARNING : NEVER AIM SPRAY GUNS AT PEOPLE, SOLVENTS AND THINNERS CAN CAUSE INJURY**

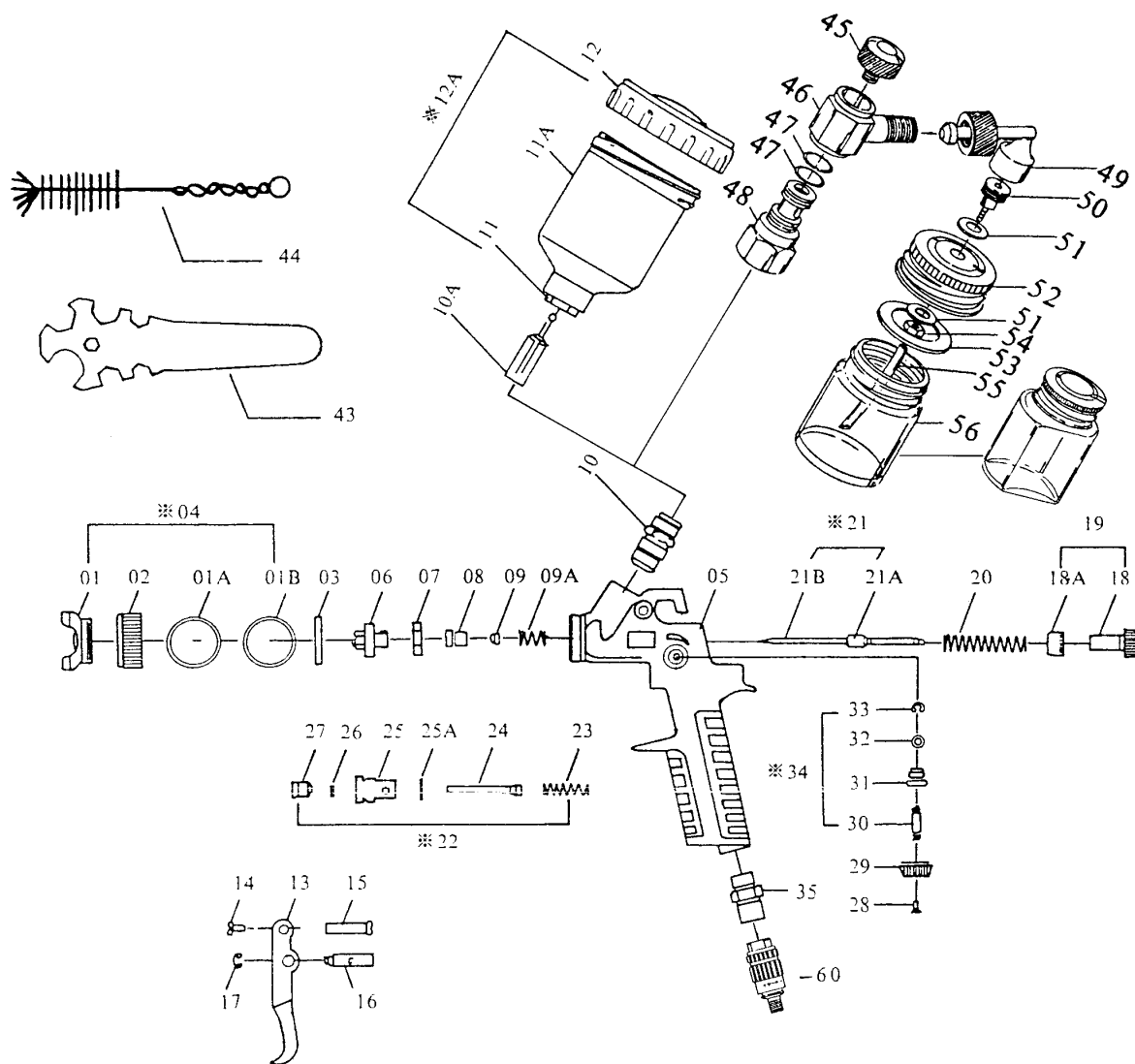

Item No.	Description
01	Air Nozzle
01A	Brass Washer
01B	Washer
02	Brass Cap
03	O-Ring
※04	Air Nozzle Cap. Set
05	Gun Body
06	Fluid Nozzle
07	Gaske
08	Packing Screw
09	Teflon Seal
09A	Spring
10	Connector
10A	Material Sleeve
11	Plastic Cup
11A	Connector
12	Cover Of 0.25 l Plastic Cup
※12A	Plastic Cup And Cover Set
13	Trigger
14	Trigger Screw
15	Trigger Screw
16	Trigger Pin
17	E-Ring
18	Fluid Control Knob
18A	Lock Nut For Fluid Control Knob
20	Spring For Paint Needle
※21	Needle Valve Ass'y
21A	Paint Needle
21B	Paint Needle
※22	Air Valve Ass'y
23	Spring
24	Valve
25	Bvoly
25A	P.C. Seal
26	Foamed Rubber
27	Screw
28	Screw
29	Control Knob
30	Spray Regulating Screw
31	Spray Regulating Nut
32	Washer
33	E-Ring
※34	Fan cntrol - for round and flat spray
35	Air Connection Piece ¼" Bsp

Item No.	Description
43	Spanner
44	Brush
45	Fix-Screw
46	Adaptor
47	O-Ring
48	Adaptor
49	360 Swivel Adaptor
50	Screw
51	Washer
52	Cover
53	Gaske
54	Nut
55	Tube
56	22cc Jar
57	60cc Jar
60	Air Regulator

H828W-C

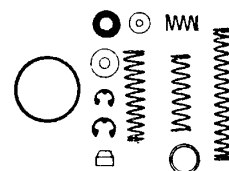
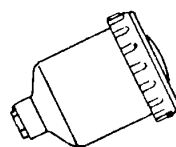

H828W-R

Repair Kit For Spray Gun
Parts No:03 09 09A 17 20 23 25A 26 32
33 38 40

H828W-BC (45-56)

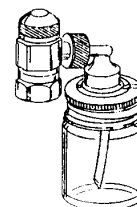

Have To Order Cmplete Set If Special Mark "※" !