

# Datenblatt

## TORX-Steckschlüsselbits mit 1/4-Zoll-Antrieb, RS Pro

DE



### Produktmerkmale:

- Ausführung mit festem Ende
- Bit aus Chrom-Vanadium-Molybdän-Stahl
- Steckschlüssel aus Chrom-Vanadium-Stahl
- Spiegelverchromung

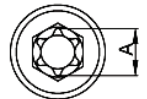
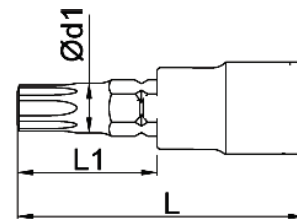
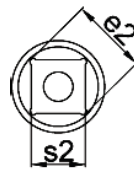

RS-CODE-NR.		a ref. mm	L mm	L1 mm	gr
1923778	T10	2,72	37	18	14
1923779	T15	3,26	37	18	14
1923781	T20	3,84	37	18	14
1923782	T25	4,40	37	18	14
1923783	T27	4,96	37	18	14
1923784	T30	5,49	37	18	14
1923785	T40	6,60	37	18	14