

# 7308 BECBJ

Popular item  
SKF Explorer

## Dimensions

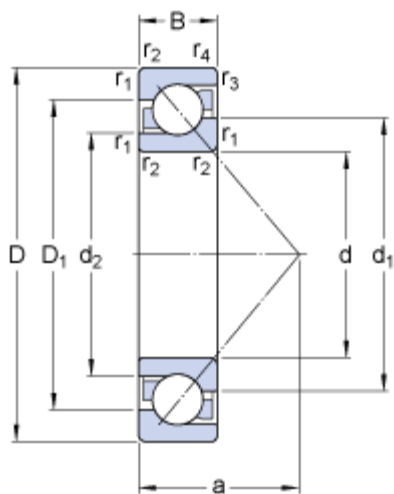

d	40	mm
D	90	mm
B	23	mm
d <sub>1</sub>	≈ 59.5	mm
d <sub>2</sub>	≈ 49.5	mm
D <sub>1</sub>	≈ 71.6	mm
a	39	mm
r <sub>1,2</sub>	min. 1.5	mm
r <sub>3,4</sub>	min. 1	mm

## Abutment dimensions

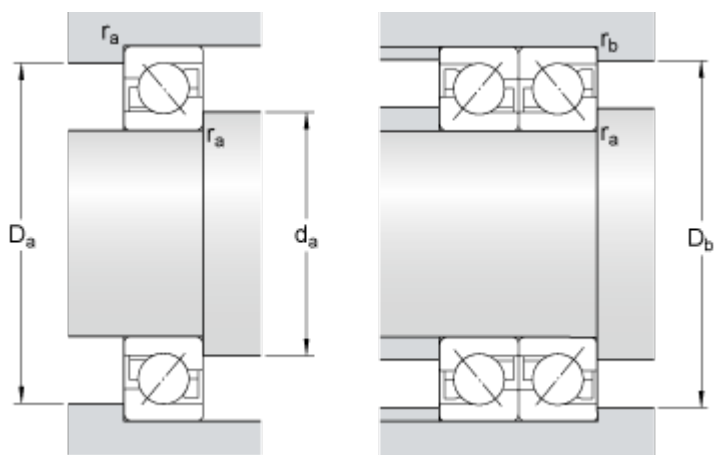

d <sub>a</sub>	min. 49	mm
D <sub>a</sub>	max. 81	mm
D <sub>b</sub>	max. 84.4	mm
r <sub>a</sub>	max. 1.5	mm
r <sub>b</sub>	max. 1	mm

## Calculation data

Basic dynamic load rating	C	50	kN
Basic static load rating	C <sub>0</sub>	32.5	kN
Fatigue load limit	P <sub>u</sub>	1.37	kN
Reference speed		9500	r/min
Limiting speed		10000	r/min
Calculation factor	A	0.0173	
Calculation factor	k <sub>r</sub>	0.1	
Calculation factor	e	1.14	

## Single bearing or bearing pair arranged in tandem

Calculation factor	X	0.35	
--------------------	---	------	--

Calculation factor	$Y_0$	0.26
Calculation factor	$Y_2$	0.57
<b>Bearing pair arranged back-to-back or face-to-face</b>		
Calculation factor	X	0.57
Calculation factor	$Y_0$	0.52
Calculation factor	$Y_1$	0.55
Calculation factor	$Y_2$	0.93

## Mass

---

Mass bearing	0.64	kg
--------------	------	----

---