

Description

CONDUCTIVE CASTOR WITH TOP PLATE, GREY RUBBER 125MM

Fixed

DF3BA125-272L



Part Number

Swivel

DP3BA125-272L



Swivel and brake

DP3BD125-272L



	Fixed	Swivel	Swivel+brake
Wheel Diameter ØD	125 mm		
Overall Height H	159 mm ±1		
Size of plate A X B	76 x 70 mm±1		
Plate hole centres a x b	60 x 50 mm±0,3		
Plate hole	8,3 mm		
Offset F ±1	\	35 mm	35 mm
Width of Tread	29 m±0,5		
Hardness of tread	shore A ± 93		
Load capacity	80 Kg		
Weight	0,47 kg	0,56 kg	0,6 kg
Temperature	- 5 / + 50 °C		

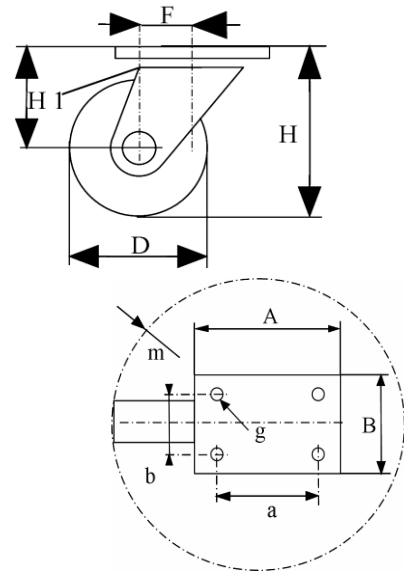

Castor Assembly :

Zinc-plated steel. Swivel on two rows of balls.
Fastening by top plate.
Total lock. Plastic pedal.

Wheel :

Light grey polypropylene Wheel centre made from electroconductive materials.
Tread : Dark grey Thermoplastic tyre made from electroconductive materials.
Plain bearing.

Features :

Low starting effort,
Bonded Rubber,
Protects sensitive goods and users from electric shocks (electrostatic discharges).
Conductive casters compliant with ISO 22877.
Electrical resistance < 100000 ohms.
For use on trolleys or sensitive devices in laboratories, medical units, hospitals, electrical and electronic factories, explosion hazard areas....