



Switches > Switch Knobs



Primary Product Material: Aluminum 5056

Knob Design: Straight Knurl

Shaft Size: 6.35 mm [.25 in]

Product Diameter: 44.7 mm [1.76 in]

Primary Product Color: Black

Features

Configuration Features

Spinner Type	Crank
Spinner	With
Skirt	Without
Spin Plate	Without
Knob Design	Straight Knurl

Body Features

Primary Product Material	Aluminum 5056
Primary Product Color	Black

Dimensions

Shaft Size	6.35 mm[.25 in]
Product Diameter	44.7 mm[1.76 in]

Identification Marking

Indicator Style	Crank
Indicator Location	Top



Product Compliance

For compliance documentation, visit the product page on TE.com>

EU RoHS Directive 2011/65/EU	Not Compliant
EU ELV Directive 2000/53/EC	Not Compliant
China RoHS 2 Directive MIIT Order No 32, 2016	Restricted Materials Above Threshold
EU REACH Regulation (EC) No. 1907/2006	Current ECHA Candidate List: JAN 2025 (247) Candidate List Declared Against: JUNE 2024 (241) SVHC > Threshold: Pb (.6% in Component Part) Article Safe Usage Statements: Do not eat, drink or smoke when using this product. Wash thoroughly after handling. Recycle if possible and dispose of the article by following all applicable governmental regulations relevant to your geographic location.
Halogen Content	Low Halogen - Br, Cl, F, I < 900 ppm per homogenous material. Also BFR/CFR/PVC Free
Solder Process Capability	Not applicable for solder process capability

Product Compliance Disclaimer

This information is provided based on reasonable inquiry of our suppliers and represents our current actual knowledge based on the information they provided. This information is subject to change. The part numbers that TE has identified as EU RoHS compliant have a maximum concentration of 0.1% by weight in homogenous materials for lead, hexavalent chromium, mercury, PBB, PBDE, DBP, BBP, DEHP, DIBP, and 0.01% for cadmium, or qualify for an exemption to these limits as defined in the Annexes of Directive 2011/65/EU (RoHS2). Finished electrical and electronic equipment products will be CE marked as required by Directive 2011/65/EU. Components may not be CE marked. Additionally, the part numbers that TE has identified as EU ELV compliant have a maximum concentration of 0.1% by weight in homogenous materials for lead, hexavalent chromium, and mercury, and 0.01% for cadmium, or qualify for an exemption to these limits as defined in the Annexes of Directive 2000/53/EC (ELV). Regarding the REACH Regulation, the information TE provides on SVHC in articles for this part number is based on the latest European Chemicals Agency (ECHA) ‘Guidance on requirements for substances in articles’ posted at this URL: <https://echa.europa.eu/guidance-documents/guidance-on-reach>

Compatible Parts



TE Part # 4-1437622-6
KN500B1/4=KNOB BLACK KNURL 1/4



TE Part # 1571193-1
KN500B1/4NL=KNOB,W/O INDICATOR

Customers Also Bought

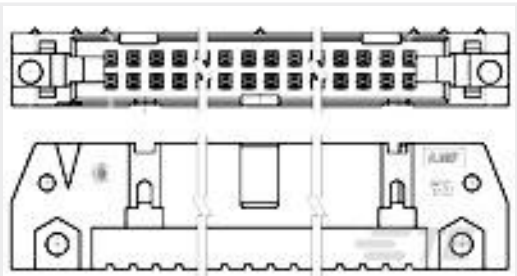

TE Part #102142-1
UNV AMP-LATCH HDR HSG 20P W /MTG EARS



TE Part #5569026-1
MJ,LPF,R/A,6P,HTN



TE Part #1676979-4
TW 1W 10K 6.35X25PL

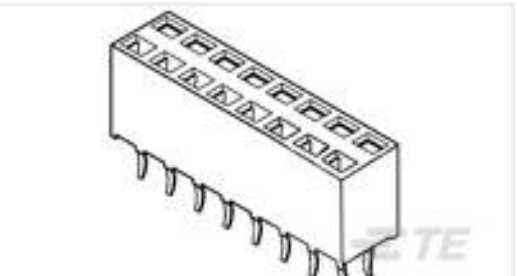

TE Part #1-215307-0
2X10P HV100 REC CON. TE, 7.0MM

Documents

CAD Files

3D PDF

3D

Customer View Model

ENG_CVM_CVM_4-1437622-1_99_c-4-1437622-1-99.2d_dxf.zip

English

Customer View Model

ENG_CVM_CVM_4-1437622-1_99_c-4-1437622-1-99.3d_igs.zip

English

Customer View Model

ENG_CVM_CVM_4-1437622-1_99_c-4-1437622-1-99.3d_stp.zip

English

By downloading the CAD file I accept and agree to the [Terms and Conditions](#) of use.

Datasheets & Catalog Pages

Alcoswitch Products

English