

Features

- Maximum operating pressure is 35 bar.
- Operating temperature range 20°C to +100°C.
- Material: Brass / Steel with Nickel Plated Finish
- Single Shut Off (One side is with valve)
- Flow 870 l/min
- British Profile DN5
- Compatible with:
SCHRADER 1/4"
PARKER - RECTUS 17

RS PRO Pneumatic Quick Connect Coupling

RS Stock No.: 0325398



RS PRO is the own brand of RS. The RS PRO Seal of Approval is your assurance of professional quality, a guarantee that every part is rigorously tested, inspected, and audited against demanding standards. Making RS PRO the Smart Choice for our customers.

Product Description

RS PRO Series 17 Quick Connect Couplings

Pneumatic quick-connect coupling connectors are found across industry in pneumatic systems as diverse as robotic assembly lines and other equipment.

- Maximum operating pressure is 35 bar.
- Operating temperature range 20°C to +100°C.
- Material: Brass / Steel with Nickel Plated Finish
- Single Shut Off (One side is with valve)
- Flow 870 l/min
- British Profile DN5
- Compatible with:
SCHRADER 1/4"
PARKER - RECTUS 17

Specifications

Manufacturer Series	017
Coupling Type	Quick Connect Coupling Plug
Connection Standard	DN5 British Profile
Connection Standard Compatible With	SCHRADER 1/4"; PARKER-RECTUS 17
Minimum Operating Temperature	-20°C
Maximum Operating Temperature	+100°C
Maximum Operating Pressure	35bar
Flow	870 l/min
Flow Direction & Sealing	Thru-type coupling
Material	Steel
Finish	Nickel Plated
Connection Type	Threaded
Thread Size	3/8 in
Thread Standard	G
Thread Gender	Female
Coupling Gender	Female
Threaded Connection	G 3/8 Female
Seal material	N/A

Specifications

Plug Profile Serie 017

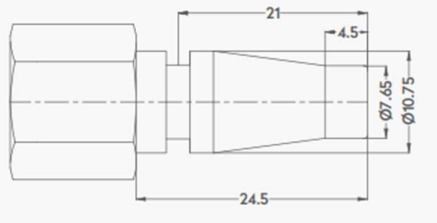

Dimensions (mm)

SW	L	ØD
19	41	-

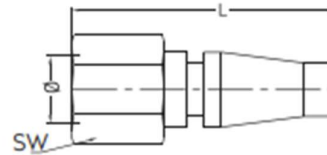

Materials

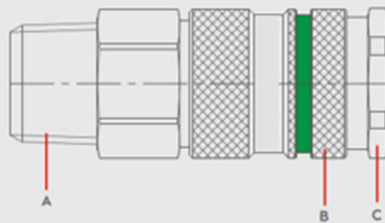

Material Code

- A = Brass Nickel Plated
- B = Steel Nickel Plated
- C = Steel Nickel Plated
- S = Steel Nickel Plated

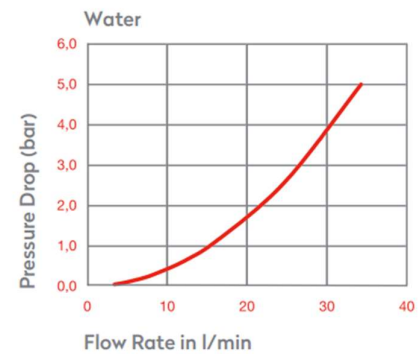
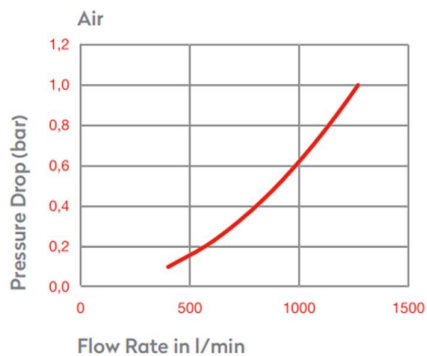

Series 17 Quick Connect Couplings



0 - 35 bar
(0-508 PSI)



-20° to +100°C (NBR)
-4° to +212°F

Shut Off
Type

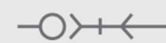

OM 300 - 00700
OM 250 - 00500
OM 100 - 01000

FLOW

870 lt/min

DN

5 mm