

REVISIONS			
REV.	DESCRIPTION	DATE	INIT
0	INITIAL RELEASE		
1			

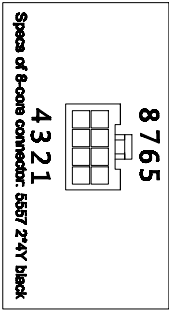
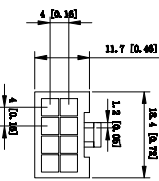
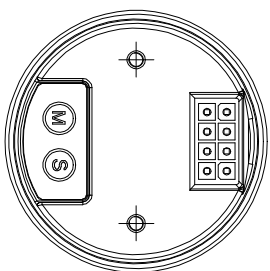
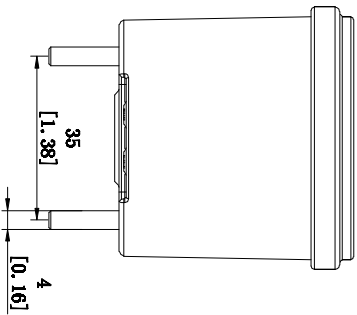
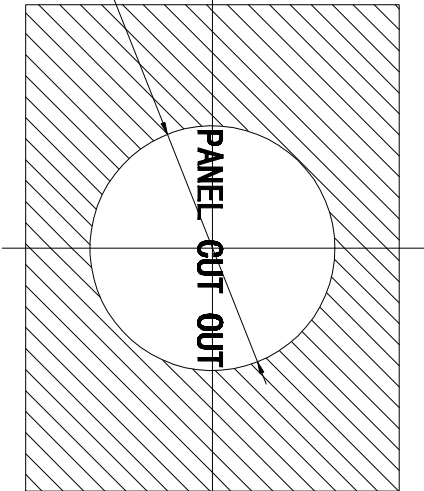
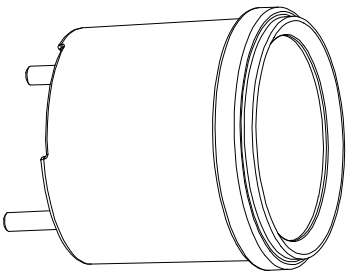
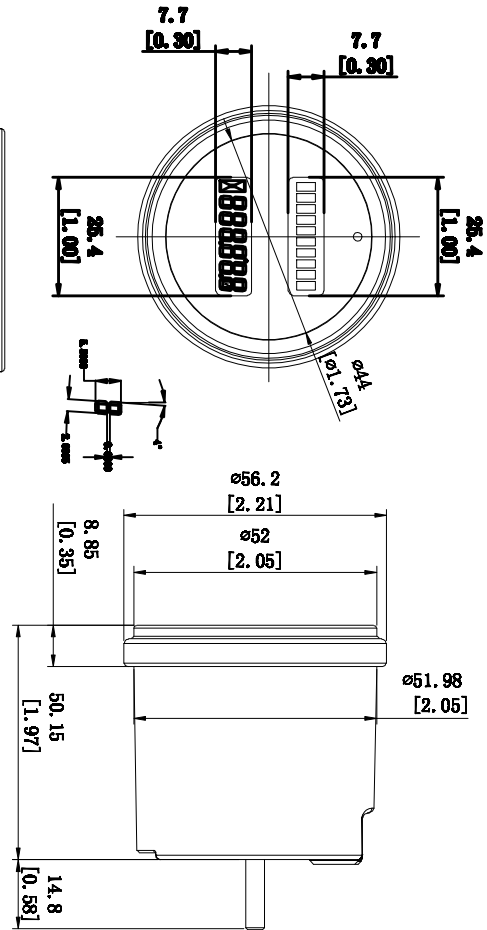

1	Timing control terminal. Connect to battery negative pole.
2	Key switch. Connected to battery positive pole.
3/4	Relay output terminal.
5	Power input negative terminal. Connect to battery negative pole.
6	Timing control terminal. Connect to battery positive pole.
7	Positive pole of battery input(12V or 36V)connected to battery positive pole.
8	Positive pole of battery input(24V or 48V)connected to battery positive pole.

No	Item	Parameter
1	Housing Material	ABS+Aluminum
2	Operating Voltage	DC 8-60V
3	Working temperature	-20℃ TO 65℃
4	Product Weight	108g
5	Display window size(visible)	25.5*7.4mm
6	Product Size	Φ56.2*64.8mm
7	Waterproof Level	IP65

- Function Description:**
- 1.Battery indicator:**
- A.When the key switch is connected,it will recognize the current voltage range of 12V/24V/36V/48V and display the remaining battery capacity automatically.
- B.Delay function: Decline one LED by one LED per 155S when discharging,Rise one LED by one LED per 200s when charging.
- C.Battery capacity display mode: LED
- D.Discharge curve: 18 groups of battery curves can be selected; 1 group of user-defined discharge curve.
- 2.Voltneter function: real-time measure the current voltage, display mode:xx.xV.
- 3.Hour meter function:
- A.Timing method: Two methods,connected to positive pole or negative pole of the battery to timing.
- B.Timing range: 0-999999H.The resolution is 0.1H when 0.0-99999.9H;The resolution is 1H when 100000-999999H.
- C.Timing type: Partial timing and total timing; Partial timing is resettable, total timing is not resettable;
- 4.Display Mode:The working parameter and information are displayed by 6 digits LCD screen. The remaining battery capacity is displayed by 10 LED bars.
- 5.Data storage: Inner EEPROM, can store the data(like working hours,etc) around 20years;
- 6.Relay output function:
- A.Battery capacity > 10%, relay will be NC.
- B.Battery capacity ≤ 10%, relay will be NO.

UNLESS OTHERWISE SPECIFIED DIMENSIONS ARE IN INCHES TOLERANCES ARE: .X± .XX± .XXX± X²±		DRAWN		DATE		TITLE <b>Battery Indicator</b>	
		CHECKED		DATE			
		APPROVED		DATE			
		MATERIAL	N/A				
COMPUTER GENERATED DRAWING-NO MANUAL CHANGES ALLOWED		FINISH	N/A	PROJECTED VIEWS ARE 3RD ANGLE		SIZE <b>B</b>	PART NO. <b>RL-B1011</b>
DO NOT SCALE DRAWING		STATUS	DS4_DESIGN	SCALE	NTS	SHEET 1 OF 1	PROJECT NO. <b>008</b>
							REVISION <b>0</b>